



2012 Unilock Product Guide



Creation Begins With The Elements.™



HARMONY
OUTDOOR LIVING INC.

UNILOCK®

Elements

“Elements are pre-built modular units that are manufactured with Unilock product by Harmony Outdoor Living, Inc. They are designed to flow seamlessly with the surrounding hardscape. Each module comes with fork slots that allow them to be installed with skid steers, forklifts, or even cranes.

Please note the following when placing an order:

- *Please list the product ID/SKU*
- *Choose a standard color scheme (or contact us for a 3D image of a custom color combination)*
- *“Custom colors & accents” are available - call for information*
- *Make sure to check the weights and plan to have the appropriate machine available*
- *List any additional features/ upgrades, for example : lighting, accent changes, accessories, etc.*





The Tuscany Collection



Tuscany Fireplace

Product ID—TUFRPW11 (36" wood)

*Product ID—TUFRPBOG11
(gas burning, without chimney)

*Product ID—TUFRPBG11
(gas burning, with chimney/top)

*Product ID—TUFRPBOL11
(LP burning, without chimney/top)

*Product ID—TUFRPBL11
(LP burning, with chimney/top)



Approximate weight :
Bottom unit—3995 lbs.
Top unit —2815 lbs.

Rough dimensions :
36" D x 60" W x 117" H

* Please note gas & LP are special order units and may have an increased lead time. Contact your rep for info.

Tuscany Wood Box Set



Approximate weight :
per box - 1893 lbs.

Rough dimensions :
28" D x 40" W x 38.75" H

Product ID—TUWDBX11

Tuscany Water Feature Set (12")



Approximate weight :
per water feature - 1850 lbs.

Rough dimensions :
48" D x 24" W x 42.75" H

Product ID—TUWFPR11

Tuscany Arched Hearth



Approximate weight :
1070 lbs.

Rough dimensions :
24" D x 60" W x 11" H

Product ID—TUHTAC11

Tuscany Grill Island



* Includes : AOG 36" Grill & AOG 30" Doors

Approximate weight: Rough dimensions :
Call for details. 6" D x 75.13" W x 42.75" H

Product ID—TUGRISL11

Tuscany 24" Water Feature

* Please note this is a special order item and may have an increased lead time. Contact your rep for info.



Approximate weight : Rough dimensions :
3355 lbs. 44" D x 51.75" W x 50.5" H

Product ID—TUWATFT11

Tuscany Brick Oven



Approximate weight :
Bottom unit—3302 lbs.
Top unit—3836 lbs.

Rough dimensions :
48" D x 48" W x 100" H

Product ID—TUBRO11



The Barcelona Collection



Barcelona Fireplace



Product ID—BRFRPW11 (36" wood)
 Product ID—BRFRPBOG11
 (gas burning, without chimney)
 Product ID—BRFRPBG11
 (gas burning, with chimney/top)
 Product ID—BRFRPBOL11
 (LP burning, without chimney/top)
 Product ID—BRFRPBL11
 (LP burning, with chimney/top)

Approximate weight :
 Bottom unit—4052 lbs.
 Top unit —2605 lbs.

Rough dimensions :
 36" D x 60" W x 117" H

* Please note gas & LP are special order units and may have an increased lead time. Contact your rep for info.

Barcelona Wood Box Set



Approximate weight :
 per box - 1975 lbs.

Rough dimensions :
 28" D x 40" W x 38.75" H

Product ID—BRWDBX11

Barcelona Water Feature Set (12")

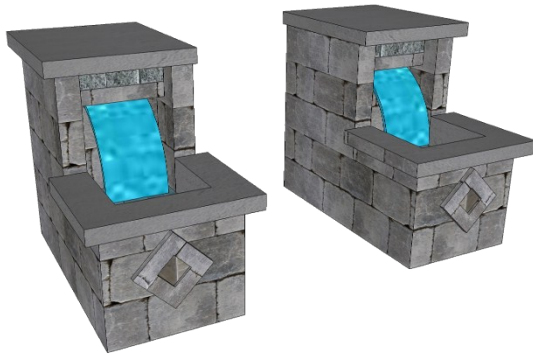

Approximate weight :
 Call for details.

Rough dimensions :
 48" D x 24" W x 42.75" H

Product ID—BRWFPR11

Barcelona Arched Hearth

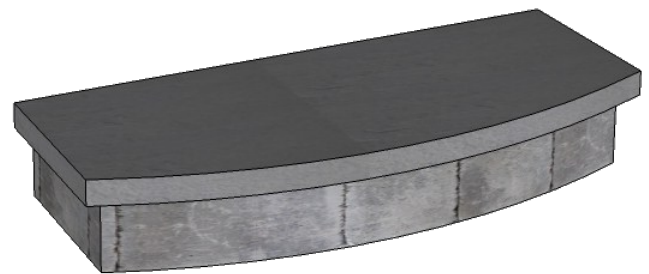

Approximate weight :
 1100 lbs.

Rough dimensions :
 24" D x 60" W x 11" H

Product ID—BRHTAC11

Barcelona Grill Island



* Includes : AOG 36" Grill & AOG 30" Doors

Approximate weight: Rough dimensions :
 Call for details. 36" D x 75.13" W x 42.75" H

Product ID—BRGRISL11

Barcelona 24" Water Feature

* Please note this is a special order item and may have an increased lead time. Contact your rep for info.



Approximate weight : Rough dimensions :
 2886 lbs. 44" D x 51.75" W x 58.5" H

Product ID—BRWATFT11

Barcelona Brick Oven



Approximate weight :
 Bottom unit—3212 lbs.
 Top unit—3795 lbs.

Rough dimensions :
 48" D x 48" W x 100" H

Product ID—BRBRO11



The Concorde Series



“The Concorde Fireplace series offers an attractive alternative to site built kits. Their lower price point opens them up to a wide market of consumers. Note the built in standard hearth.”

Concorde Fireplace - Wood -

Approximate weight :
Call for details.

Rough dimensions :
40” D x 52” W x 101” H



Product ID—CNFRPW11 (wood)

*Product ID—CNFRPBOG11
(gas burning, without chimney)

*Product ID—CNFRPBG11
(gas burning, with chimney/top)

*Product ID—CNFRPBOL11
(LP burning, without chimney/top)

*Product ID—CNFRPBL11
(LP burning, with chimney/top)

* Please note gas & LP are special order units and may have an increased lead time.
Contact your rep for info.

Concorde Wood Boxes



Approximate weight : Call for details.

Rough dimensions : 28” D x 36” W x 35” H

Product ID—CNWDBX11



The Bordeaux Series



“The Bordeaux Collection is a beautiful combination of Bravado Wall with accents of Creta Stone. It’s French Country design, features a built in hearth and clean elegant lines; making it an excellent complement to almost any landscape design. “

Bordeaux Fireplace & Wood Box Set (Fireplace & Wood Box Set sold separately)

Product ID—BDFRPW12 (wood)
*Product ID—BDFRPBOG12 (gas burning, without chimney)
*Product ID—BDFRPBG12 (gas burning, with chimney/top)
*Product ID—BDFRPBOL12 (LP burning, without chimney/
*Product ID—BDFRPBL12 (LP burning, with chimney/top)

* Please note gas & LP are special order units and may have an increased lead time. Contact your rep for info.

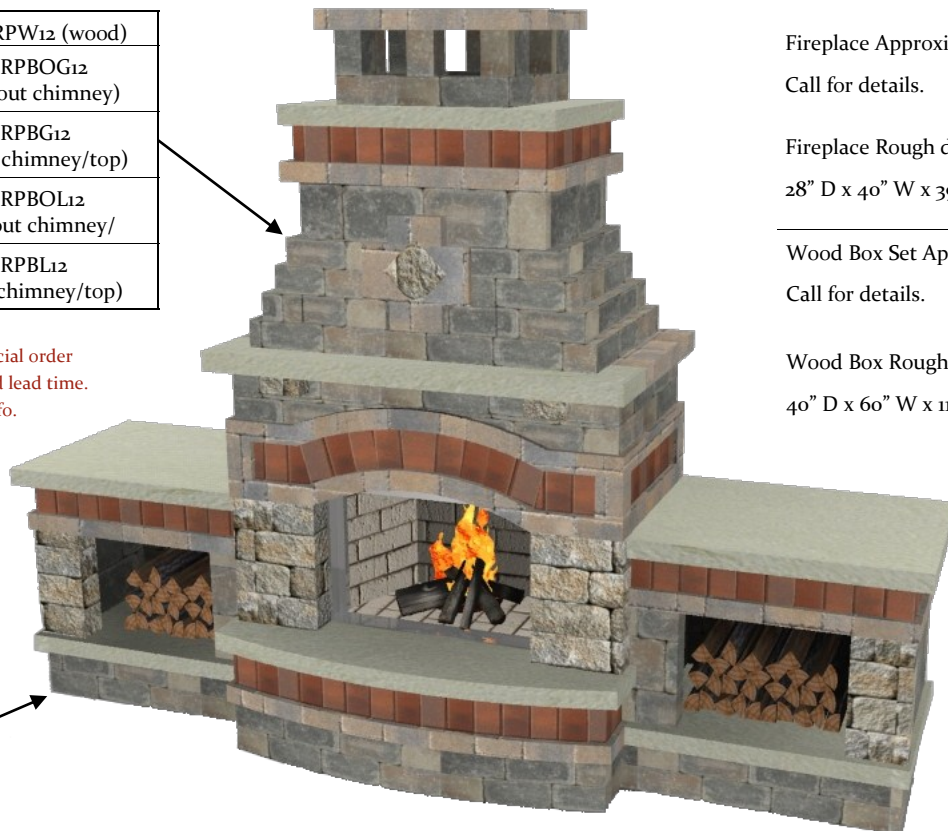

Product ID—BRWDBX11

Fireplace Approximate weight :
Call for details.

Fireplace Rough dimensions :
28" D x 40" W x 39" H

Wood Box Set Approximate weight :
Call for details.

Wood Box Rough dimensions :
40" D x 60" W x 112" H

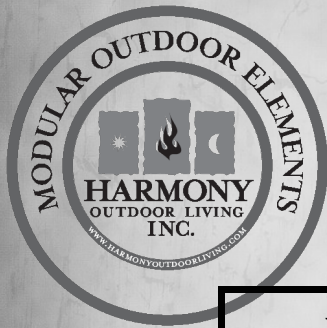

Low Voltage Lighting Upgrades

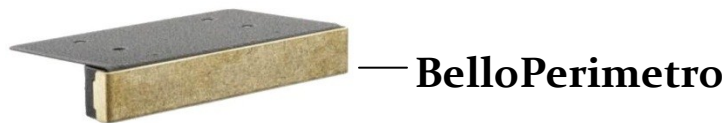
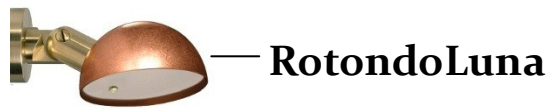

“Low Voltage Lighting fixtures from FX are available as upgrades. The fixtures come in standard as Bronze, please contact us directly for additional colors. We offer the following models : BelloPerimetro (lip light) and RotondoLuna (for brick ovens). Below are lighting diagrams of possible lighting locations. Be sure to specify which model, color, and location you prefer. Note, each light comes with enough wire to protrude from the back of the Element. They DO NOT include any connectors or transformers.”

Fireplace Units

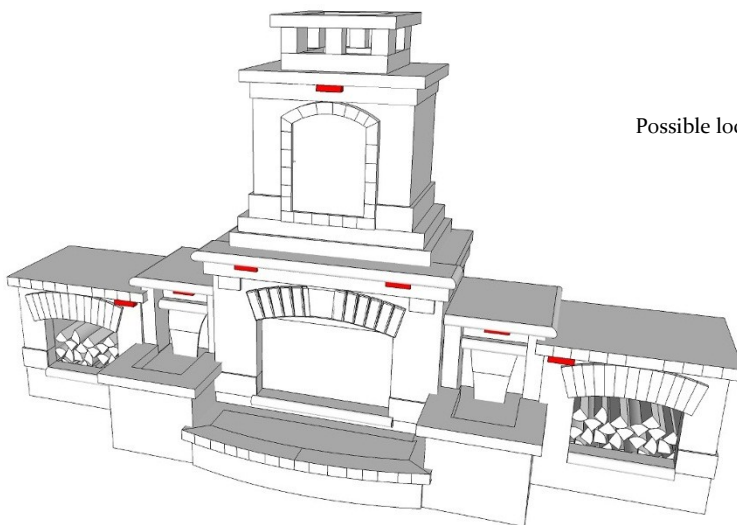

Possible locations shown :

7

Brick Oven

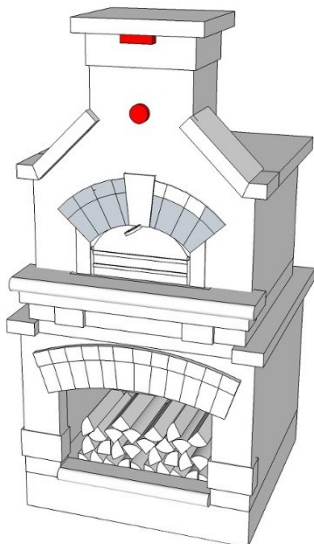

Possible locations shown :

2

Grill Island

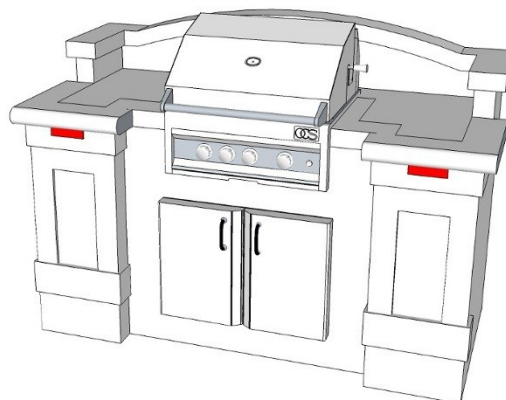

Possible locations shown :

2

NOTE : Must specify location & number of lights when ordering.

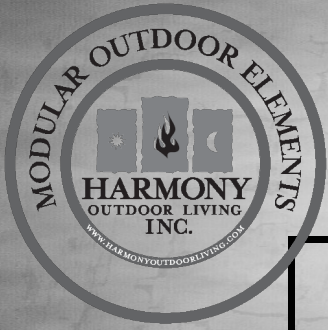

Installation Instructions



Installation

“Elements are very easy to install. Here are a couple cross section details to consider. Keep in mind, these ARE NOT engineered plans. Make sure you check with your local municipality for their requirements when installing Elements. Here are a few other key points to remember:

- *Always place a piece of material (plywood or carpet work well) between your forks and the Element to prevent chipping*
- *Always transport the Element on the pallet it comes with until you are ready to place on the permanent location*
- *Make sure to use a ratchet strap to secure the Element to the loader when placing*
- *Handle Elements with care – they are concrete but not indestructible*
- *Make sure to size the machine to the Elements weight*
- *All Elements are designed to be buried 4” below finish grade (note – bars need to be buried 8” below finish grade)*

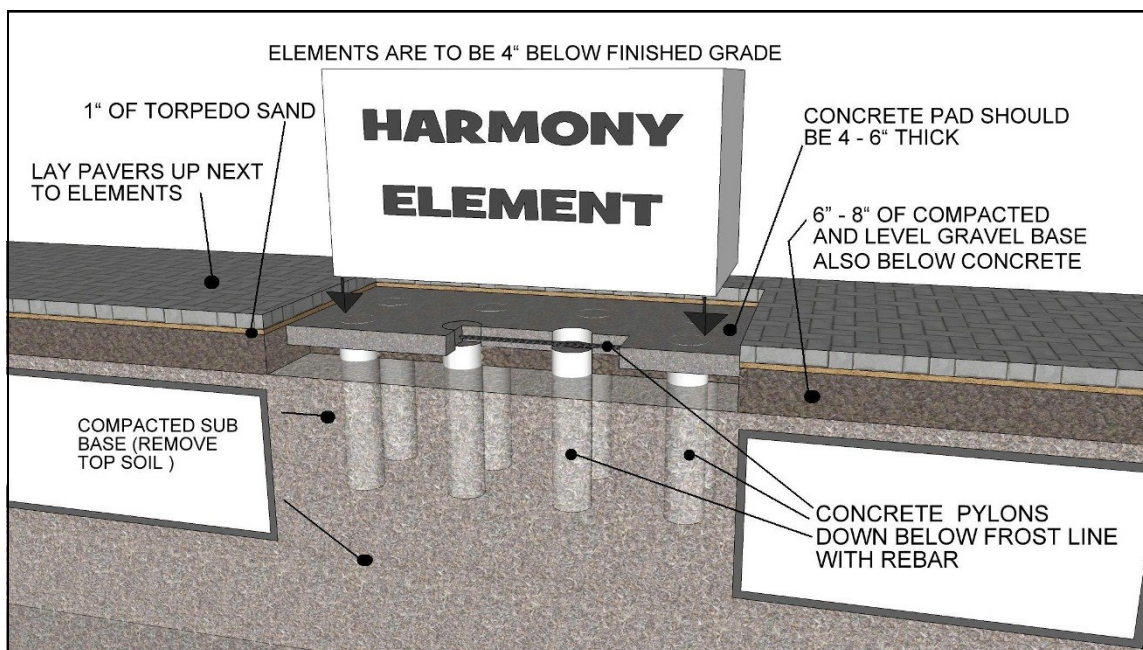

Typical Cross Section for Concrete Pad Installation

**** The following measurements are a suggestion. Always check your local building codes before installing.**

Top View

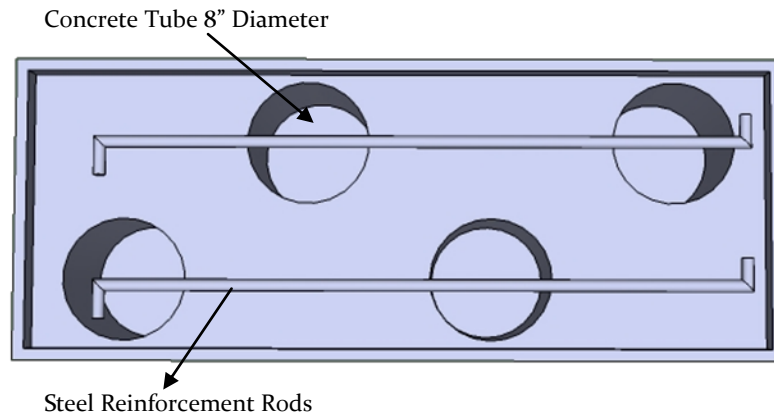

Side View

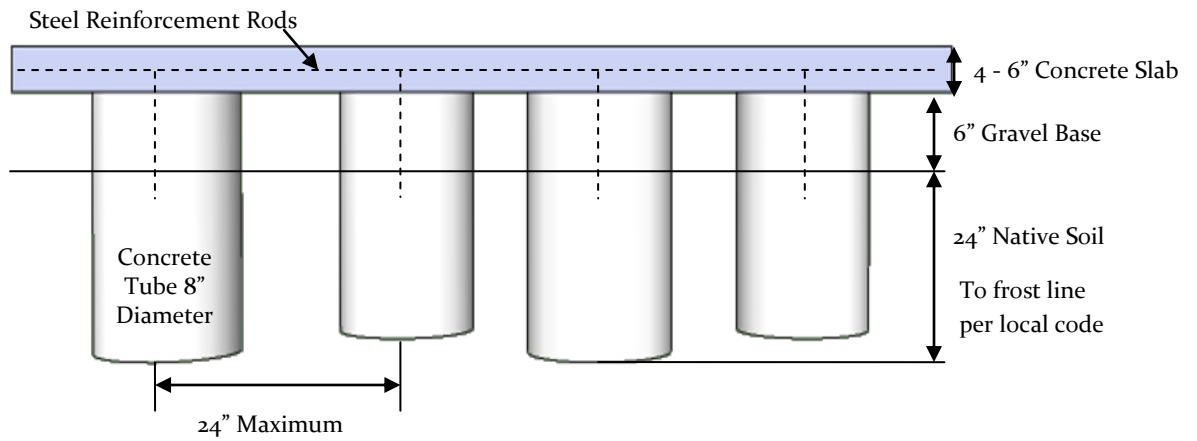

3D View

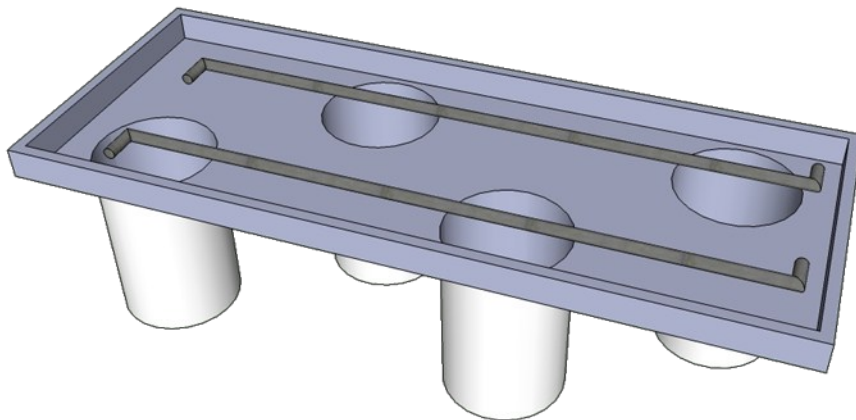



Creation Begins With The Elements. TM



HARMONY
OUTDOOR LIVING INC.

Harmony Outdoor Living, Inc.

701 Blackhawk Dr. - Unit F

Burlington, WI 53105

www.HarmonyOutdoorLiving.com