



2011 Belgard Product Guide

Creation
Begins
With
The
Elements.™



HARMONY
OUTDOOR LIVING INC.

Elements

“Elements are pre-built modular units that are manufactured with Belgard product by Harmony Outdoor Living, Inc. They are designed to flow seamlessly with the surrounding hardscape. Each module comes with fork slots that allow them to be installed with skid steers, forklifts, or even cranes. They are available in three main collections: Bristol, Wexford, and Nottingham. They are also available in two fireplace series: Euro and Brighton. Outdoor Kitchens are also available in endless configurations. In addition to these we also have Wall Insets and Lighting Options by FX”

Please note the following when placing an order:

- ***Please list the product ID/SKU***
- ***Choose a standard color scheme (or contact us for a 3D image of a custom color combination)***
- ***“Custom colors & accents” are available - call for information***
- ***Make sure to check the weights and plan to have the appropriate machine available***
- ***List any additional features/ upgrades, for example : lighting, accent changes, accessories, etc.***





The Bristol Collection



Bristol Fireplace



Product ID—BLFRPW (36" wood)
Product ID—BLFRPBOG
(gas burning, without chimney)
Product ID—BLFRPBG
(gas burning, with chimney/top)
Product ID—BLFRPBOL
(LP burning, without chimney/top)
Product ID—BLFRPBL
(LP burning, with chimney/top)

Approximate weight :
Bottom unit—3700 lbs.
Top unit —2590 lbs.

Rough dimensions :
5' x 3' x 9.5'

Bristol Wood Box



Approximate weight :
per box - 1794 lbs.

Rough dimensions :
3' x 3.3' x 3.25'

Product ID—BLWDBX

Bristol Water Feature Set



Approximate weight :
3640 lbs.

Rough dimensions :
4' x 2' x 3.5'

Product ID—BLWFPR

Bristol Arched Hearth



Approximate weight :
1045 lbs.

Rough dimensions :
5' x 2' x .9'

Product ID—BLHTA

Bristol 24" Water Feature



Approximate weight :
3075 lbs.

Rough dimensions :
4.3' x 3.7' x 4'

Product ID—BLWATFT

Bristol Pillar - Water Feature



Approximate weight :
Call for details.

Rough dimensions :
4' x 2' x 6'

Product ID—BLPLWT

Body	Accent
Ashbury Haze	Gascony Tan
Bristol Beige	Gascony Tan
Brookstone Slate	Cotswold Mist
Cotswold Mist	Brookstone Slate
Gascony Tan	Ashbury Haze
Bannockburn Red	Cotswold Mist

Bristol Pillar (24")



Approximate weight :
24" (1 inset)—1345 lbs.

Rough dimensions :
24" Column—2' x 2' x 3.9'

Product ID—BLPL124 (24" 1 inset) Product ID—BLPL324 (24" 3 insets)
Product ID—BLPL224 (24" 2 insets) Product ID—BLPL424 (24" 4 insets)

Bristol Brick Oven



Approximate weight :
Bottom unit—3015 lbs.
Top unit—3485 lbs.

Rough dimensions :
4' x 4' x 7.75'

Product ID—BLBRO

Bristol Grill Island



Approximate weight:
3834 lbs.

Rough dimensions :
6.3' x 3' x 4.3'

Product ID—BLGRISL

Bristol Bar



Approximate weight : 4060 lbs.
Rough dimensions : 6' x 2.7' x 4.25'

Product ID—BLBAR

Bristol Wet Bar



Approximate weight : Call for details.
Rough dimensions : 6' x 2.7' x 4.25'

Product ID—BLWBR

Bristol Fire Table

Product ID—BLRFTW (wood burning)
Product ID—BLRFTG (gas burning)
Product ID—BLRFTL (LP burning)



Approximate weight :
3100 lbs.

Rough dimensions :
3.7' x 3.7' x 3.8'

Tabletop dimensions :
4.3' x 4.3'

Bristol Fire Pit

Product ID—BLFRPITW (wood burning)
Product ID—BLFRPITG (gas burning)
Product ID—BLFRPITL (LP burning)



Approximate weight :
2115 lbs.

Rough dimensions :
3.3' x 3.3' x 2'

Body	Accent
Ashbury Haze	Gascony Tan
Bristol Beige	Gascony Tan
Brookstone Slate	Cotswold Mist
Cotswold Mist	Brookstone Slate
Gascony Tan	Ashbury Haze
Bannockburn Red	Cotswold Mist



The Wexford Collection



Wexford Fireplace



Product ID—WXFRPW (36" wood)
Product ID—WXFRPBOG
(gas burning, without chimney)
Product ID—WXFRPBG
(gas burning, with chimney/top)
Product ID—WXFRPBOL
(LP burning, without chimney/top)
Product ID—WXFRPBL
(LP burning, with chimney/top)

Approximate weight :
Bottom unit—3843 lbs.
Top unit —2703 lbs.

Rough dimensions :
5' x 3' x 9.5'

Wexford Wood Box Set



Approximate weight :
per box - 1907 lbs.

Rough dimensions :
3' x 3.3' x 3.25'

Product ID—WXWDBX

Wexford Water Feature Set (12")



Approximate weight :
3675 lbs.

Rough dimensions :
4' x 2' x 3.5'

Product ID—WXWFPR

Wexford Straight Hearth



Approximate weight :
1160 lbs.

Rough dimensions :
5' x 2' x .9'

Product ID—WXHTS

Wexford 24" Water Feature



Approximate weight :
3086 lbs.

Rough dimensions :
4.3' x 3.7' x 4'

Product ID—WXWATFT

Wexford Pillar - Water Feature

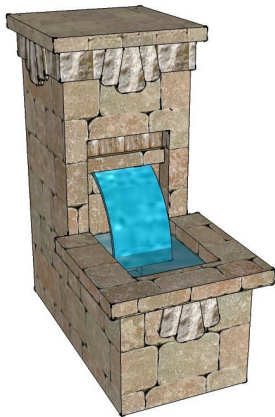

Approximate weight :
Call for details.

Rough dimensions :
4' x 2' x 5.5'

Product ID—WXPLWT

Body	Accent
Ashbury Haze	Gascony Tan
Bristol Beige	Gascony Tan
Brookstone Slate	Cotswold Mist
Cotswold Mist	Cotswold Mist
Gascony Tan	Gascony Tan
Bannockburn Red	Cotswold Mist

Wexford Pillar (24")



Approximate weight :
24" (1 inset)—1325 lbs.

Rough dimensions :
24" Column—2' x 2' x 3.7'

Product ID—WXPL24

Wexford Brick Oven



Approximate weight :
Bottom unit—3040 lbs.
Top unit—3800 lbs.

Rough dimensions :
4' x 4' x 7.75'

Product ID—WXBRO

Wexford Grill Island



Approximate weight:
3895 lbs.

Rough dimensions :
6.3' x 3' x 4.3'

Product ID—WXGRISL

Wexford Bar



Approximate weight : 4105 lbs.
Rough dimensions : 6' x 2.7' x 4.25'

Product ID—WXBAR

Wexford Wet Bar

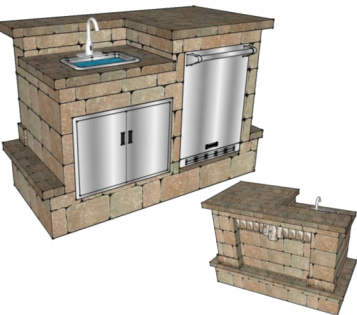

Approximate weight : Call for details.
Rough dimensions : 6' x 2.7' x 4.25'

Product ID—WXWBR

Wexford Fire Table

Product ID—WXRFTW (wood burning)
Product ID—WXRFTG (gas burning)
Product ID—WXRFTL (LP burning)



Approximate weight :
3090 lbs.

Rough dimensions :
3.7' x 3.7' x 3.8'

Tabletop dimensions :
4' x 4'

Wexford Fire Pit

Product ID—WXFRPITW (wood burning)
Product ID—WXFRPITG (gas burning)
Product ID—WXFRPITL (LP burning)



Approximate weight :
2235 lbs.

Rough dimensions :
3.3' x 3.3' x 2'

Body	Accent
Ashbury Haze	Gascony Tan
Bristol Beige	Gascony Tan
Brookstone Slate	Cotswold Mist
Cotswold Mist	Cotswold Mist
Gascony Tan	Gascony Tan
Bannockburn Red	Cotswold Mist



The Nottingham Collection



Nottingham Fireplace



Product ID—NTFRPW (36" wood)
Product ID—NTFRPBOG (gas burning, without chimney)
Product ID—NTFRPBG (gas burning, with chimney/top)
Product ID—NTFRPBOL (LP burning, without chimney/top)
Product ID—NTFRPBL (LP burning, with chimney/top)
Approximate weight :
Call for details.
Rough dimensions :
6' x 3' x 10'

Nottingham Wood Box Set



Approximate weight :
Call for details.
Rough dimensions :
2.8' x 3.75' x 3.1'

Product ID—NTWDBX

Nottingham Water Feature Set (12")

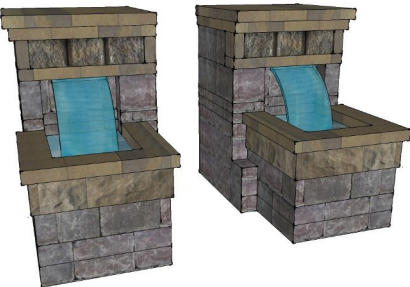

Approximate weight :
Call for details.
Rough dimensions :
4' x 2' x 3.5'

Product ID—NTWFPR

Nottingham Arched Hearth



Approximate weight :
Call for details.
Rough dimensions :
5' x 2' x .9'

Product ID—NTHTA

Nottingham 24" Water Feature



Approximate weight :
3086 lbs.
Rough dimensions :
4.3' x 3.7' x 4'

Product ID—NTWATFT

Nottingham Pillar-Water Feature

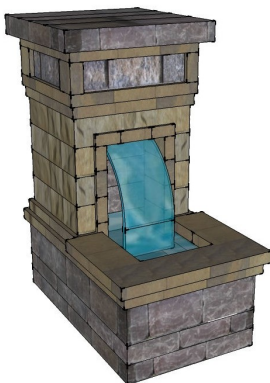

Approximate weight :
Call for details.
Rough dimensions :
4' x 2.3' x 5.1'

Product ID—NTPLWT

Body	Accent
Belair Cotswold Mist	Highland Gascony Tan
Belair Gascony Tan	Highland Cotswold Mist
Belair Copper Stone	Highland Cotswold Mist

Nottingham Pillar (28")



Approximate weight :
Call for details.

Rough dimensions :
2.3' x 2.3' x 4.5'

Product ID—NTPL28

Nottingham Brick Oven



Approximate weight :
Call for details.

Rough dimensions :
4' x 4' x 7.75'

Product ID—NTBRO

Nottingham Grill Island



Approximate weight:
Call for details.

Rough dimensions :
6.5' x 3' x 3.9'

Product ID—NTGRISL

Nottingham Bar/Grill Island (11')

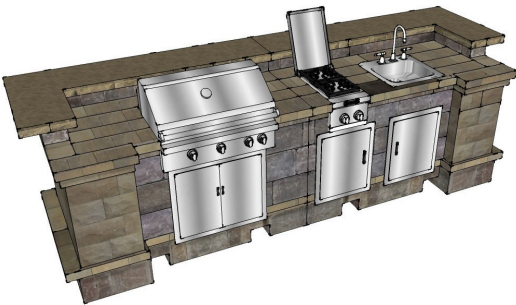

Approximate weight :
Call for details.

Rough dimensions :
11' x 3' x 3.9'

Product ID—NTBRGR

Nottingham Fire Table



Approximate weight :
Call for details.

Rough dimensions :
4' x 4' x 3.8'

Product ID—NTRFTG (gas burning)

Nottingham Fire Pit



Approximate weight :
Call for details.

Rough dimensions :
5.75' x 3.4' x 2.3'

Product ID—NTFRPITG (gas burning)

Body	Accent
Belair Cotswold Mist	Highland Gascony Tan
Belair Gascony Tan	Highland Cotswold Mist
Belair Copper Stone	Highland Cotswold Mist



The Euro Series

Euro See-Thru Fireplace



Approximate weight & dimensions :
Call for details.

Product ID—EUFPRST



Euro Water Feature

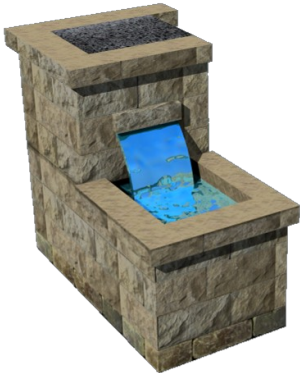

Approximate weight & dimensions :
Call for details.

Product ID—EUWTFTL (Left Side)

Product ID—EUWTFTR (Right Side)

Euro Bench

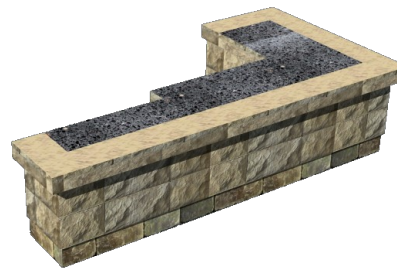

Approximate weight & dimensions :
Call for details.

Product ID—EUBENCHL (Left Side)

Product ID—EUBENCHR (Right Side)

Euro Display Cabinet (Small)



Approximate weight & dimensions :
Call for details.

Product ID—EUWDBXL (Left Side)

Product ID—EUWDBXR (Right Side)

Euro Display Cabinet (Large)

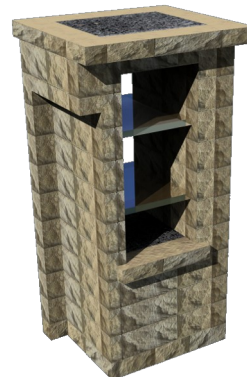

Approximate weight & dimensions :
Call for details.

Product ID—EUTOWERL (Left Side)

Product ID—EUTOWERR (Right Side)



The Brighton Series

“The Brighton Fireplace series offers an attractive alternative to site built kits. Their lower price point opens them up to a wide market of consumers. Note the built in standard hearth and wrought inlay.”



Brighton Arched Fireplace



Product ID—BTFPAPW (36" wood)

Product ID—BTFPABG
(gas burning, without chimney)

Product ID—BTFPATG
(gas burning, with chimney/top)

Product ID—BTFPABGL
(LP burning, without chimney/top)

Product ID—BTFPATGL
(LP burning, with chimney/top)

Approximate weight : Call for details.

Rough dimensions : 4.3' x 3' x 8.5'

Brighton Wood Boxes



Approximate weight : Call for details.

Rough dimensions : 2.3' x 2.7' x 2.9'

Product ID—BTWDBX

Wall Inset Options



Wall Inset 101



Approximate weight :
134 lbs.

Rough dimensions :
20" x 20" x 6"

Product ID—WLST101

Wall Inset 106



Approximate weight :
200 lbs.

Rough dimensions :
24" x 24" x 6"

Product ID—WLST106

Wall Inset 109



Approximate weight :
190 lbs.

Rough dimensions :
24" x 24" x 6"

Product ID—WLST109

Wall Inset 104



Approximate weight :
190 lbs.

Rough dimensions :
24" x 24" x 6"

Product ID—WLST104

Wall Inset 107



Approximate weight :
205 lbs.

Rough dimensions :
24" x 24" x 6"

Product ID—WLST107

Wall Inset 110



Approximate weight :
200 lbs.

Rough dimensions :
24" x 28" x 6"

Product ID—WLST110

Wall Inset 105



Approximate weight :
215 lbs.

Rough dimensions :
28" x 24" x 6"

Product ID—WLST105

Wall Inset 108



Approximate weight :
210 lbs.

Rough dimensions :
24" x 24" x 6"

Product ID—WLST108

Wall Inset 111



Approximate weight :
150 lbs.

Rough dimensions :
20" x 24" x 6"

Product ID—WLST111



Outdoor Modular Kitchens



“Outdoor Kitchen Elements are available in almost endless configurations. For your convenience we have many examples of pre-designed configurations. In every instance, please contact Harmony directly at (877) 332-6842 for a complete 3D color rendering of what you are considering. Here is an example of some of the standard and available features.”

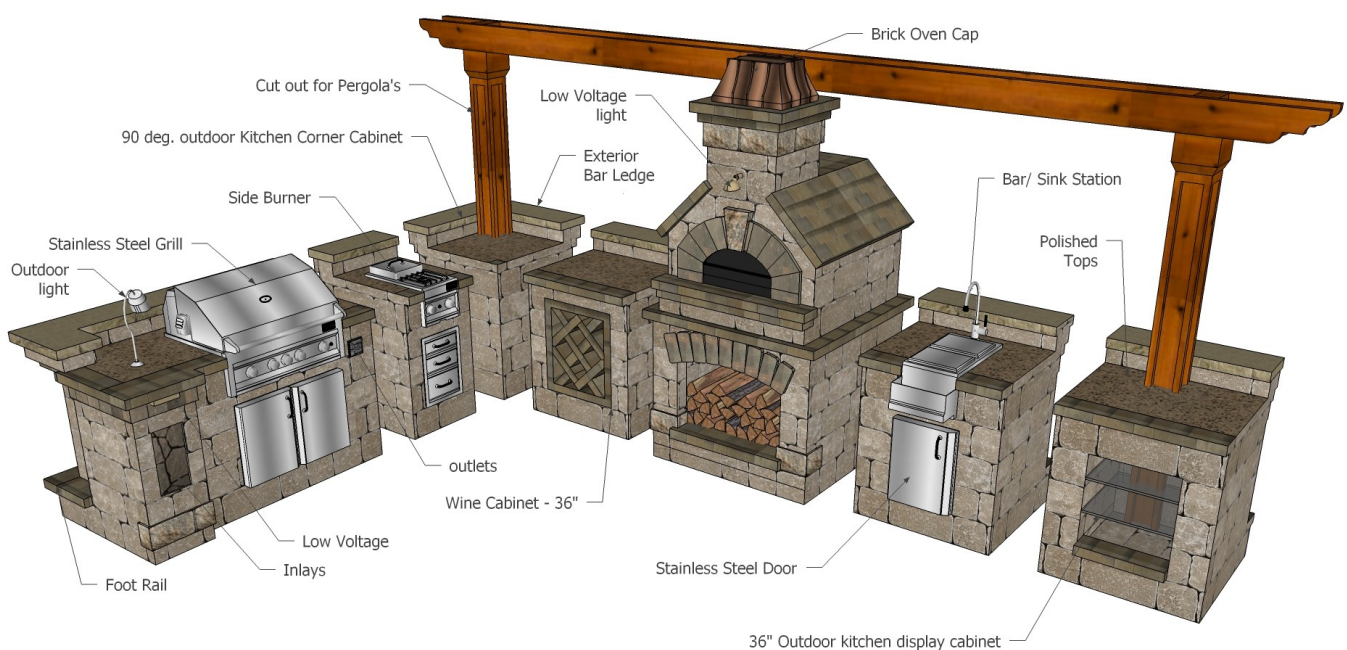

105 Kitchen



Approximate weight & features : Call for details.

Rough dimensions : 40" D x 108" W x 49.5" H

120 Kitchen



Approximate weight & features : Call for details.

Rough dimensions : 144" D x 264" W x 49.5" H

110 Kitchen

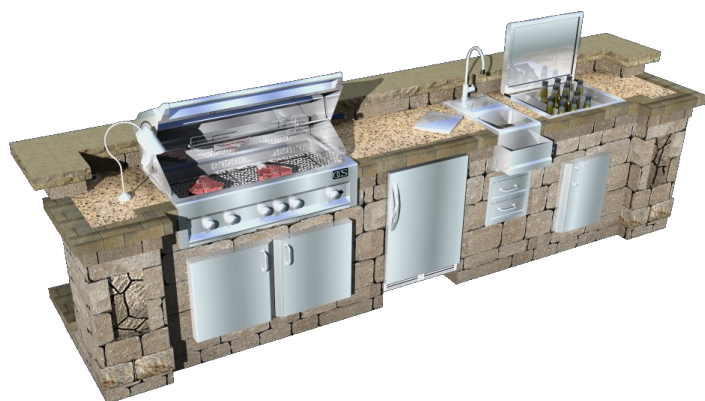

Approximate weight & features : Call for details.

Rough dimensions : 40" D x 176" W x 49.5" H

125 Kitchen



Approximate weight & features : Call for details.

Rough dimensions : 40" D x 164" W x 49.5" H

115 Kitchen

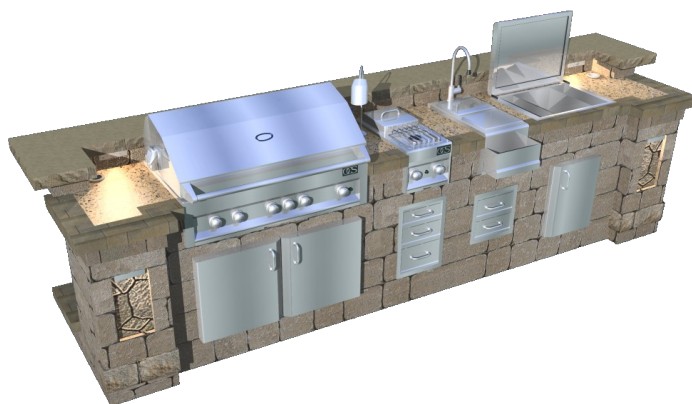

Approximate weight & features : Call for details.

Rough dimensions : 40" D x 168" W x 49.5" H

205 Kitchen



Approximate weight & features : Call for details.

Rough dimensions : 108" D x 108" W x 49.5" H

210 Kitchen



Approximate weight & features : Call for details.

Rough dimensions : 136" D x 104" W x 49.5" H

225 Kitchen

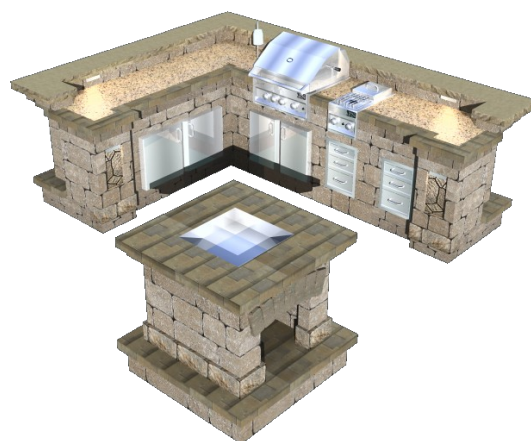

Approximate weight & features : Call for details.

Rough dimensions : 148" D x 1148" W x 49.5" H

215 Kitchen



Approximate weight & features : Call for details.

Rough dimensions : 104" D x 136" W x 49.5" H

305 Kitchen



Approximate weight & features : Call for details.

Rough dimensions : 94" D x 166" W x 49.5" H

220 Kitchen



Approximate weight & features : Call for details.

Rough dimensions : 104" D x 136" W x 49.5" H

310 Kitchen

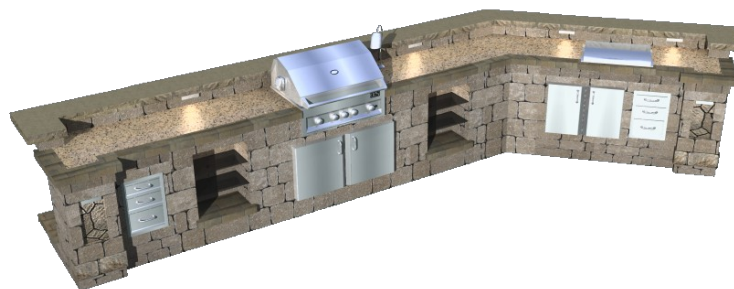

Approximate weight & features : Call for details.

Rough dimensions : 94" D x 262" W x 49.5" H

320 Kitchen



Approximate weight & features : Call for details.

Rough dimensions : 114" D x 260" W x 49.5" H

410 Kitchen



Approximate weight & features : Call for details.

Rough dimensions : 164" D x 184" W x 49.5" H

325 Kitchen



Approximate weight & features : Call for details.

Rough dimensions : 192" D x 180" W x 49.5" H

420 Kitchen

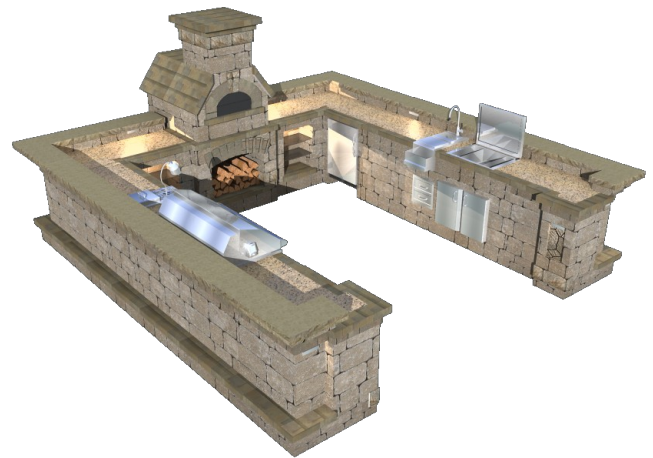

Approximate weight & features : Call for details.

Rough dimensions : 184" D x 196" W x 49.5" H

405 Kitchen

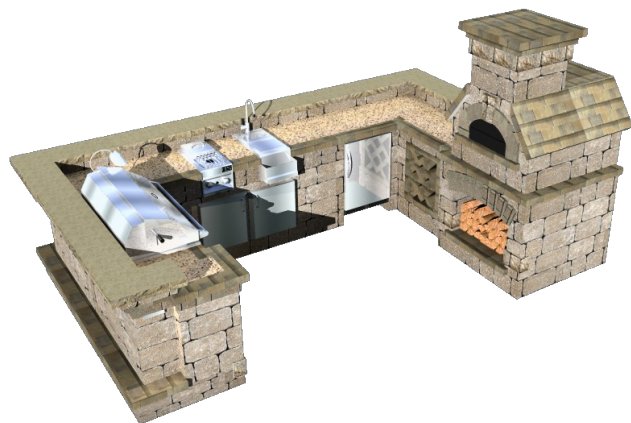

Approximate weight & features : Call for details.

Rough dimensions : 104" D x 192" W x 49.5" H

425 Kitchen



Approximate weight & features : Call for details.

Rough dimensions : 224" D x 192" W x 49.5" H

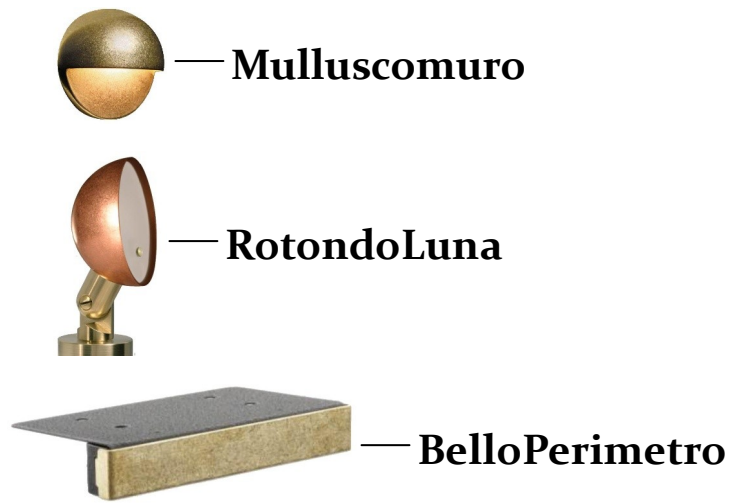

“Low Voltage Lighting fixtures from FX are available as upgrades. Please contact us directly for specific colors. We offer the BelloPerimetro (lip light), Mulluscomuro, and RotondoLuna models. Below are lighting diagrams of possible lighting locations. Be sure to specify which model, color, and location you prefer. Note, each light comes with enough wire to protrude from the back of the Element. They DO NOT include any connectors or transformers.”

Fireplace Units

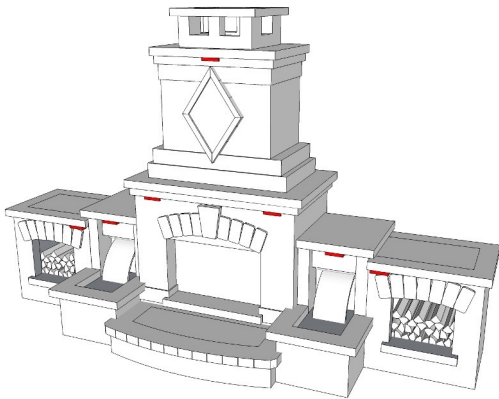

Brick Oven

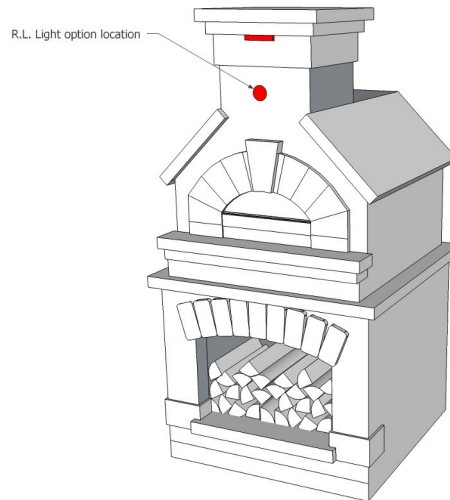

Grill Island

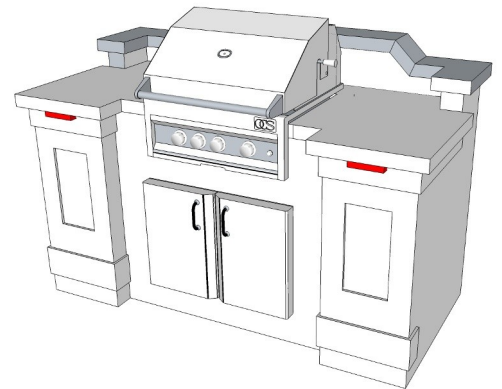

Pillar

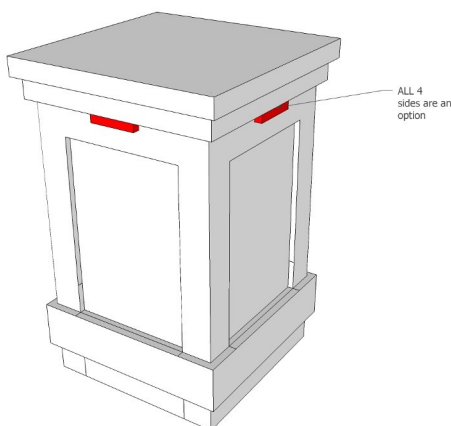

Fire Table

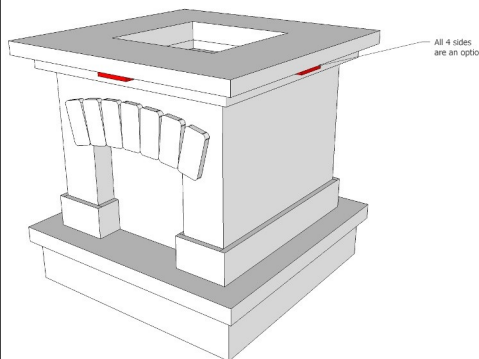

Bar Island

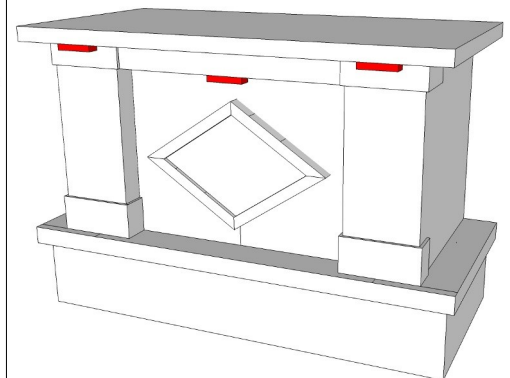



Installation Instructions



Installation

"Elements are very easy to install. Here are a couple cross section details to consider. Keep in mind, these ARE NOT engineered plans. Make sure you check with your local municipality for their requirements when installing Elements. Here are a few other key points to remember:

- *Always place a piece of material (plywood or carpet work well) between your forks and the Element to prevent chipping*
- *Always transport the Element on the pallet it comes with until you are ready to place on the permanent location*
- *Make sure to use a ratchet strap to secure the Element to the loader when placing*
- *Handle Elements with care – they are concrete but not indestructible*
- *Make sure to size the machine to the Elements weight*
- *All Elements are designed to be buried 4" below finish grade (note – bars need to be buried 8" below finish grade)*

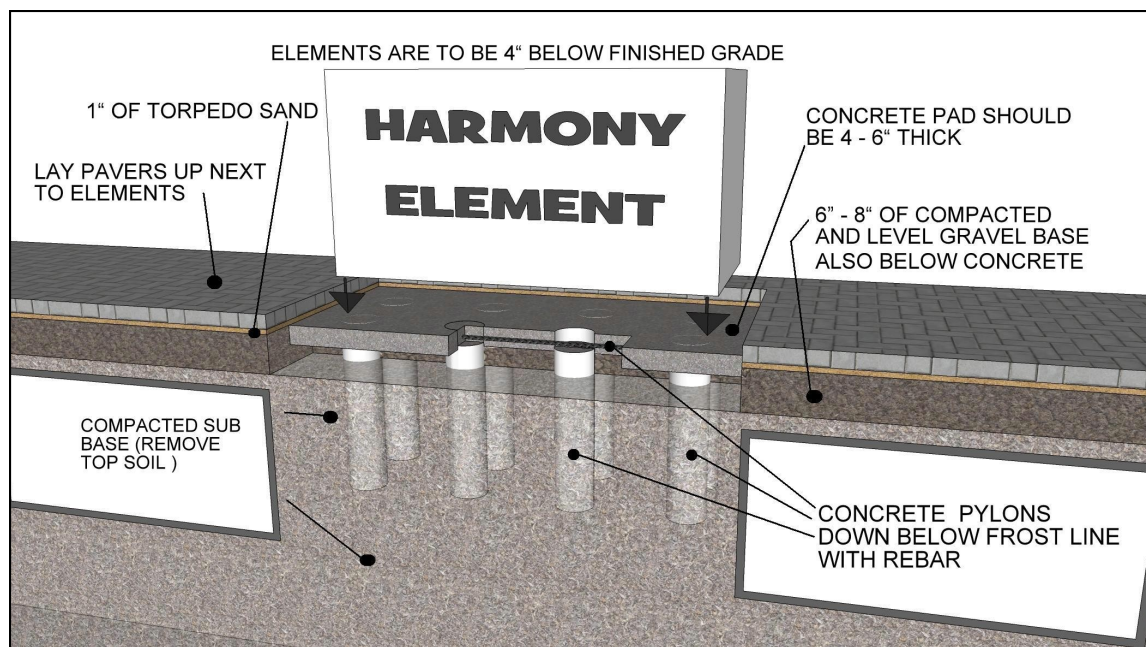

Typical Cross Section for Concrete Pad Installation

**** The following measurements are a suggestion. Always check your local building codes before installing.**

Top View

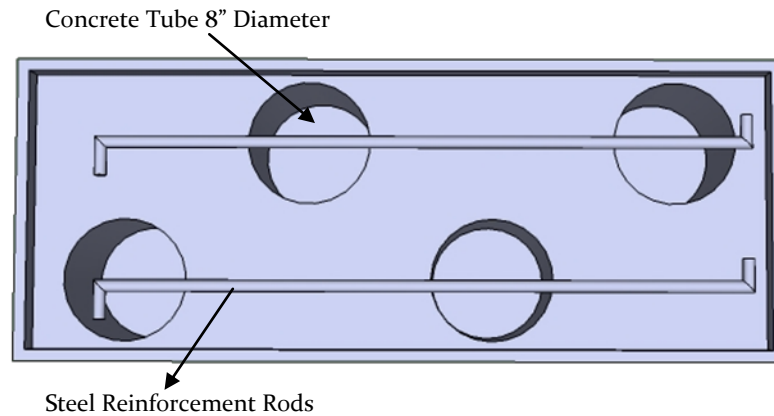

Side View

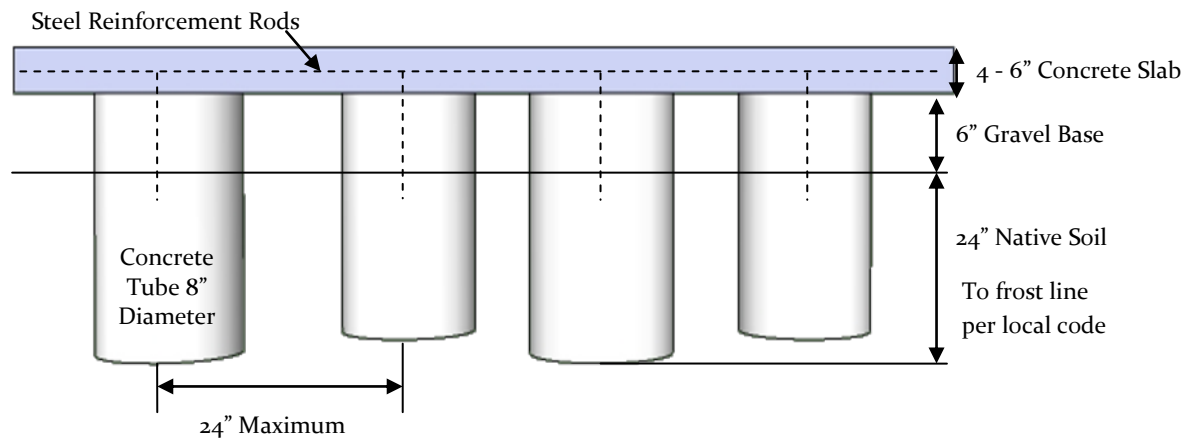

3D View

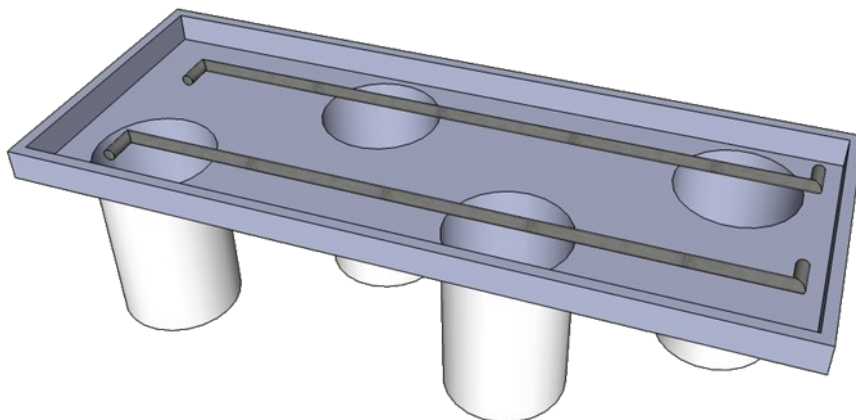

Trailer Layout Guide

Load 1

lbs

1	3	5	7	9	11	13	15
2	4	6	8	10	12	14	16

Load 2

lbs

Brick Oven Base	Brick Oven Top	12" Pair Water Feature	24" Water Feature	Fire Pit	Fire Table	1	3
					Hearth	2	4

Load 1

Load 1 shows a layout for the number of Elements that can be loaded on a typical 48 ft trailer. We start with 16 and break it down by weight from there. For Bristol and Wexford we can only get 7 fireplaces on so we only use 14 slots. For the Brighton fireplace we can use all 16 so we get 8 fireplaces on.

* Make sure the truck can haul 48,000lbs when taking 7 fireplaces.

Load 2

Load 2 shows the items that will take up 2 slots because of there size. It also shows how we sometimes will stack the hearths on a load.

The best thing to do is follow this guide and then we will make a minor adjustment on a piece or two once we receive the order. We now send out a sheet like this after we receive a PO so you can see how much room is being used on a trailer. Any questions please let me know.



Creation Begins With The Elements. TM



HARMONY
OUTDOOR LIVING INC.

Harmony Outdoor Living, Inc.

701 Blackhawk Dr. - Unit F

Burlington, WI 53105

www.HarmonyOutdoorLiving.com