



THE LIFESTYLES COLLECTION

WE'VE ALL EXPERIENCED THAT MAGIC MOMENT, THE PERFECT INSTANT WHEN TIME STANDS STILL, WHERE EVERYTHING FALLS INTO PLACE AND COMES TOGETHER. THAT'S WHAT YOU ENVISION FOR YOUR OUTDOOR SPACE: ELEGANCE, BEAUTY, ENJOYMENT. YOU CAN SEE IT IN YOUR MIND'S EYE, YOU CAN FEEL THE AMBIANCE: A WELCOMING ENTRANCE, SOMEWHERE TO ESCAPE TO AND DREAM, A SETTING FOR A PARTY OR A RENDEZ-VOUS, A PLACE OF PLEASURE AND PEACE. YOU WANT TO MOVE BEYOND DREAMS TO CREATE, REINVENT. DREAM UP A SPACE, DEVELOP A DESIGN. ARRANGE SHAPES, MATCH COLOURS, COMBINE MATERIALS. **BELGARD SHARES YOUR DREAM.** WE HAVE DEVELOPED A HUGE RANGE OF TOP-QUALITY PRODUCTS WITH INCOMPARABLE AESTHETICS. WE HAVE HONED SOLUTION-PACKED TOOLS THAT WILL HELP YOU CREATE THE SPACES YOU'VE DREAMED ABOUT, SPACES WHICH WILL NATURALLY SUIT YOU.



LIFESTYLE DESIGNS

- 1 | SAMPLE DESIGN 1 - KEY PLAN
- 2 | SAMPLE DESIGN 1 - VIEW 1
- 3 | SAMPLE DESIGN 1 - VIEW 2
- 4 | SAMPLE DESIGN 2 - KEY PLAN
- 5 | SAMPLE DESIGN 2 - VIEW 1
- 6 | SAMPLE DESIGN 2 - VIEW 2
- 7 | SAMPLE DESIGN 3 - KEY PLAN
- 8 | SAMPLE DESIGN 3 - VIEW 1
- 9 | SAMPLE DESIGN 3 - VIEW 2

APPENDIX - DESIGN DETAILS

- 10-15 | D1 FIREPLACE UNITS
- 16-22 | D2 KITCHEN UNITS
- 23-25 | D3 FIRE PIT UNITS
- 26-27 | D4 WATER FEATURES
- 28-29 | D5 PLANTERS
- 30-31 | D6 ARBOR
- 32-34 | D7 COLUMNS
- 35-37 | D8 ENTRY FEATURE
- 38-39 | D9 BENCHES



FIREPLACE
D1 / PG. 10

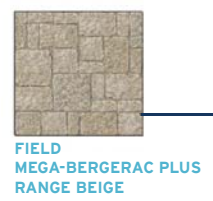

FIELD MEGA-BERGERAC PLUS RANGE BEIGE

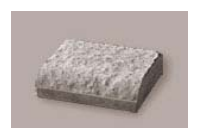

AQUASTYL POOL COPING



BANDING OLD WORLD RANGE GREY



CELTIK WALL CAP



WATER FEATURE
D4 / PG. 27



ARBOUR
D6 / PG. 30-31



PLANTER
D5 / PG. 28



BENCH
D8 / PG. 38



KITCHEN
D2 / PG. 16



WALL WESTON RANGE GREY



FIELD URBANA PAVERS RANGE GREY



FIREPIT
D3 / PG. 23



ENTRY FEATURE
D8 / PG. 35



WALL LAFITT RANGE GREY



FIELD MEGA BERGERAC PLUS RANGE BEIGE



FIELD MEGA-BERGERAC PLUS RANGE BROWN



BANDING OLD WORLD RANGE GREY

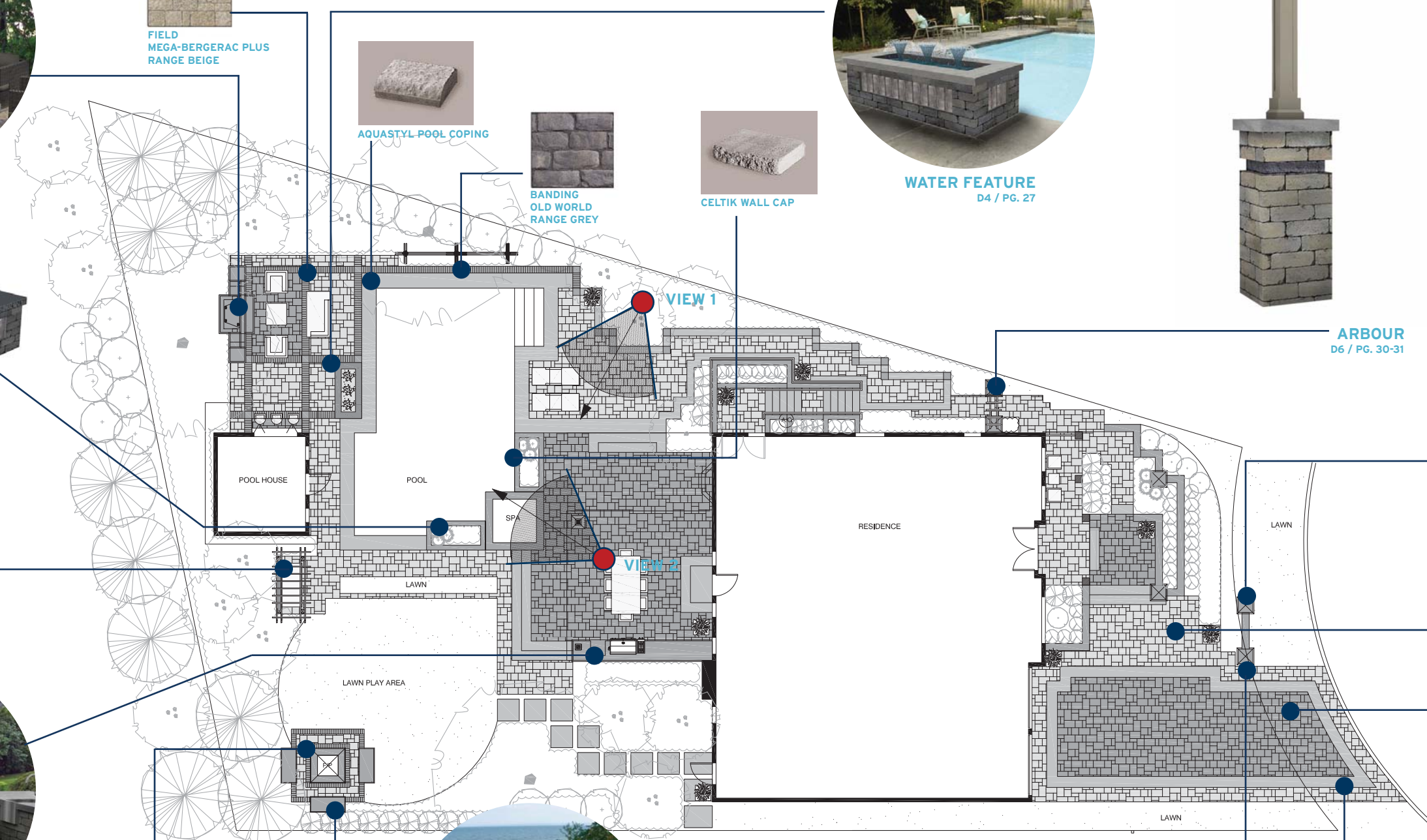





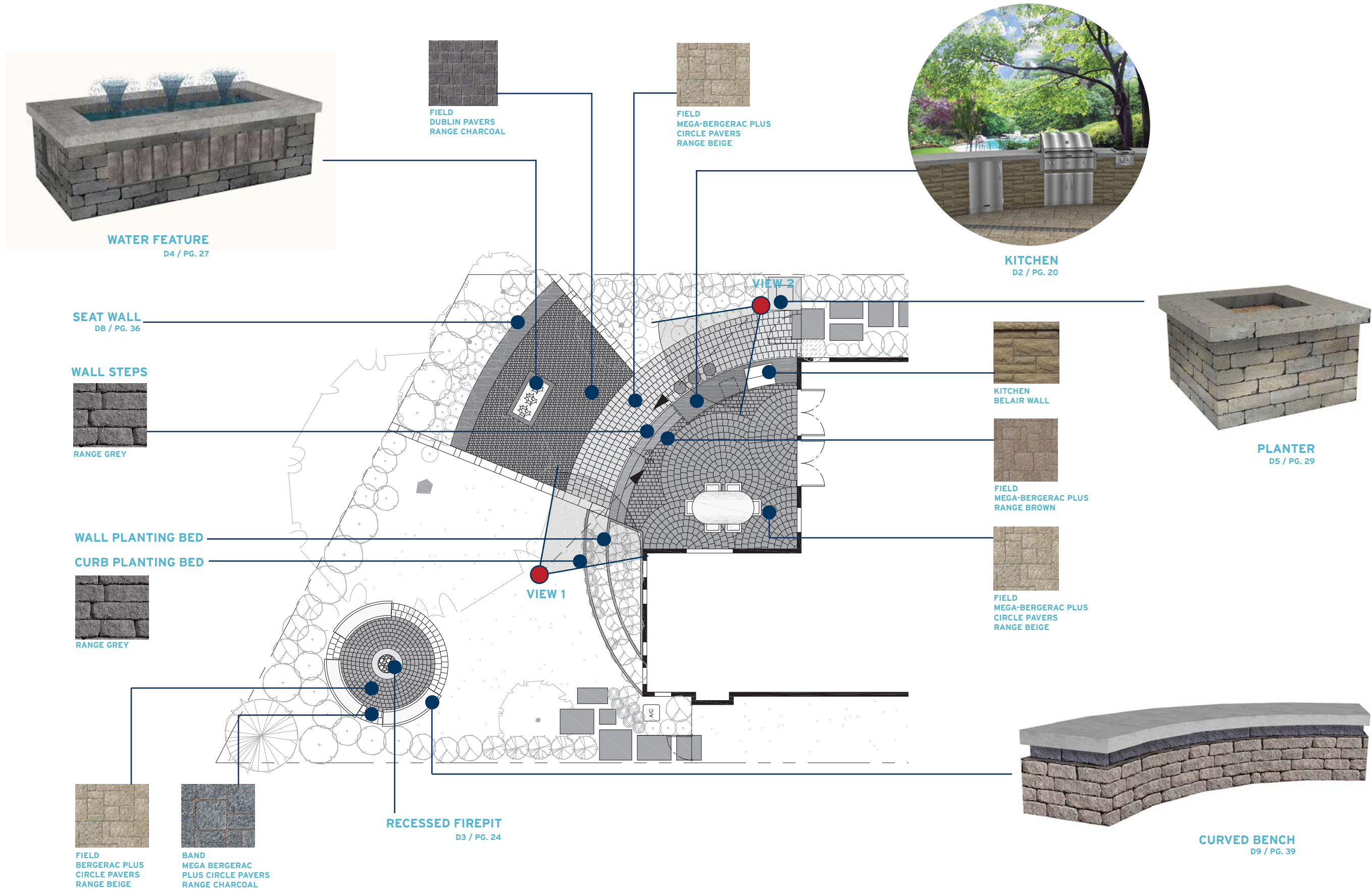







FIRE PLACE
D1 / PG. 10



COUNTER WITH STOOLS
D2 / PG. 17



ENTRY FEATURE
D8 / PG. 36



WATER FEATURE
D4 / PG. 26



KITCHEN
D2 / PG. 16

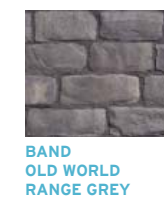
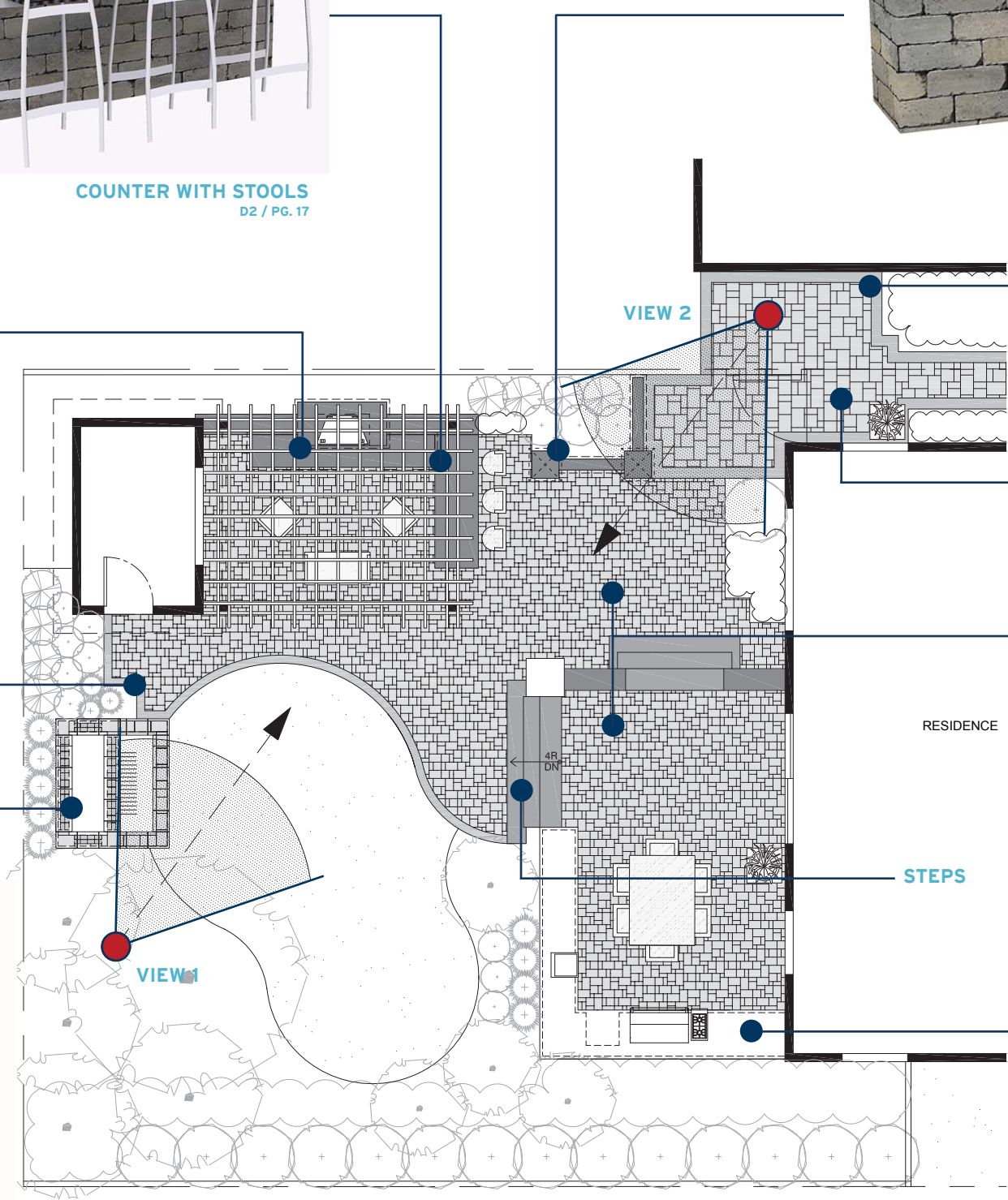

**BAND
OLD WORLD
RANGE GREY**



**BAND
OLD WORLD
RANGE GREY**



**FIELD
MEGA-BERGERAC PLUS
RANGE BEIGE**



**FIELD
URBANA
RANGE GREY**







WESTON STONE FIREPLACE | PRODUCT SUMMARY

A gas burning fireplace insert, set within our Weston Wall, accented with our Old World paver. Designed in modules, the Weston Fireplace can be configured in various ways to suit your taste and design. Page 11 gives 3 examples of how these modules can be interchanged.

WESTON STONE



BEIGE GREY BEIGE AND BLACK CHARCOAL

MATERIAL LIST | SCHEDULE OF QUANTITIES

PRODUCT	QUANTITY
Weston Stone Wall	11.28 M ² / 121.4 Ft ²
Old World Pavers	1 M ² / 10.76 Ft ²
Coping Unit Dimensions - See Chart, Page 11.	

SIDE ELEVATION

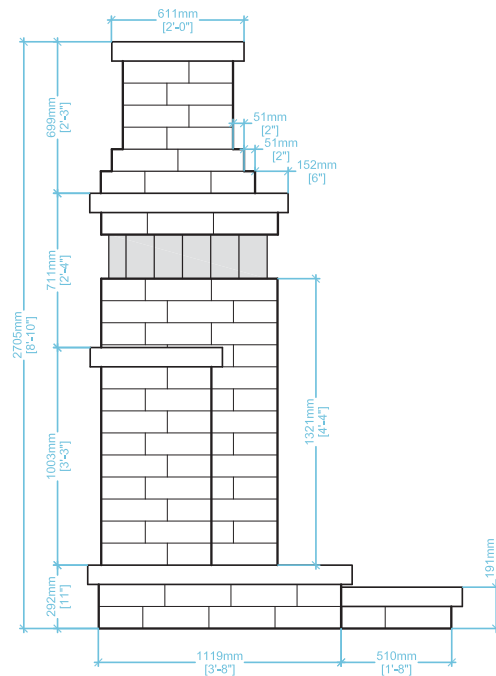

NOTE:
BASED ON NATURAL GAS FIREPLACE:
"MAJESTIC" ODGSR42A BY VERMONT
CASTINGS.
FOR ALTERNATIVE INSERTS REFER TO
MANUFACTURER'S INSTRUCTIONS

PLAN

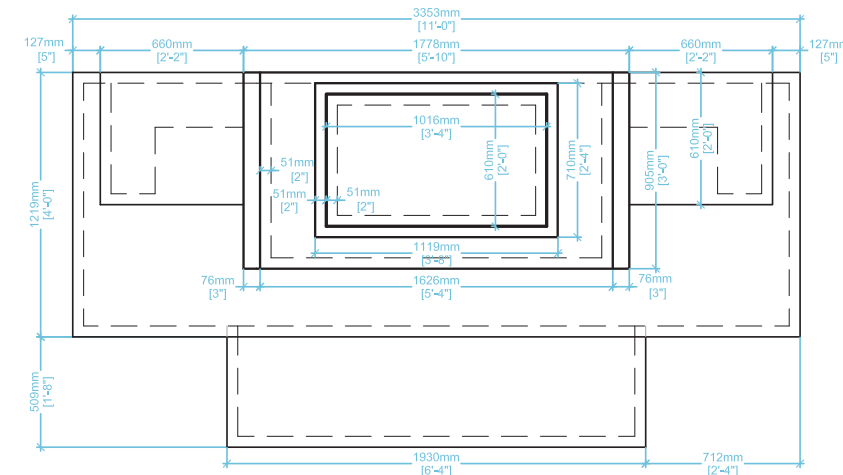

FRONT ELEVATION

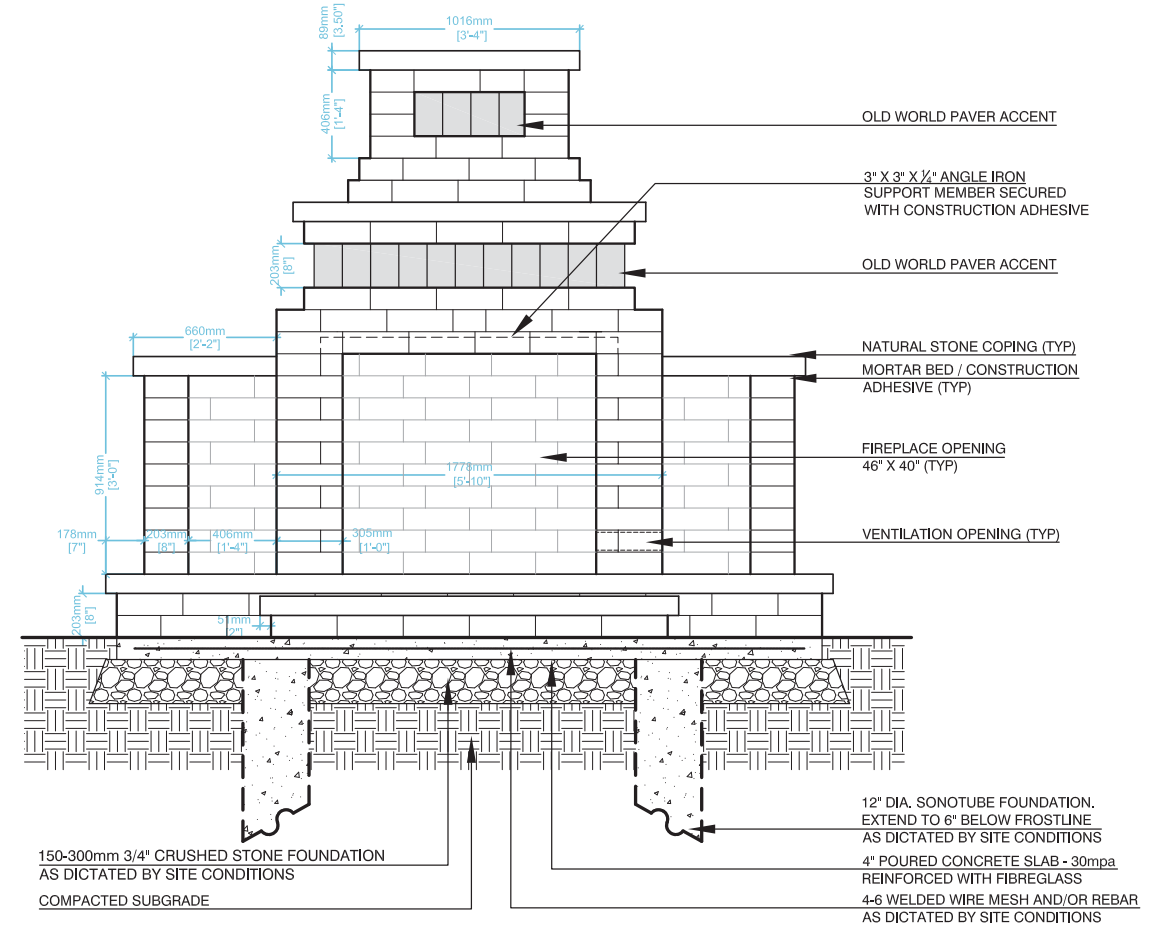

12" DIA. SONOTUBE FOUNDATION.
EXTEND TO 6" BELOW FROSTLINE
AS DICTATED BY SITE CONDITIONS
4" POURED CONCRETE SLAB - 30mpa
REINFORCED WITH FIBREGLASS
4-6 WELDED WIRE MESH AND/OR REBAR
AS DICTATED BY SITE CONDITIONS

GENERAL NOTES:

- Built-in appliances vary in size. Refer to manufacturer's specifications for installation and dimensional requirements. Actual hardscaping dimensions may vary based on appliances used.
- Contractor to check that fireplace complies with all local bylaw and code requirements.
- All joints to be sealed with non-combustable material.



CAP UNIT

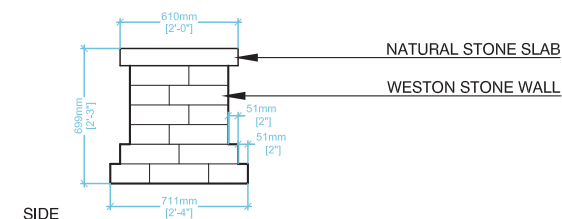
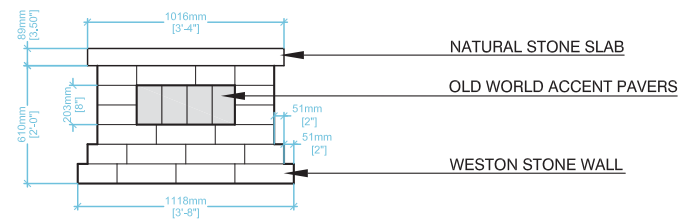

MATERIALS LIST
 WESTON STONE WALL - 1.77m² / 19.09 ft²
 OLD WORLD ACCENT - 0.10 m² / 1.13 ft²
 NATURAL STONE COPING UNIT - 1016 mm (40") X 609 mm (24")

FRONT

SIDE

WING WALL UNIT

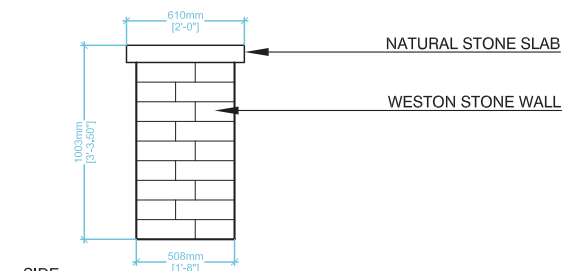
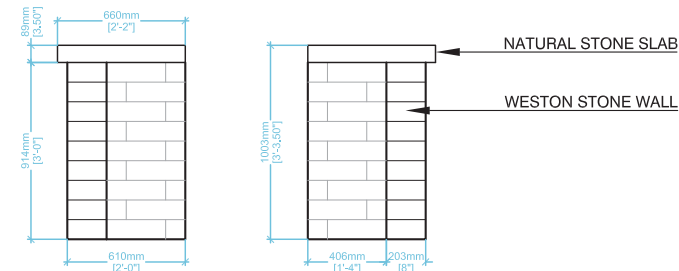

WESTON STONE WALL - 1.03 m² / 11.12 ft²
 OLD WORLD ACCENT - 0.10 m² / 1.13 ft²
 NATURAL STONE COPING UNIT - 660 mm (26") X 609 mm (24")
 NOTE:
 WING WALL QUANTITIES ARE FOR ONE SIDE ONLY

FRONT

SIDE

FIREPLACE UNIT

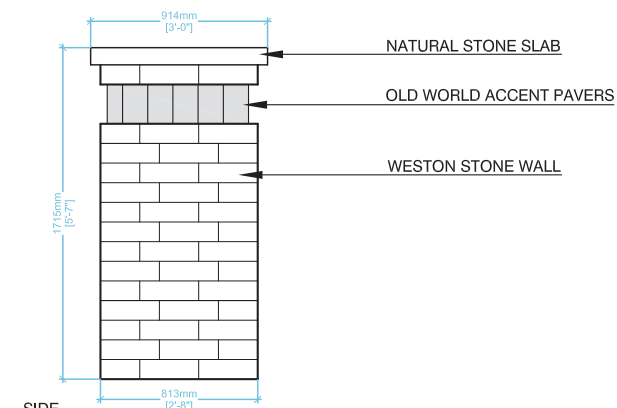
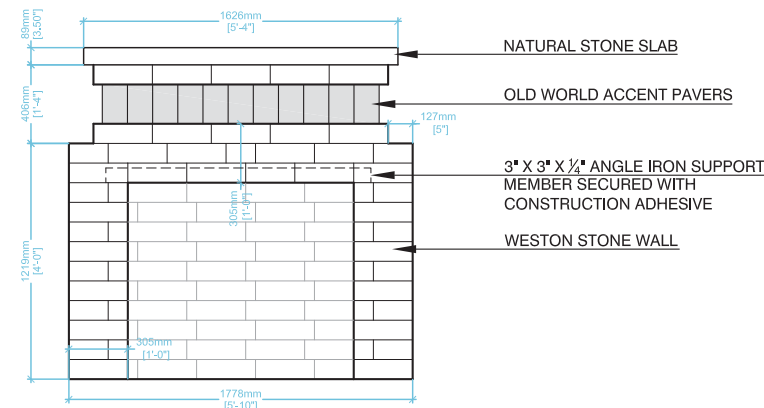

WESTON STONE WALL - 6.03 m² / 64.92 ft²
 OLD WORLD ACCENT - 0.89 m² / 9.55 ft²
 NATURAL STONE COPING UNIT - 1625 mm (64") X 914 mm (36")

FRONT

SIDE

BASE UNIT

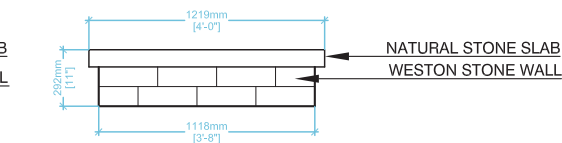
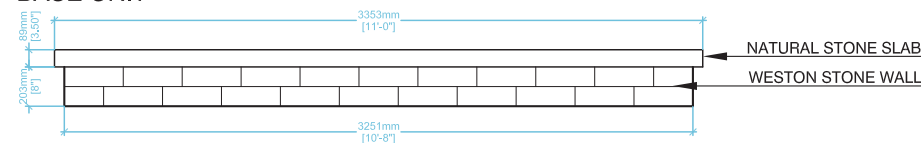

WESTON STONE WALL - 1.13 m² / 12.13 ft²
 NATURAL STONE COPING UNIT - 3353 mm (132") X 1219 mm (48")

FRONT

SIDE

HEARTH UNIT

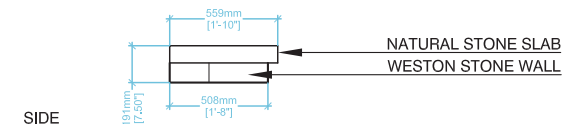
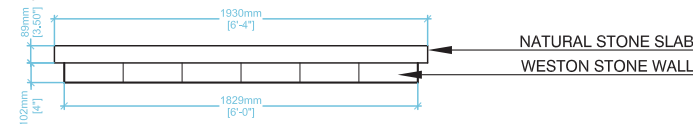

WESTON STONE WALL - 0.29 m² / 3.13 ft²
 NATURAL STONE COPING UNIT - 1943 mm (76.5") X 558 mm (22")

FRONT

SIDE





CELTIK FIREPLACE | PRODUCT SUMMARY

A gas burning fireplace insert, set within our Celtik Wall, accented with Weston Stone. Designed in modules, the Celtik Fireplace can be configured in various ways to suit your taste and design. Page 13 gives 3 examples of how these modules can be interchanged.

CELTIK



MATERIAL LIST | SCHEDULE OF QUANTITIES

PRODUCT	QUANTITY
Celtik Wall	10.26 M ² / 110.4 Ft ²
Weston Stone	1.31 M ² / 14.1 Ft ²
Coping Unit Dimensions - See Chart, Page 13.	

SIDE ELEVATION

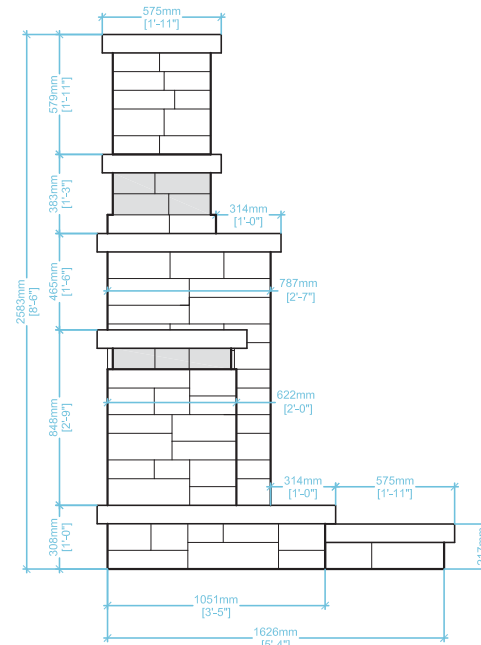

NOTE:
BASED ON NATURAL GAS FIREPLACE:
"MAJESTIC" ODGSR42A BY VERMONT
CASTINGS.
FOR ALTERNATIVE INSERTS REFER TO
MANUFACTURER'S INSTRUCTIONS

PLAN

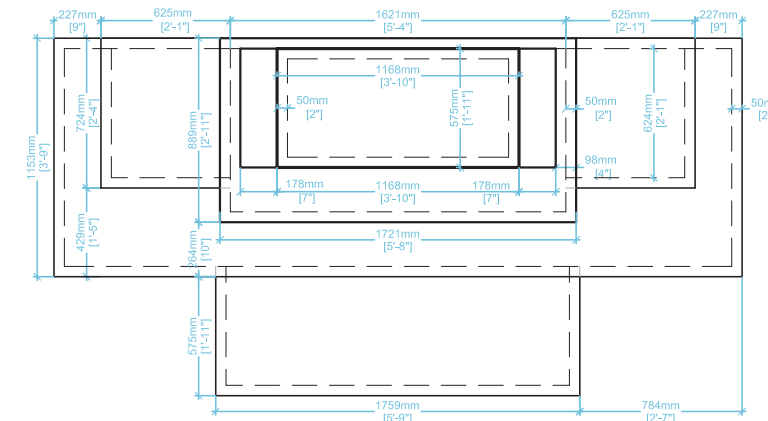

FRONT ELEVATION

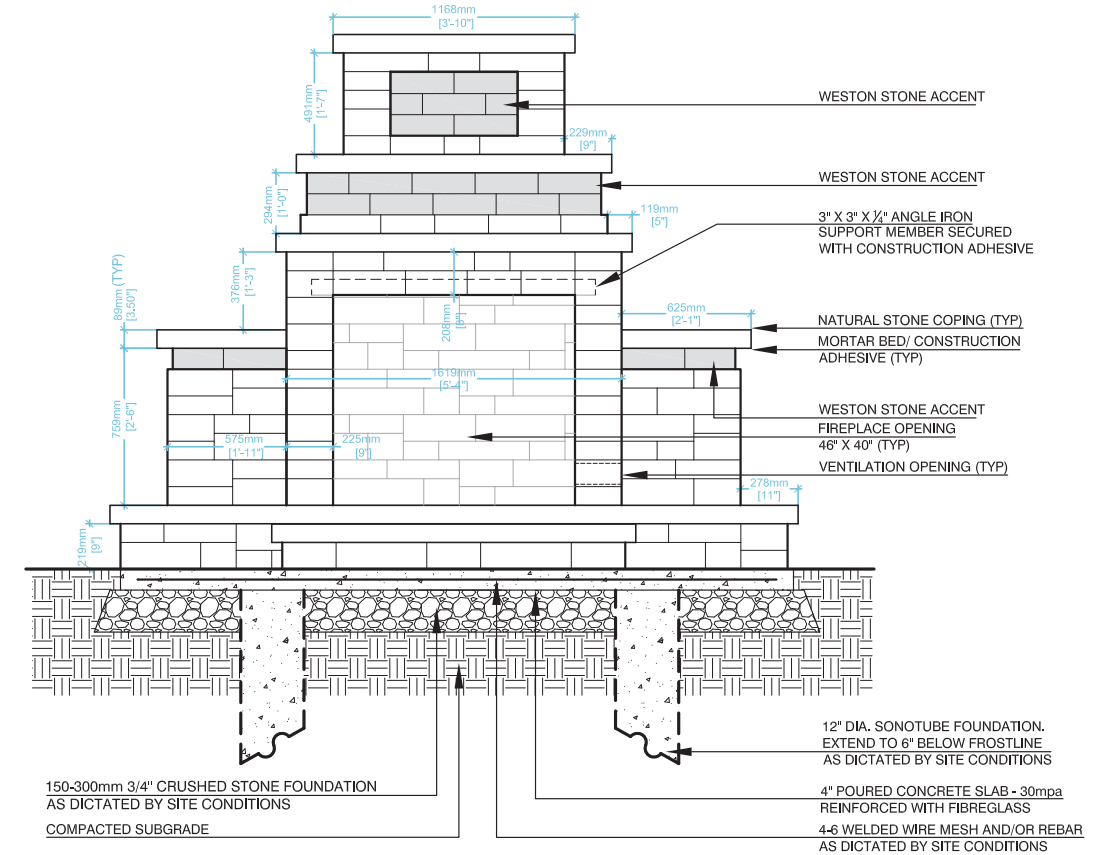

150-300mm 3/4\"/>

12\"/>

4\"/>

GENERAL NOTES:

- Built-in appliances vary in size. Refer to manufacturer's specifications for installation and dimensional requirements. Actual hardscaping dimensions may vary based on appliances used.
- Contractor to check that fireplace complies with all local bylaw and code requirements.
- All joints to be sealed with non-combustable material.



CAP UNIT

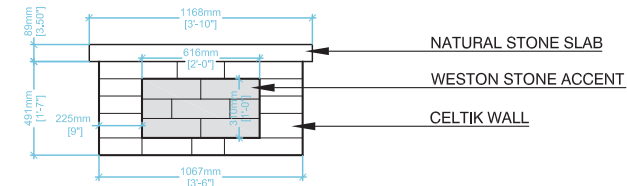

FRONT

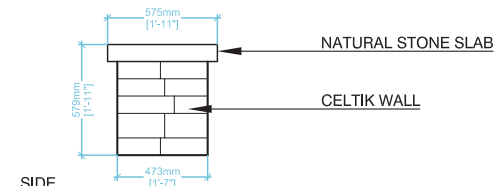

SIDE

MATERIALS LIST

CELTIK WALL - 1.33 m² / 14.36 ft²
 WESTON STONE ACCENT - 0.19 m² / 2.08 ft²
 NATURAL STONE COPING UNIT - 1168 mm (46") X 571 mm (22.5")

WING WALL UNIT

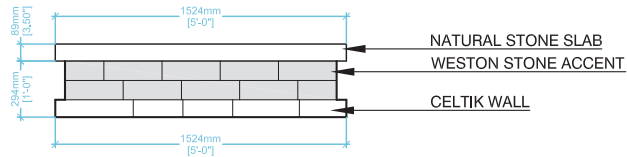

FRONT

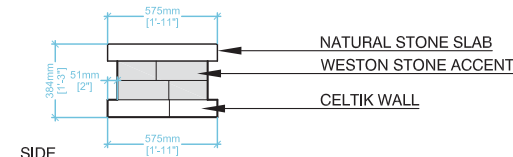

SIDE

CELTIK WALL - 0.37 m² / 3.95 ft²
 WESTON STONE ACCENT - 0.19 m² / 8.37 ft²
 NATURAL STONE COPING UNIT - 1524 mm (60") X 571 mm (22.5")



FIREPLACE UNIT

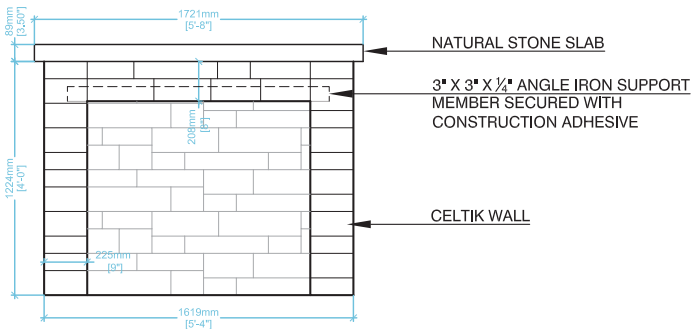

FRONT

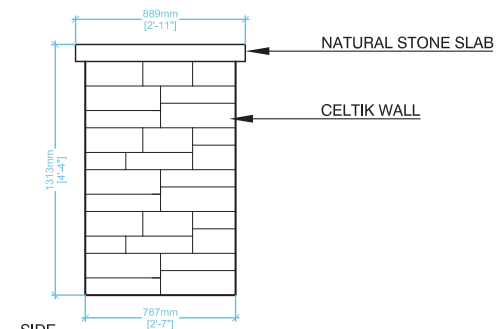

SIDE

CELTIK WALL - 4.66 m² / 50.2 ft²
 NATURAL STONE COPING UNIT - 1727 mm (68") X 889 mm (35")

BASE UNIT

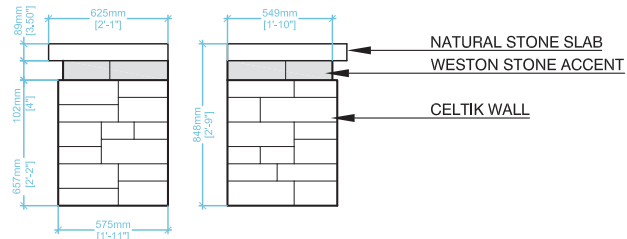

FRONT

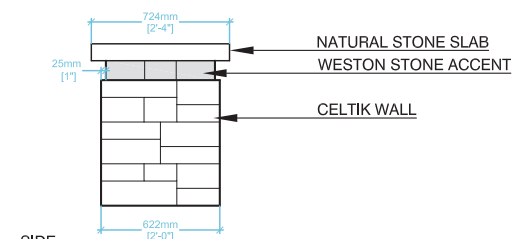

SIDE

CELTIK WALL - 1.18 m² / 12.67 ft²
 WESTON STONE ACCENT - 0.17 m² / 1.84 ft²
 NATURAL STONE COPING UNIT - 724 mm (28.5") X 635 mm (25")

NOTE:
 WING WALL QUANTITIES ARE FOR ONE SIDE ONLY



BASE UNIT

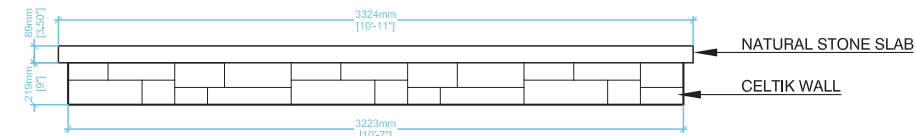

FRONT

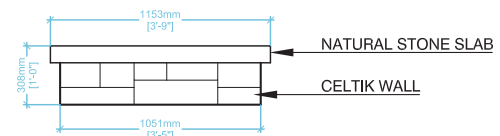

SIDE

CELTIK WALL - 1.18 m² / 12.7 ft²
 NATURAL STONE COPING UNIT - 3340 mm (131.5") X 1155 mm (45.5")

HEARTH UNIT

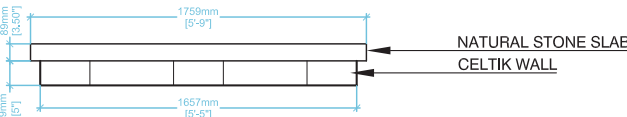

FRONT

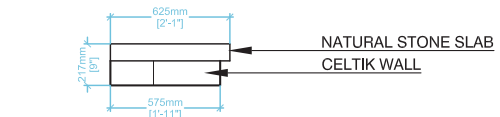

SIDE

CELTIK WALL - 0.25 m² / 2.71 ft²
 NATURAL STONE COPING UNIT - 1778 mm (70") X 635 mm (25")



CAP UNIT

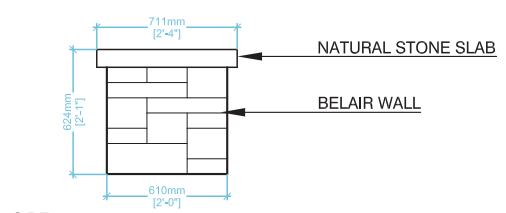
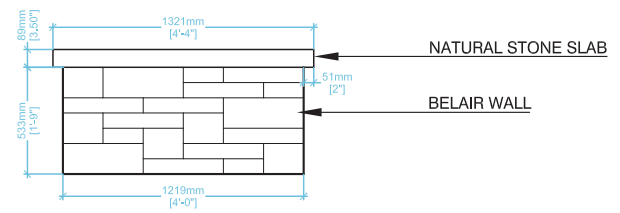

FRONT

SIDE

MATERIALS LIST

BELAIR WALL - 1.97m² / 21.25 ft²
 NATURAL STONE COPING UNIT - 1320 mm (52") X 711 mm (28")



FIREPLACE UNIT

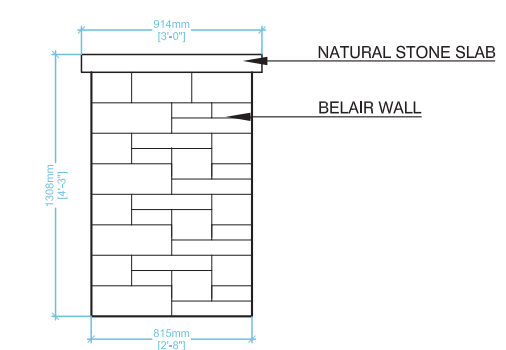
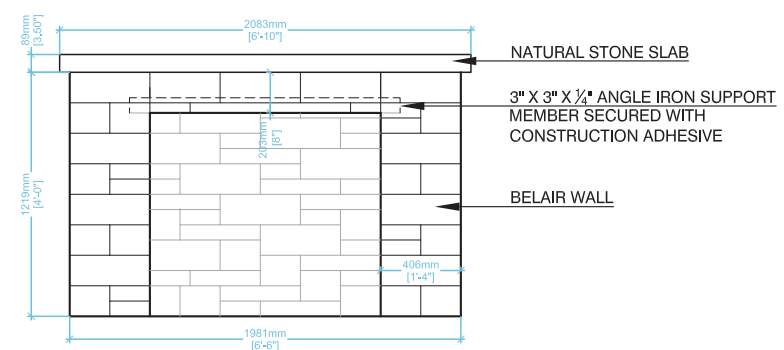

FRONT

SIDE

BELAIR WALL - 5.60 m² / 60.25 ft²
 NATURAL STONE COPING UNIT - 2083 mm (82") X 914 mm (36")

WING WALL UNIT

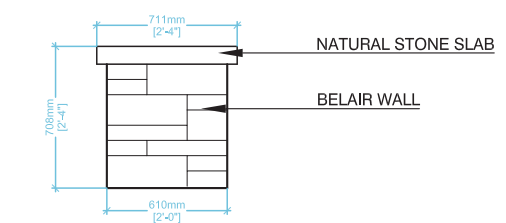
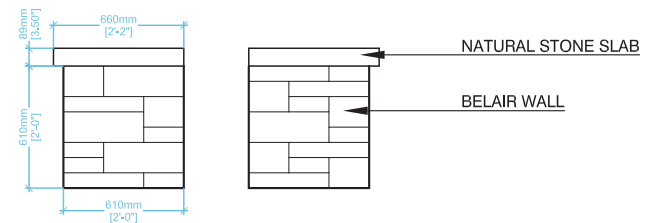

FRONT

SIDE

BELAIR WALL - 1.13 m² / 12.2 ft²
 NATURAL STONE COPING UNIT - 711 mm (28") X 660 mm (26")
 NOTE:
 WING WALL QUANTITIES ARE FOR ONE SIDE ONLY



BASE UNIT

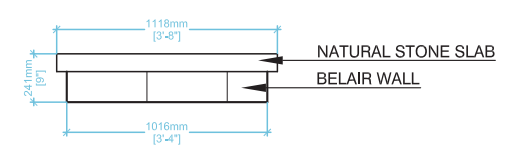
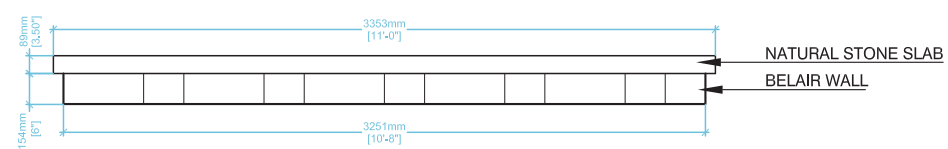

FRONT

SIDE

BELAIR WALL - 0.81 m² / 8.77 ft²
 NATURAL STONE COPING UNIT - 3378 mm (133") X 1117 mm (44")

HEARTH UNIT

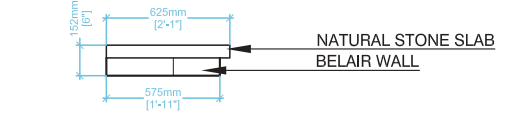
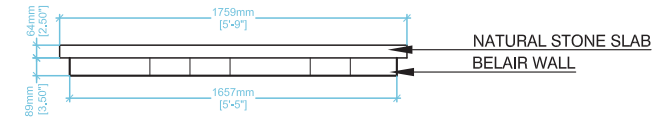

FRONT

SIDE

BELAIR WALL - 0.25 m² / 2.71 ft²
 NATURAL STONE COPING UNIT - 1753 mm (69") X 635 mm (25")





WESTON STONE KITCHEN | PRODUCT SUMMARY

The Weston Kitchen delivers all the tools for your outdoor cooking needs. The Weston Kitchen is designed to accommodate a 36" grill, mini-fridge and a 13" side burner. The 2 part modular design allows you to choose between Unit 'A' (the "cooking station") and/or Unit 'B' (wet bar/serving table).

WESTON STONE



MATERIAL LIST | SCHEDULE OF QUANTITIES

PRODUCT	QUANTITY
Weston Stone Wall	6.46 M ² / 69.5 Ft ²
Natural Stone Coping	1 Unit
(40" / 1016mm X 120" / 3050mm)	

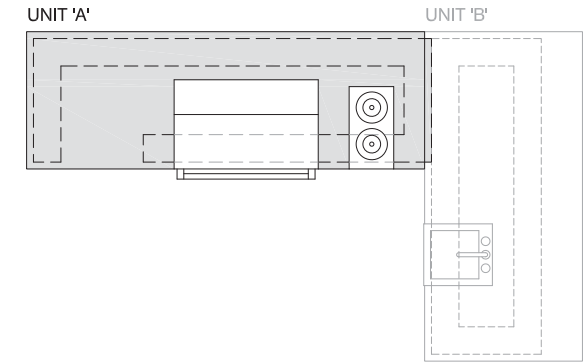
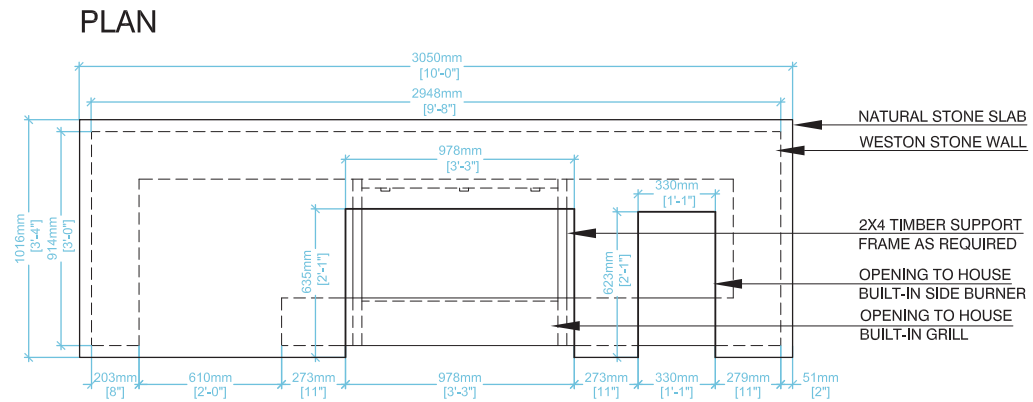

FRONT ELEVATION

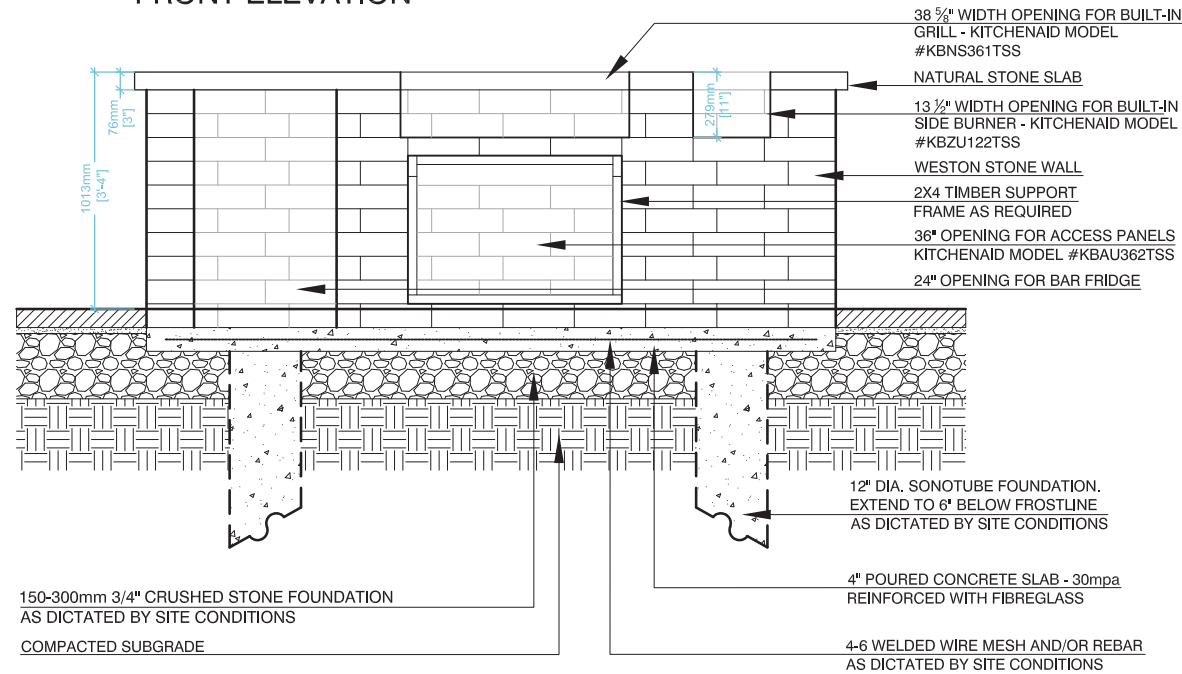

SIDE ELEVATION

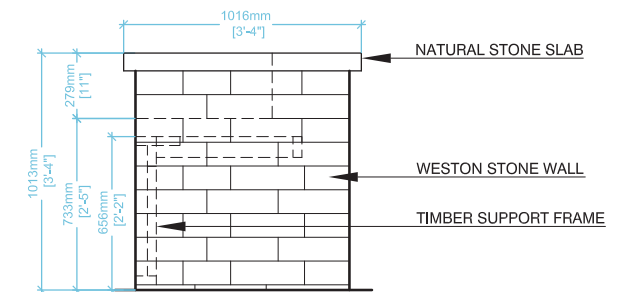

NOTE:
FOR ALTERNATIVE INSERTS REFER TO MANUFACTURER'S INSTALLATION INSTRUCTIONS

GENERAL NOTES:

1. Built-in appliances vary in size. Refer to manufacturer's specifications for installation and dimensional requirements. Actual hardscaping dimensions may vary based on appliances used.
2. Contractor to check that built-in grill complies with all local bylaw and code requirements.
3. All joints to be sealed with non-combustable material.



WESTON STONE BAR | PRODUCT SUMMARY

The Weston Bar is designed to house a built-in sink, and features a cantilevered counter top for bar stools. Due to its modular design, the Weston Bar can be a stand-alone unit, or can be integrated with the Weston Kitchen.

WESTON STONE

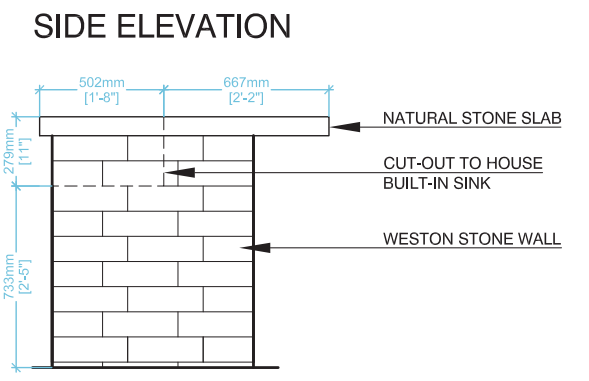
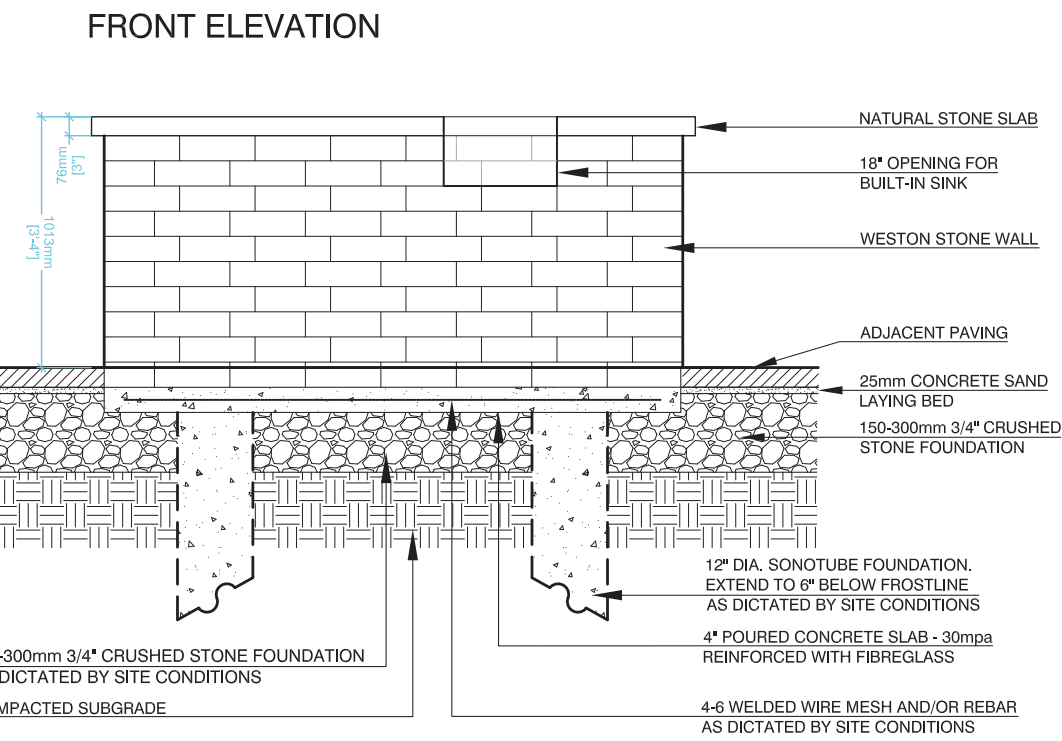
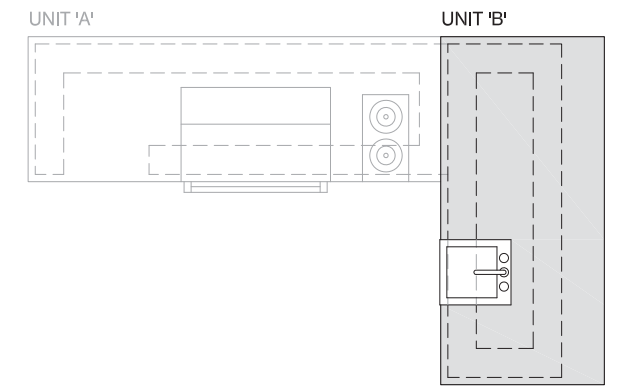
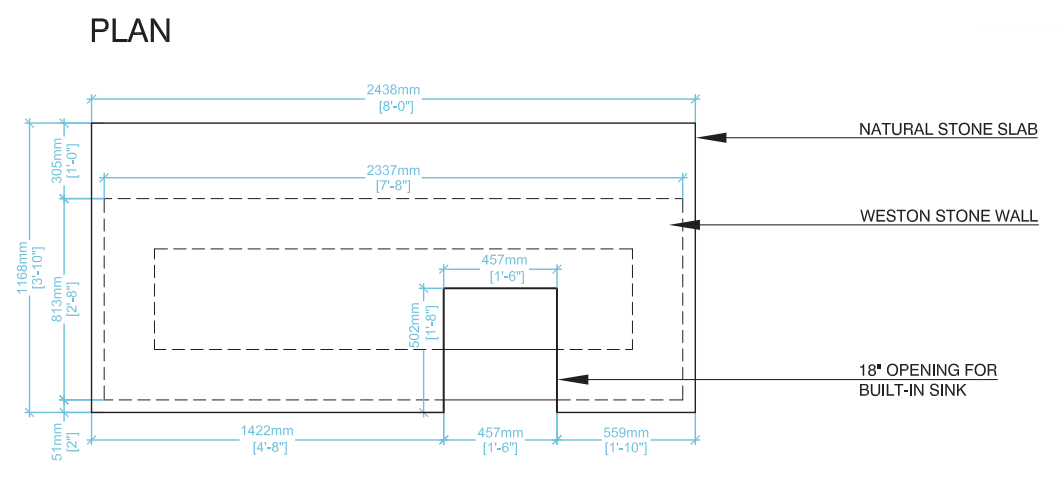

NOTE: FOR ALTERNATIVE INSERTS REFER TO MANUFACTURER'S INSTALLATION INSTRUCTIONS

MATERIAL LIST | SCHEDULE OF QUANTITIES

PRODUCT	QUANTITY
Weston Stone Wall	6.38M ² / 68.6 Ft ²
Natural Stone Coping (46" / 1168mm X 96" / 2438mm)	1 Unit

- GENERAL NOTES:**
1. Built-in appliances vary in size. Refer to manufacturer's specifications for installation and dimensional requirements. Actual hardscaping dimensions may vary based on appliances used.
 2. Contractor to check that built-in sink complies with all local bylaw and code requirements.
 3. All joints to be sealed with non-combustable material.



CELTIK KITCHEN | PRODUCT SUMMARY

The Celtik Kitchen delivers all the tools for your outdoor cooking needs. The Celtik Kitchen is designed to accommodate a 36" grill, mini-fridge and a 13" side burner. The 2 part modular design allows you to choose between Unit 'A' (the "cooking station") and/or Unit 'B' (wet bar/serving table),

CELTIK



MATERIAL LIST | SCHEDULE OF QUANTITIES

PRODUCT	QUANTITY
Celtik Wall	6.5 M ² / 69.9 Ft ²
Natural Stone Coping (39" / 984mm X 128" / 3248mm)	1 Unit

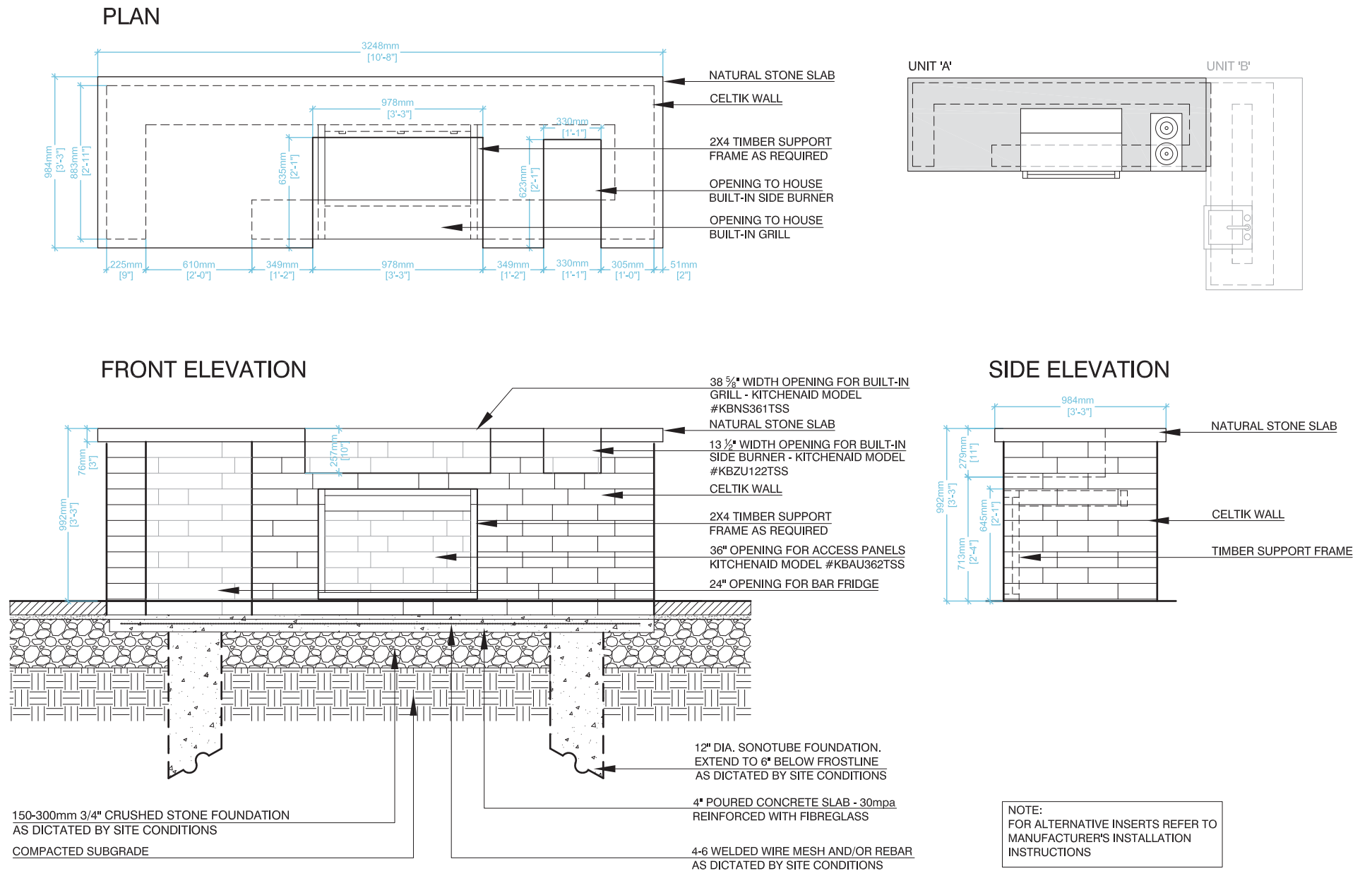

NOTE:
FOR ALTERNATIVE INSERTS REFER TO
MANUFACTURER'S INSTALLATION
INSTRUCTIONS

GENERAL NOTES:

- Built-in appliances vary in size. Refer to manufacturer's specifications for installation and dimensional requirements. Actual hardscaping dimensions may vary based on appliances used.
- Contractor to check that built-in grill complies with all local bylaw and code requirements.
- All joints to be sealed with non-combustable material.



CELTIK BAR | PRODUCT SUMMARY

The Celtik Bar is designed to house a built-in sink, and features a cantilevered counter top for bar stools. Due to its modular design, the Celtik Bar can be a stand-alone unit, or can be integrated with the Celtik Kitchen.

CELTIK



MATERIAL LIST | SCHEDULE OF QUANTITIES

PRODUCT	QUANTITY
Celtik Wall	5.5 M ² / 59.6 Ft ²
Natural Stone Coping (40" / 1016mm X 88" / 2236mm)	1 Unit

PLAN

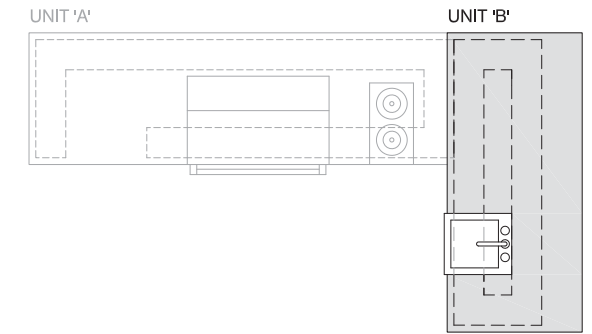
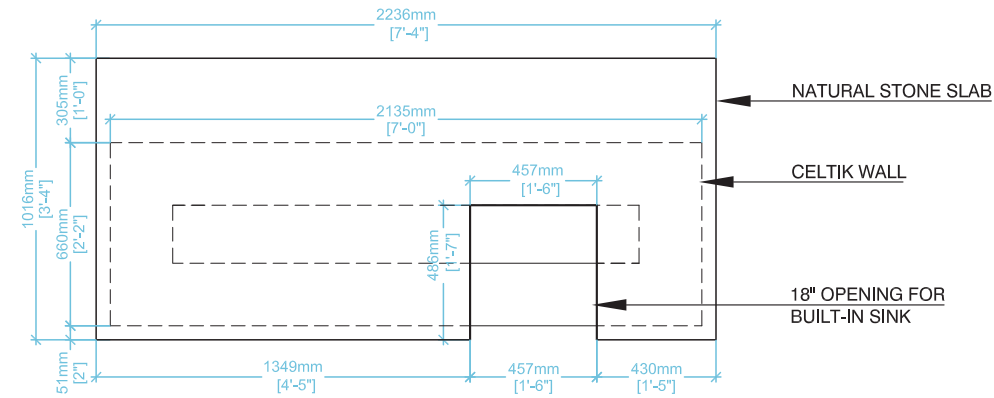

FRONT ELEVATION

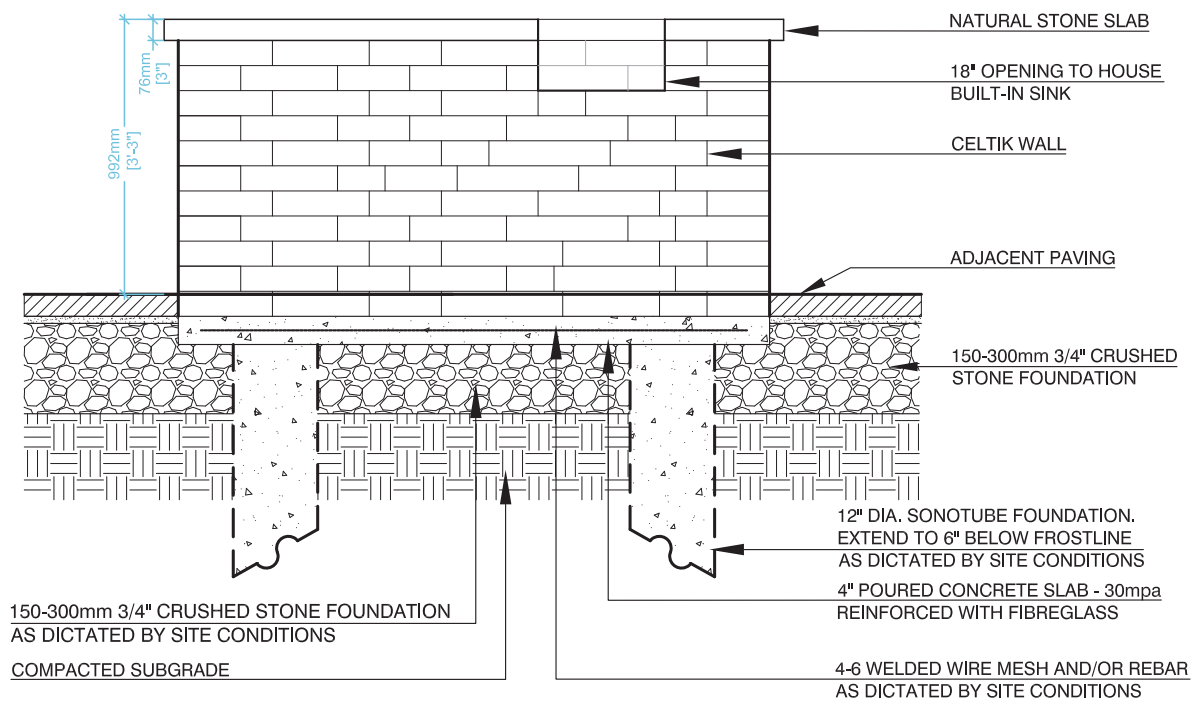

SIDE ELEVATION

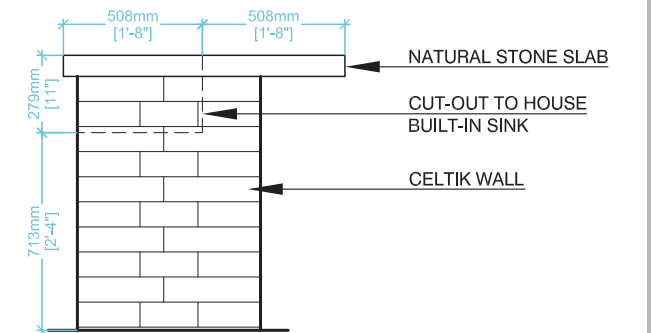

NOTE:
FOR ALTERNATIVE INSERTS REFER TO
MANUFACTURER'S INSTALLATION
INSTRUCTIONS

GENERAL NOTES:

1. Built-in appliances vary in size. Refer to manufacturer's specifications for installation and dimensional requirements. Actual hardscaping dimensions may vary based on appliances used.
2. Contractor to check that built-in sink complies with all local bylaw and code requirements.
3. All joints to be sealed with non-combustable material.





BELAIR WALL KITCHEN | PRODUCT SUMMARY

The BelAir Kitchen delivers all the tools for your outdoor cooking needs. The BelAir Kitchen is designed to accommodate a 36" grill, mini-fridge and a 13" side burner. The curvilinear design is well suited for a more organic, free flowing landscape.

BELAIR WALL



Colors vary by region.

MATERIAL LIST | SCHEDULE OF QUANTITIES

PRODUCT	QUANTITY
BelAir Wall	11.49 M ² / 123.6 Ft ²
Natural Stone Coping (40" / 1016mm X 240" / 6213 mm Inside Radius, 278" / 7058 mm Outside Radius)	

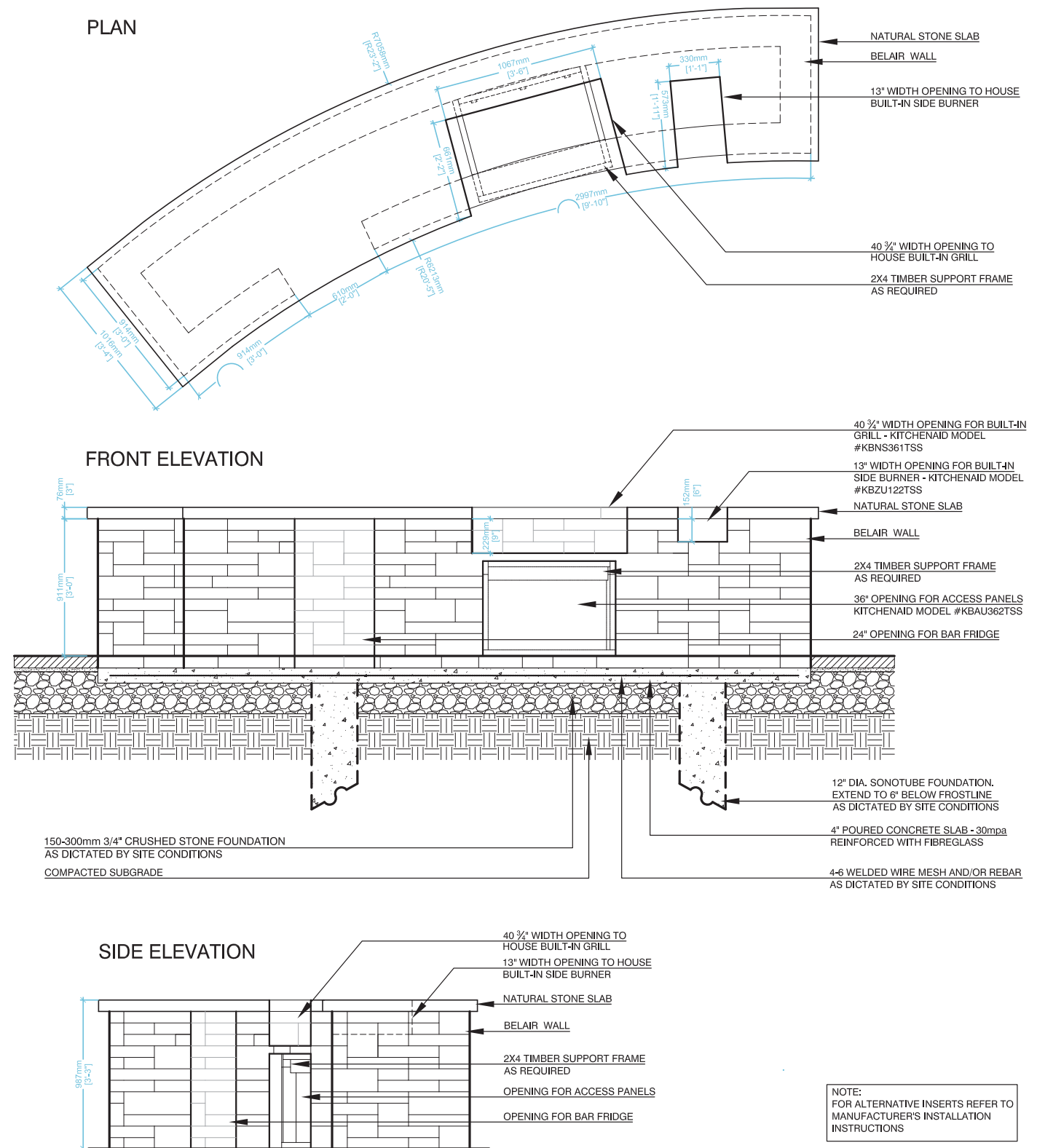

GENERAL NOTES:

- Built-in appliances vary in size. Refer to manufacturer's specifications for installation and dimensional requirements. Actual hardscaping dimensions may vary based on appliances used.
- Contractor to check that built-in grill complies with all local bylaw and code requirements.
- All joints to be sealed with non-combustable material.



WESTON STONE COLUMN COUNTER | PRODUCT SUMMARY

Similar to the Weston Bar, the Weston Column Counter has a cantilevered counter top for dining or lounging. Without a sink, the Weston Column Counter is a great serving table or prep-station for outdoor gatherings.

WESTON STONE



MATERIAL LIST | SCHEDULE OF QUANTITIES

PRODUCT	QUANTITY
Weston Stone Wall	3.1 M ² / 32 Ft ²
Natural Stone Counter (96" / 2436mm X 46" / 1168 mm)	1 Unit

PLAN

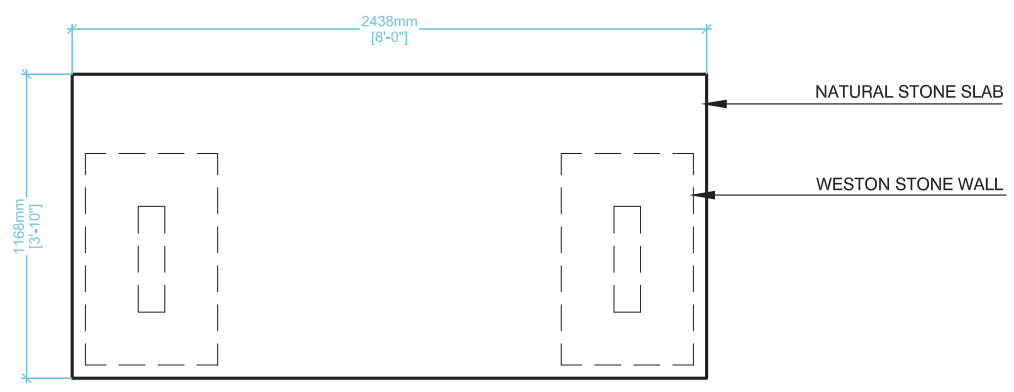

FRONT ELEVATION

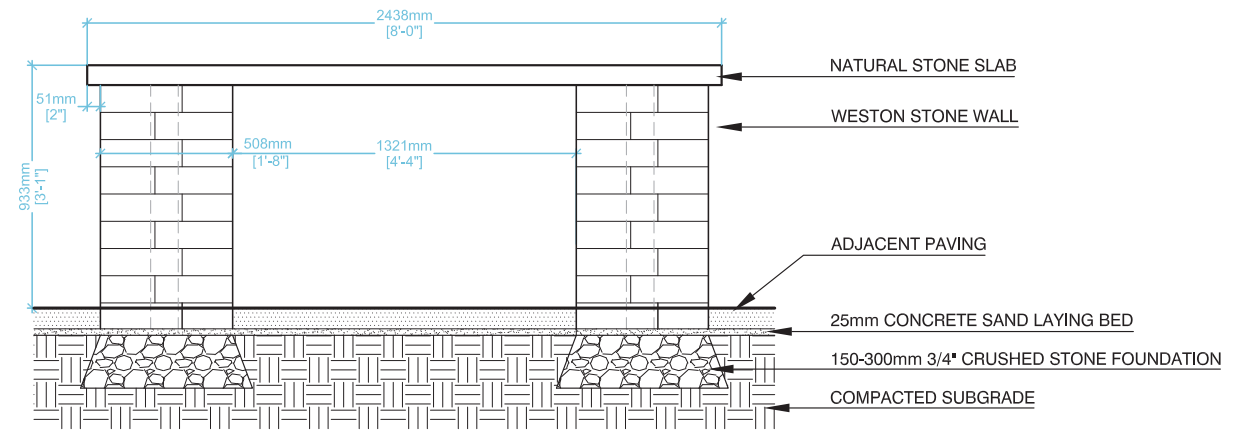

SIDE ELEVATION

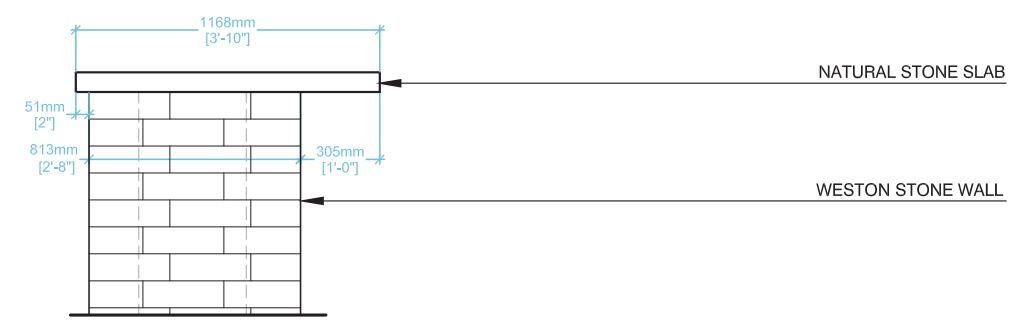



CELTIK COLUMN COUNTER | PRODUCT SUMMARY

Similar to the Celtik Bar, the Celtik Column Counter has a cantilevered counter top for dining or lounging. Without a sink, the Celtik Column Counter is a great serving table or prep-station for outdoor gatherings.

CELTIK



MATERIAL LIST | SCHEDULE OF QUANTITIES

PRODUCT	QUANTITY
Celtik Wall	2.06 M ² / 22.2 Ft ²
Natural Stone Counter (88" / 2236mm X 40" / 1016mm)	

PLAN

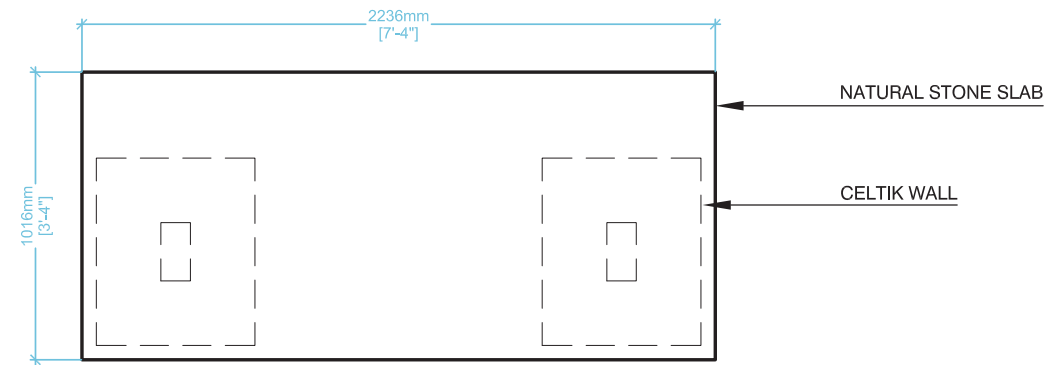

FRONT ELEVATION

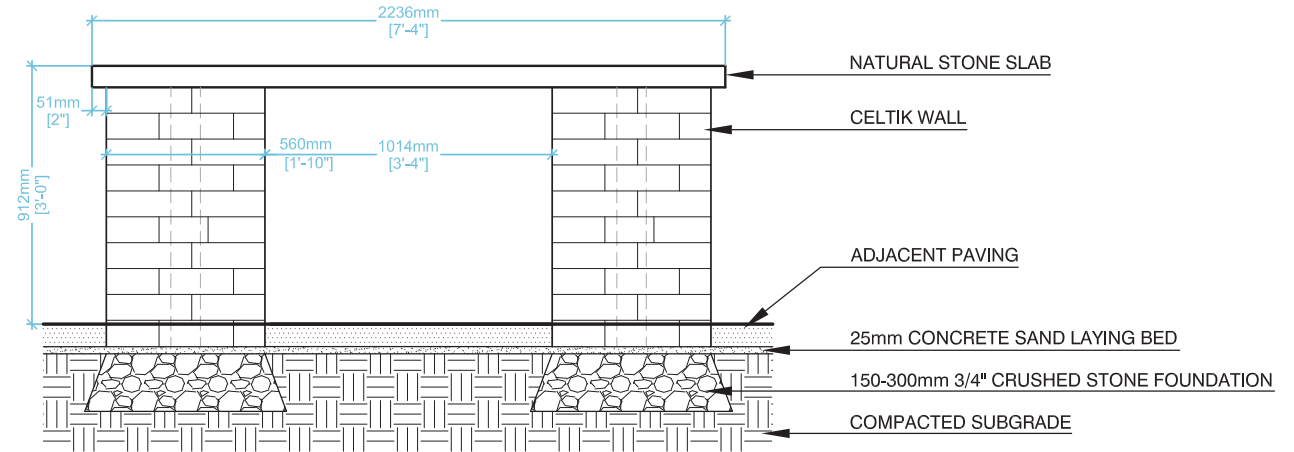

SIDE ELEVATION

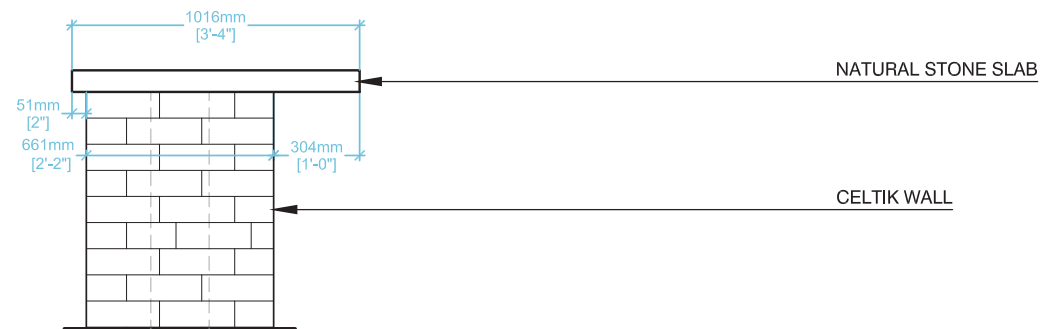



CELTIK RECESSED CIRCULAR FIREPIT | PRODUCT SUMMARY

The Celtik Fire Pit is a recessed circular unit, coming complete with Celtik Wall, apron pavers, and steel insert sheild. Be sure to check with all city by-laws for outdoor fire requirements.

CELTIK



RED

CELTIK



BEIGE AND BLACK

MATERIAL LIST | SCHEDULE OF QUANTITIES

PRODUCT	QUANTITY
Celtik Wall	1.54 M ² / 16.6 Ft ²
Celtik Bevelled Capping Module	4.78 Lin.M / 15.6 Lin. Ft.
Mega-Bergerac Plus Circle Pavers	7 M ² / 75 Ft ²

PLAN

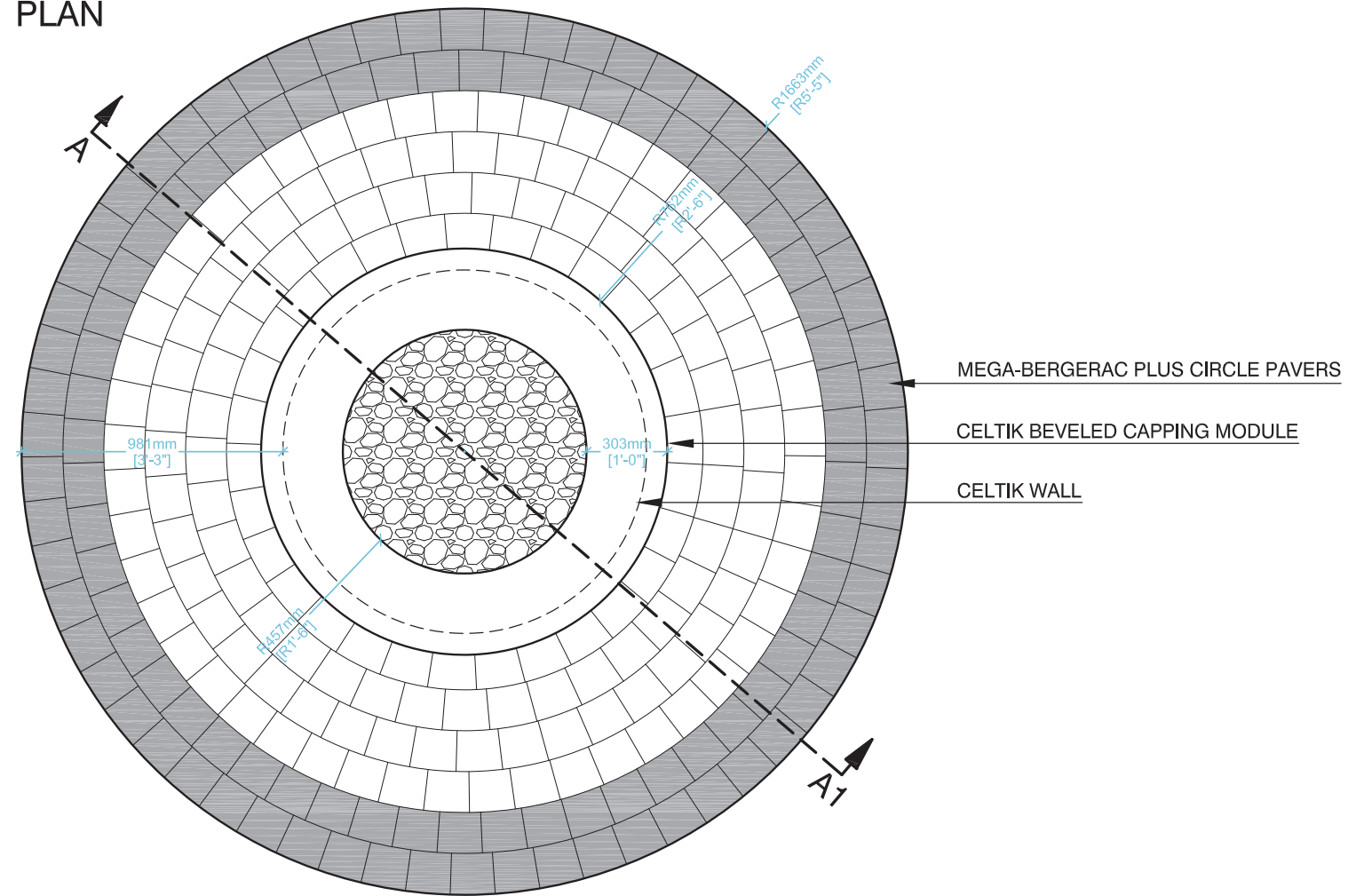

CROSS SECTION: A-A1

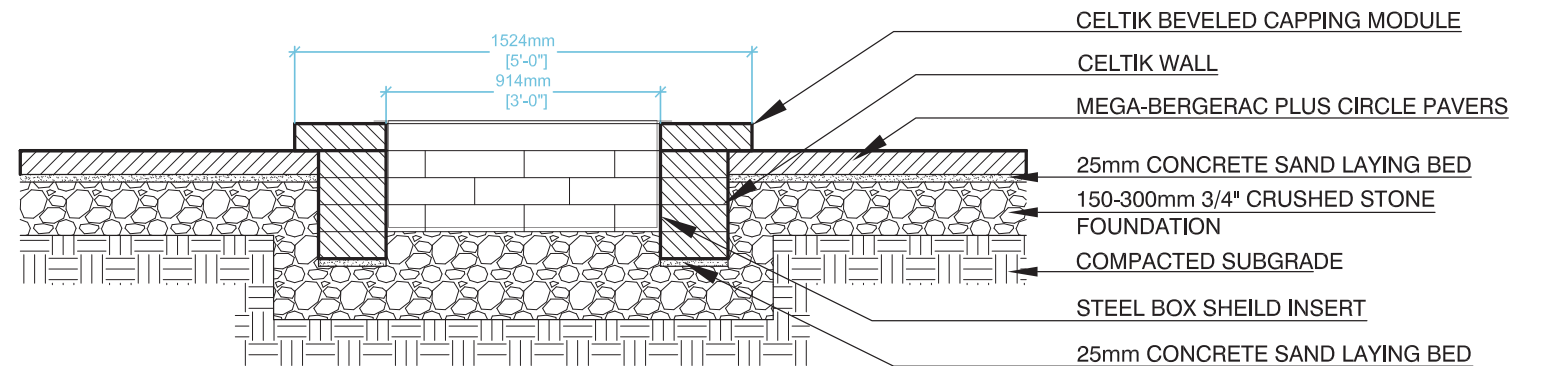



CELTIK RAISED CIRCULAR FIRE PIT | PRODUCT SUMMARY

The Celtik Raised Fire Pit has all the same characteristics as the recessed unit, only it is above grade. Coming complete with Celtik Wall, pavers, and a steel insert sheild. Be sure to check with all city by-laws for outdoor fire requirements.

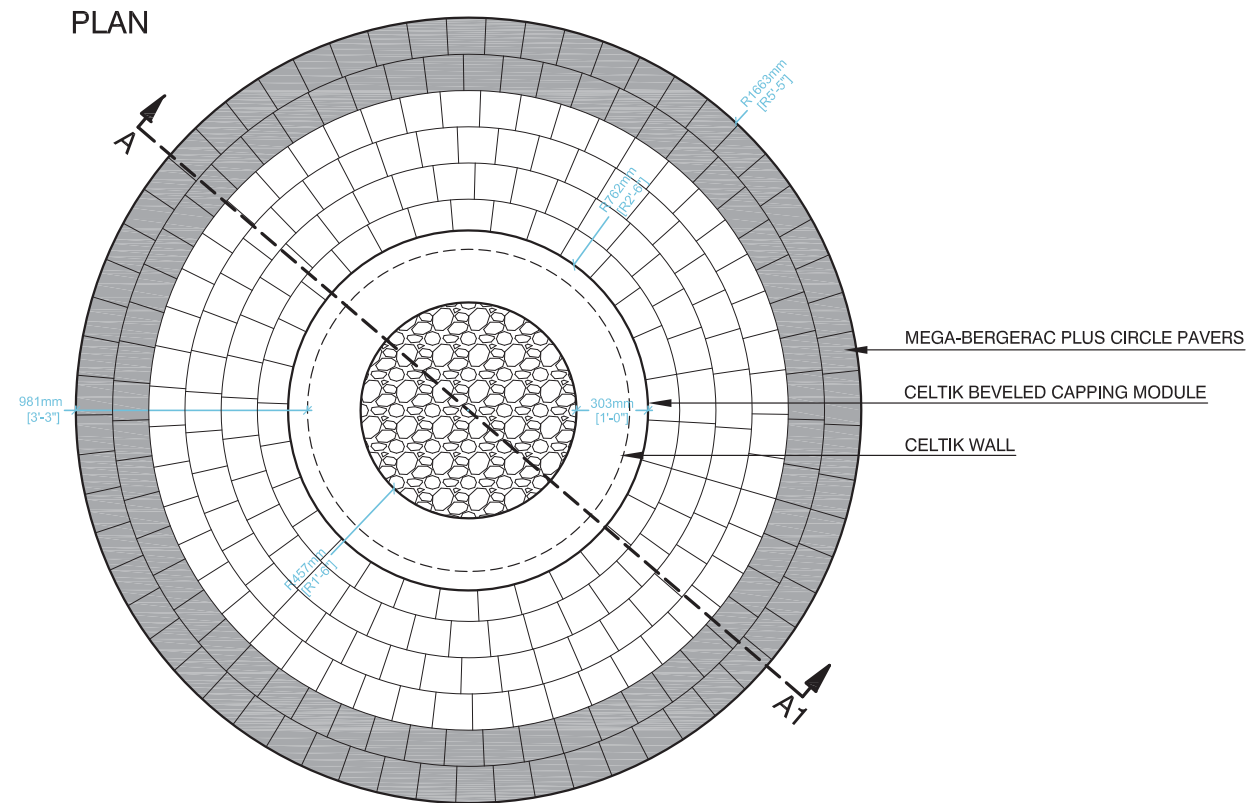

ELEVATION

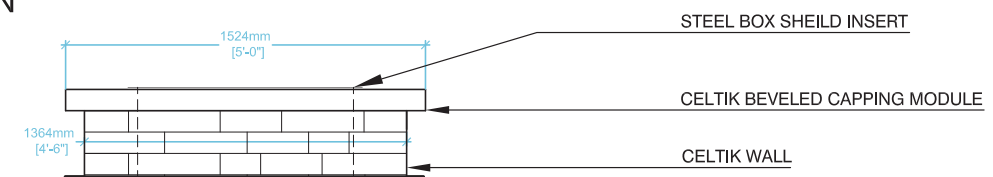

CROSS SECTION: A-A1

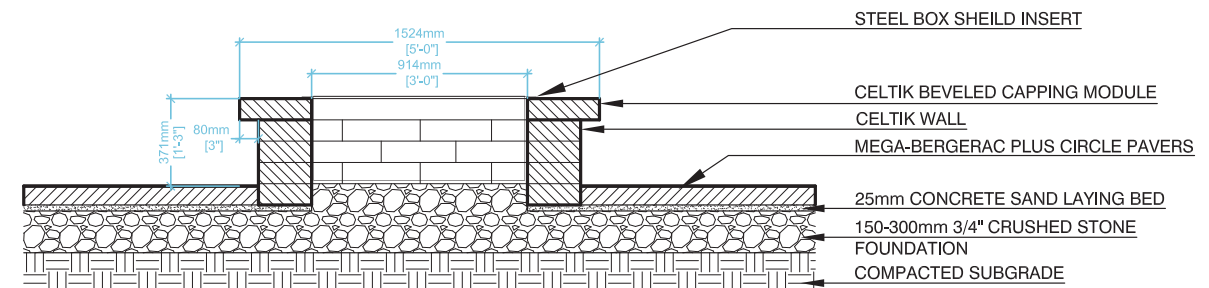

CELTIK



MATERIAL LIST | SCHEDULE OF QUANTITIES

PRODUCT	QUANTITY
Celtik Wall	1.54 M ² / 16.6 Ft ²
Celtik Bevelled Capping Module	4.78 Lin.M / 15.6 Lin. Ft.
Mega-Bergerac Plus Circle Pavers	7 M ² / 75 Ft ²



WESTON STONE WATER FEATURE | PRODUCT SUMMARY

The Weston Stone Water Feature is a 2-tier structure, which recycles water from the bottom basin back to the top. A stainless steel spill trough creates the gateway for water overflow. Water pump, piping, membrane and insulation are the responsibility of the contractor.

WESTON STONE



GREY

OLD WORLD PAVER



BEIGE

WESTON STONE



BEIGE AND BLACK

OLD WORLD PAVER



GREY

MATERIAL LIST | SCHEDULE OF QUANTITIES

PRODUCT	QUANTITY
Weston Stone Wall	8.27 M ² / 89 Ft ²
Old World Paver	1.23 M ² / 13.2 Ft ²
Celtik Straight Capping Module	11.42 Lin. M / 37.3 Lin Ft.

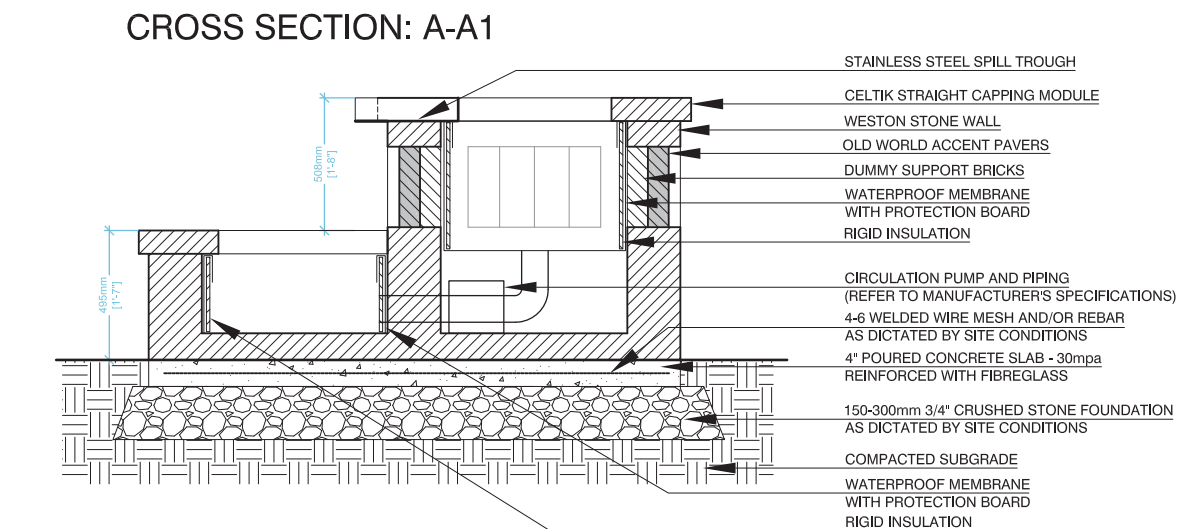
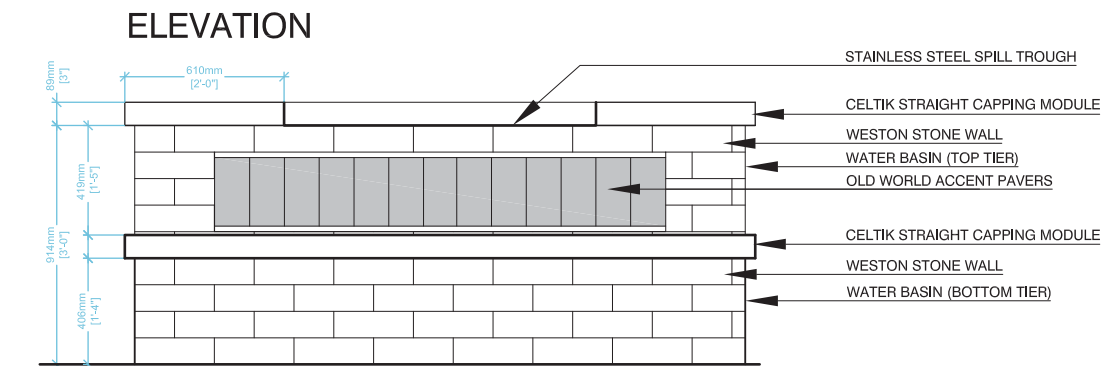
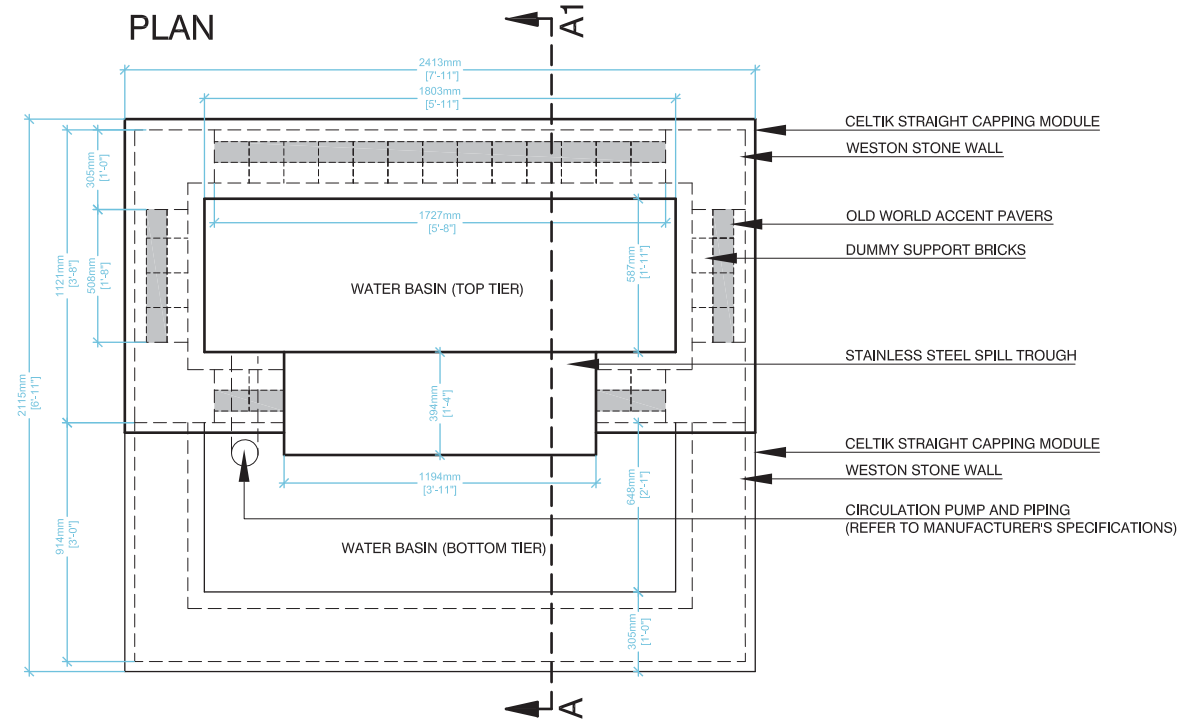



WESTON STONE WATER FEATURE WITH BUBBLER | PRODUCT SUMMARY

The Weston Stone Bubbler is a single basin structure, spraying water upward at a constant rate. Water pump, piping, membrane and insulation are the responsibility of the contractor.

WESTON STONE



BEIGE AND BLACK

OLD WORLD PAVER



GREY

WESTON STONE



CHARCOAL

OLD WORLD PAVER



GREY

MATERIAL LIST | SCHEDULE OF QUANTITIES

PRODUCT	QUANTITY
Weston Stone Wall	4.08 M ² / 43.9 Ft ²
Old World Pavers	1.23 M ² / 13.2 Ft ²
Celtik Straight Capping Module	7.22 Lin. M / 23.6 Lin Ft.

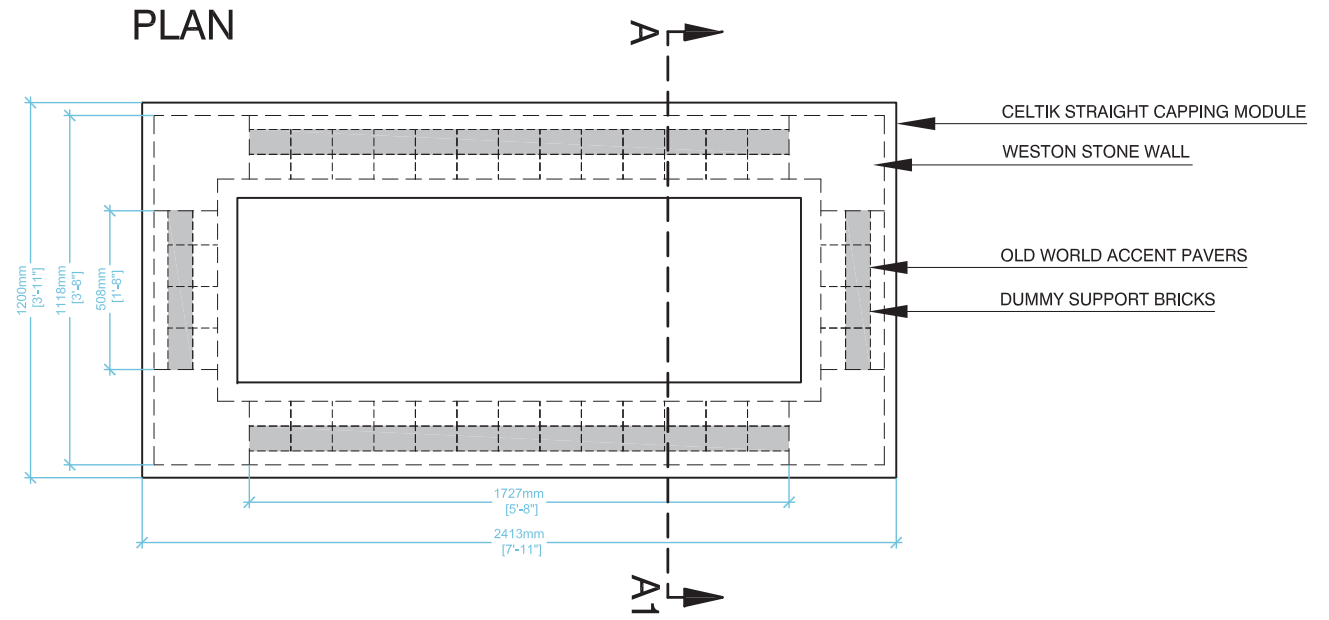

ELEVATION

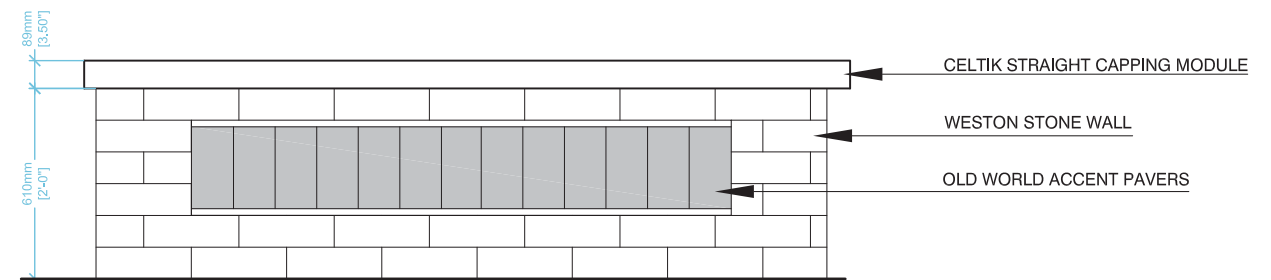

CROSS SECTION: A-A1

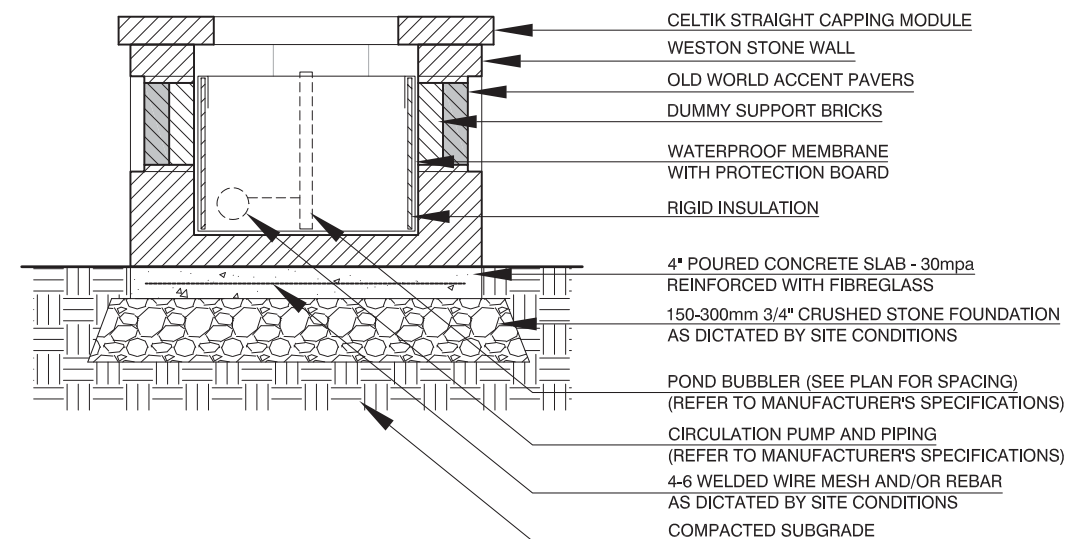



WESTON STONE RECTILINEAR PLANTER | PRODUCT SUMMARY

The Weston Stone Rectilinear Planter is great as a seatwall, or divider of outdoor space. Filter Fabric, protection board and insulation are the responsibility of the contractor.

WESTON STONE



CHARCOAL

OLD WORLD PAVER



BEIGE

WESTON STONE



BEIGE AND BLACK

OLD WORLD PAVER



GREY

MATERIAL LIST | SCHEDULE OF QUANTITIES

PRODUCT	QUANTITY
Weston Stone Wall	3.59 M ² / 38.6 Ft ²
Old World Pavers	1.23 M ² / 13.2 Ft ²
Celtik Straight Capping Module	7.22 Lin. M / 23.6 Lin Ft.

PLAN

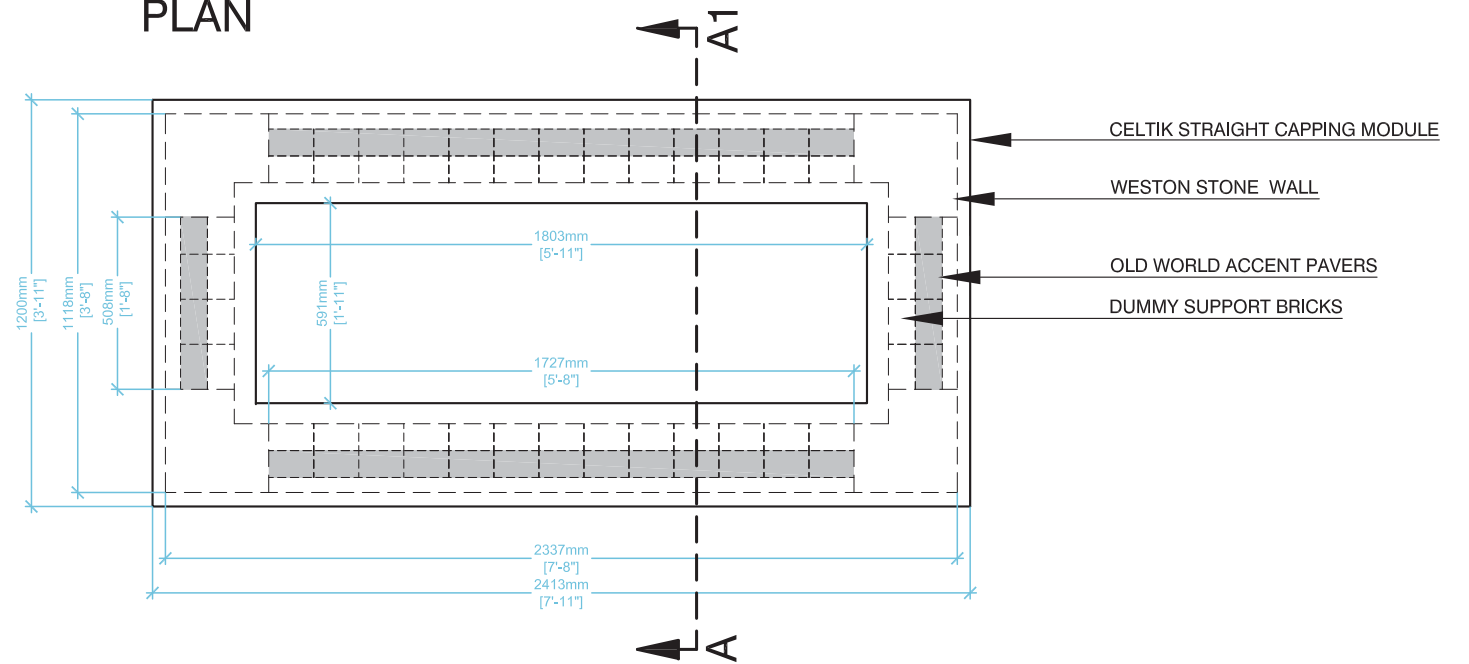

ELEVATION

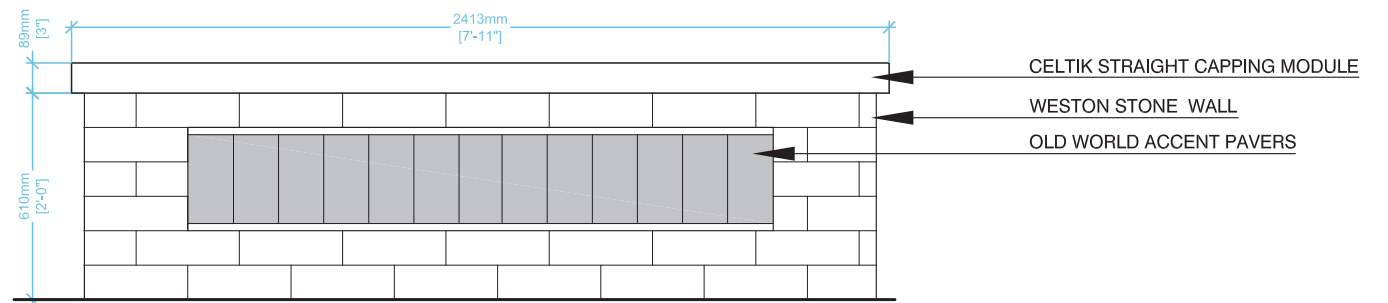

CROSS SECTION: A-A1

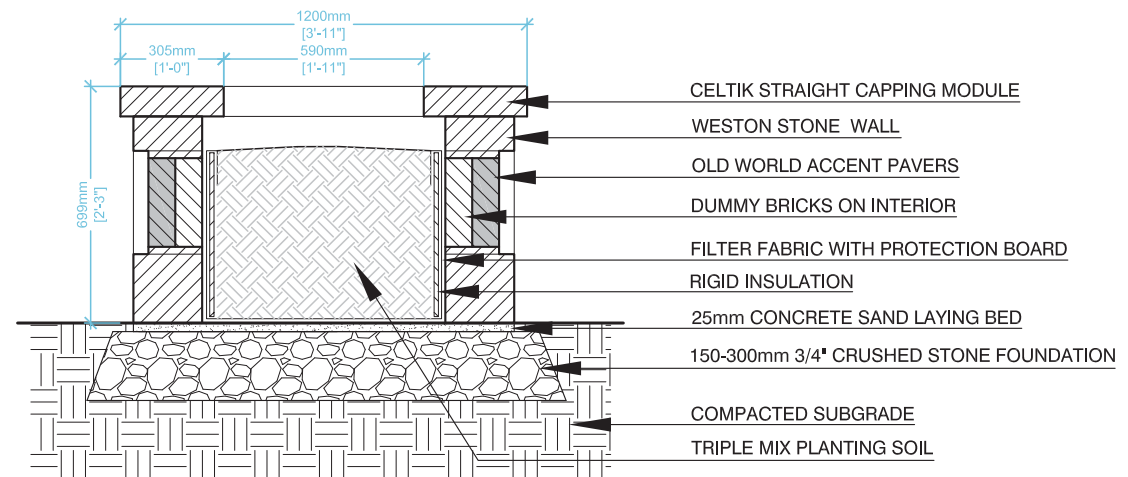



WESTON STONE SQUARE PLANTER | PRODUCT SUMMARY

The Weston Stone Square Planter is a simplified version of our Weston Stone Rectilinear Planter. Filter Fabric, protection board and insulation are the responsibility of the contractor.

WESTON STONE



GREY

WESTON STONE



BEIGE AND BLACK

MATERIAL LIST | SCHEDULE OF QUANTITIES

PRODUCT	QUANTITY
Weston Stone Wall	3.77 M ² / 40.5 Ft ²

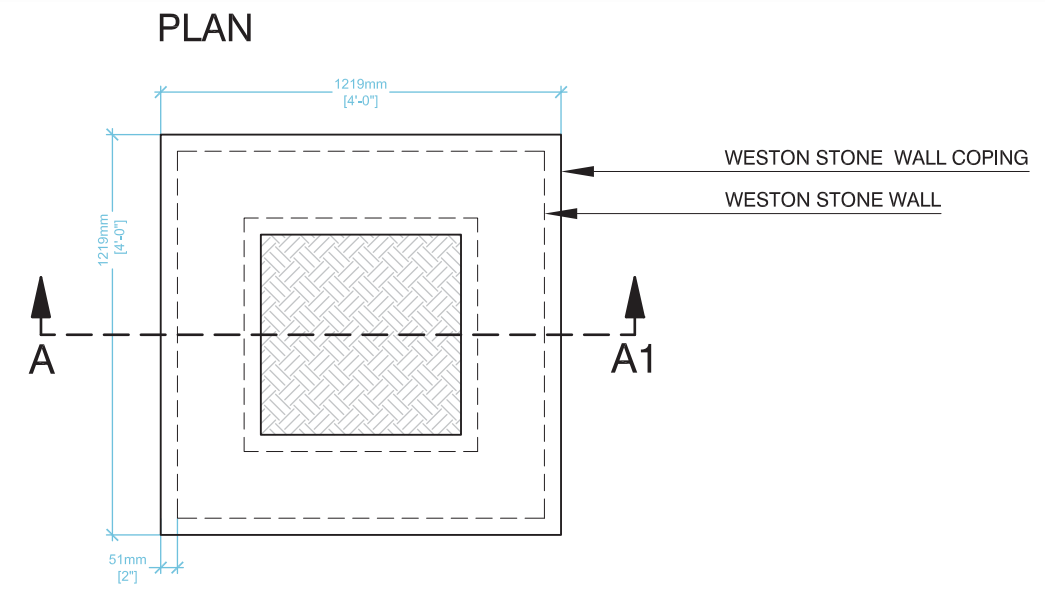

ELEVATION

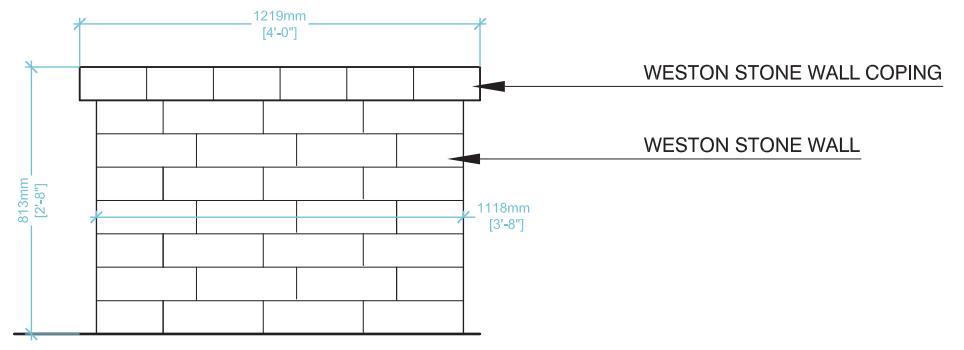

CROSS SECTION: A-A1

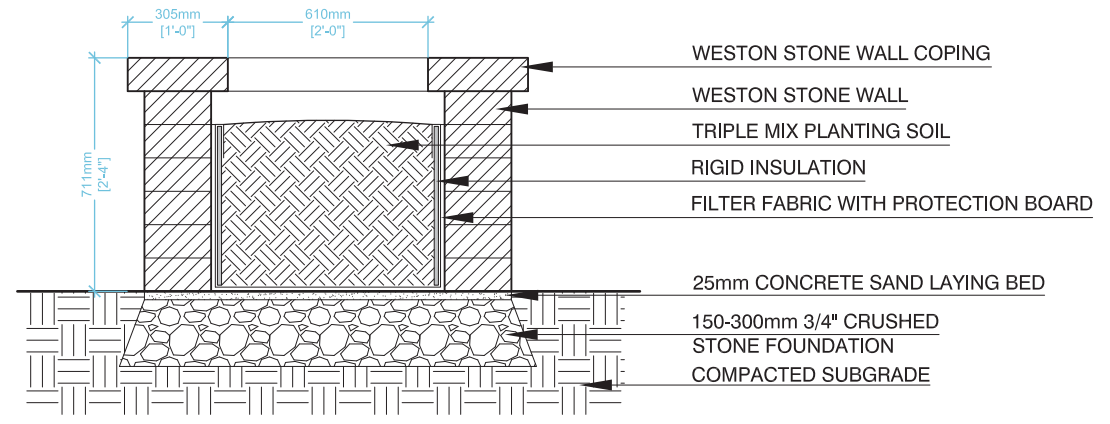



MONACO ARBOR | PRODUCT SUMMARY

The Weston Stone Arbor is a great focal point to any walkway. Whether gated or open, this structure helps to define your outdoor space. Lumber for the Weston Arbor is the responsibility of the contractor.

WESTON STONE



BEIGE AND BLACK

CELTIK



CHARCOAL

WESTON STONE



GREY

CELTIK



RED

MATERIAL LIST | SCHEDULE OF QUANTITIES

PRODUCT	QUANTITY
Weston StoneWall	3 M ² / 32.5 Ft ²
Celtik Wall Accent	0.22 M ² / 2.38 Ft ²
Natural Stone Coping	2 Units (24" X 24" / 610mm x 610mm each)

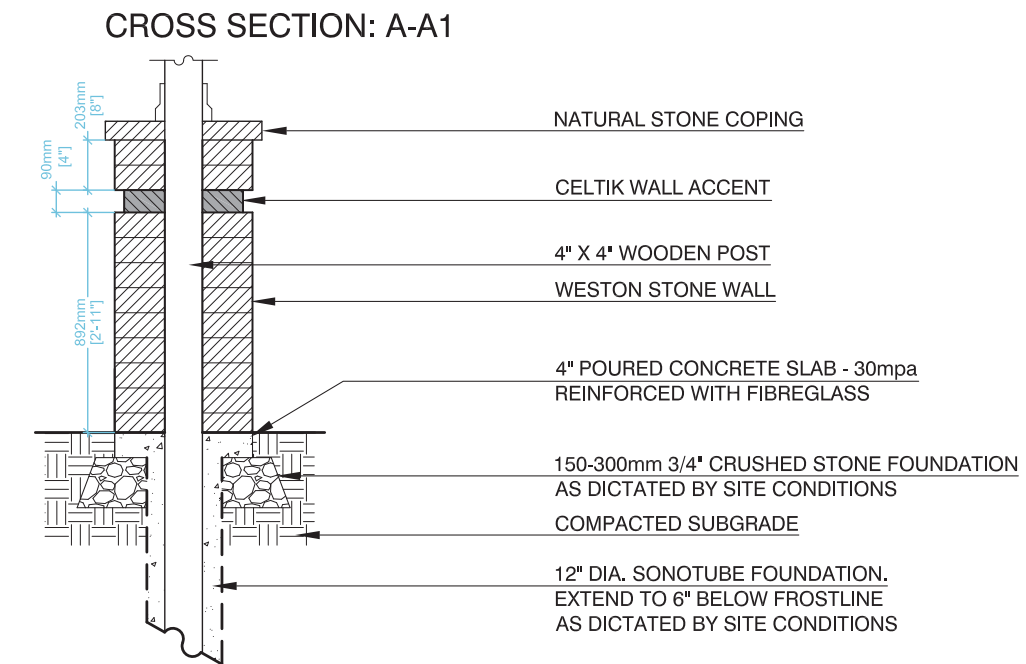
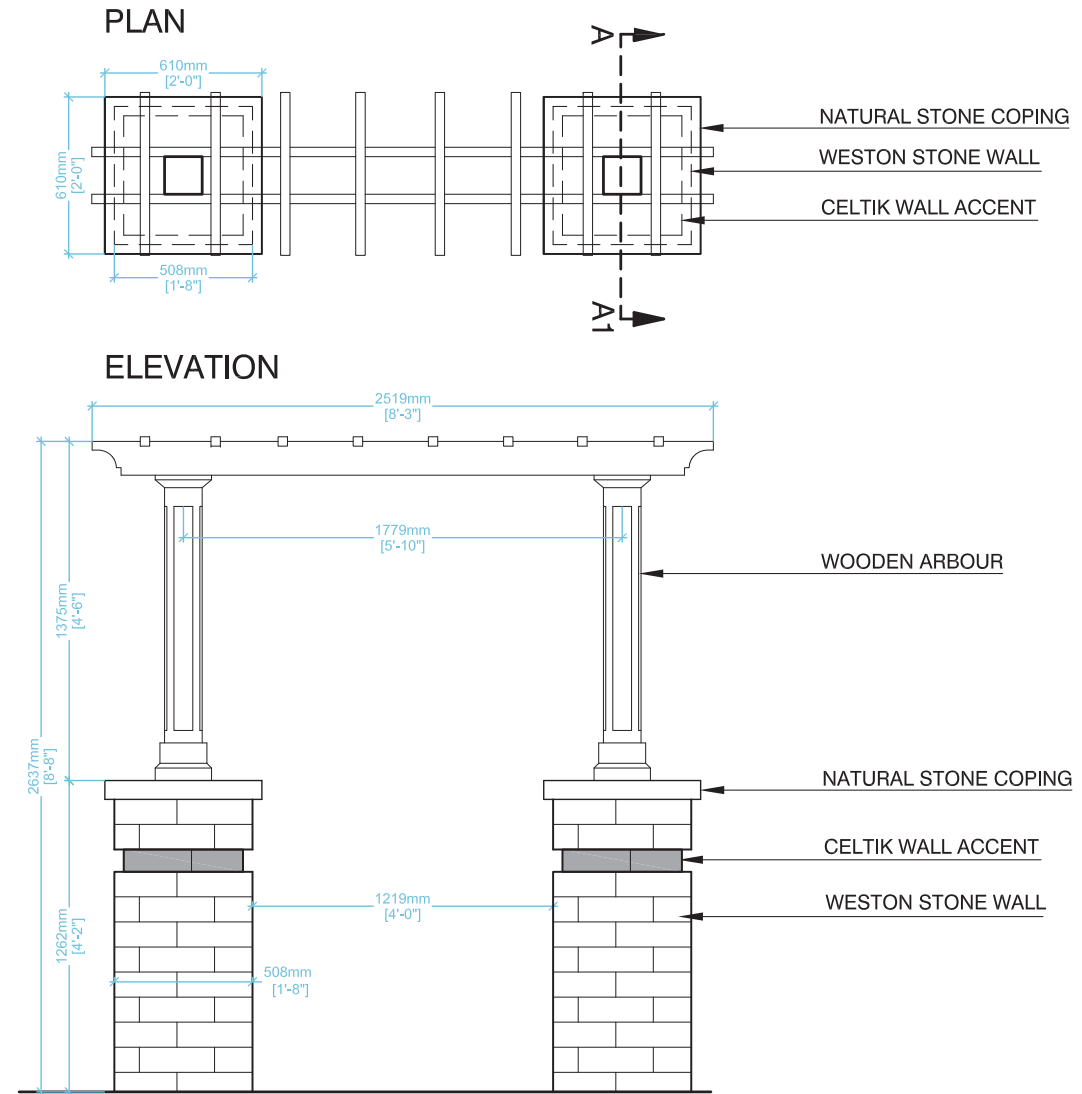



WESTON STONE ARBOR | PRODUCT SUMMARY

The Weston Stone Arbor is a great focal point to any walkway. Whether gated or open, this structure helps to define your outdoor space. Lumber for the Weston Arbor is the responsibility of the contractor.

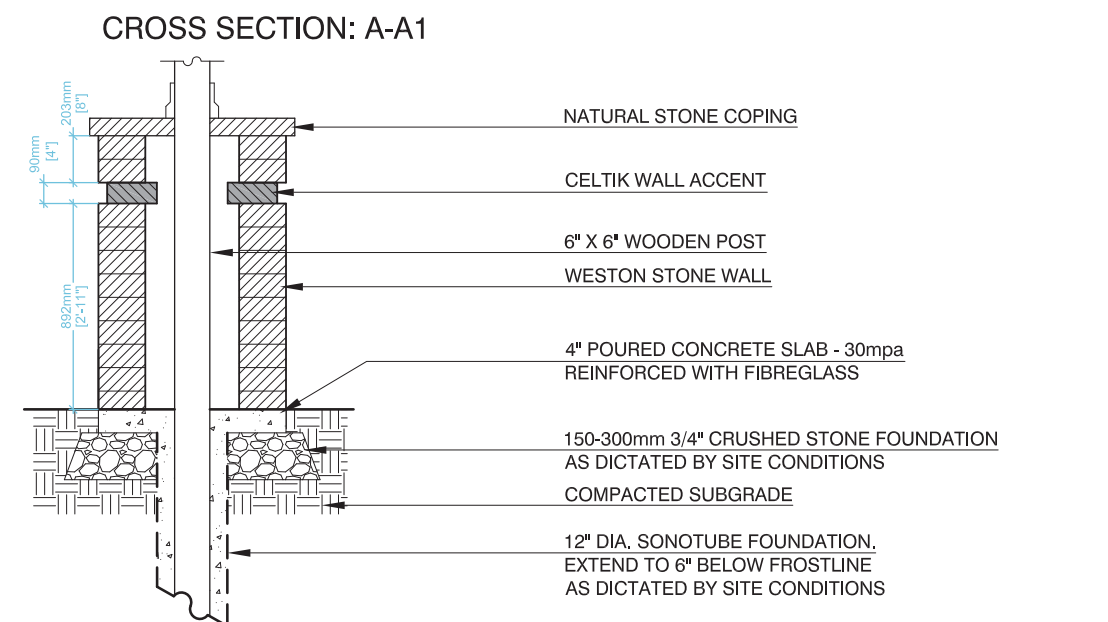
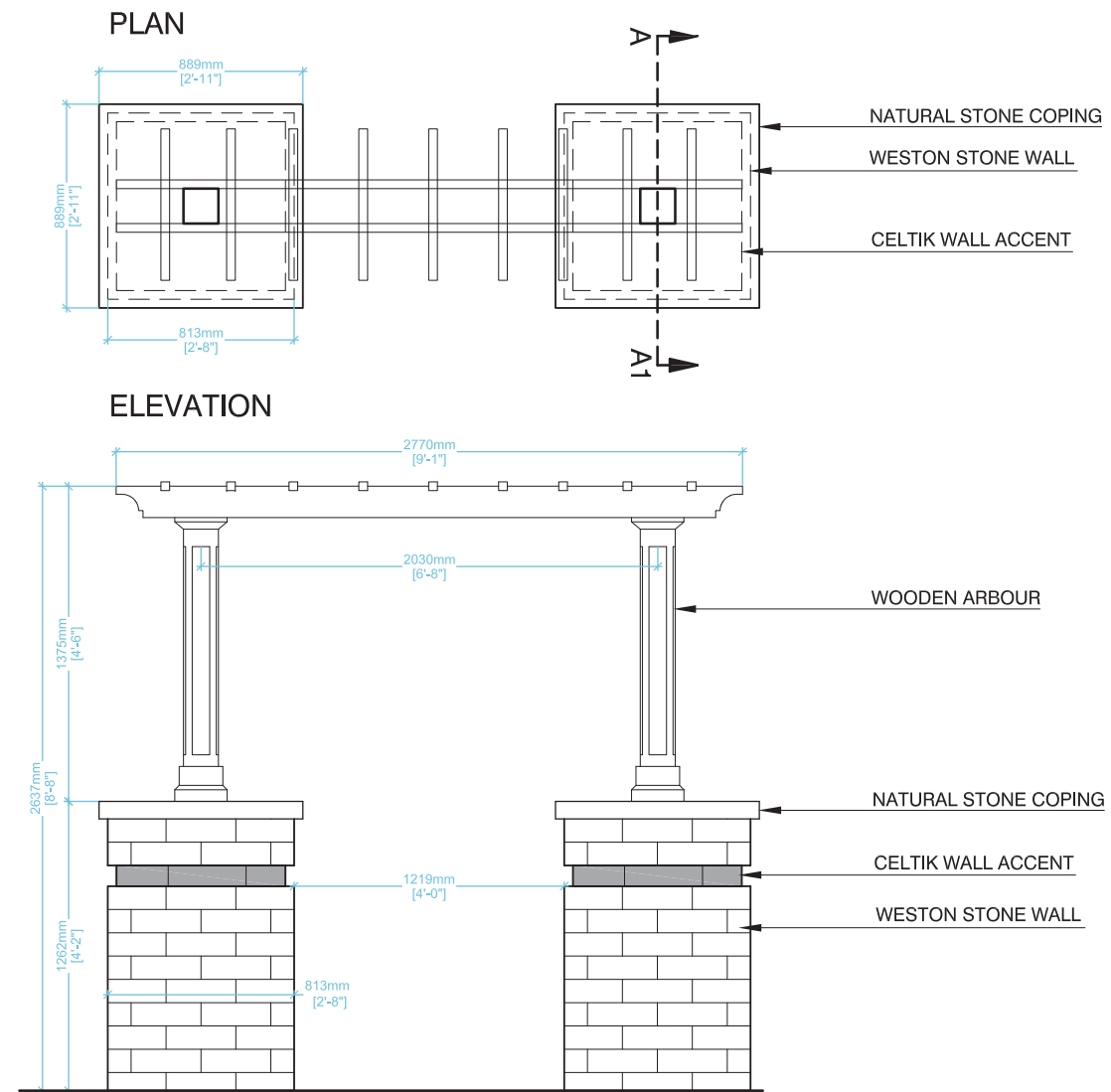

WESTON STONE



BEIGE AND BLACK



CHARCOAL

WESTON STONE



GREY



RED

MATERIAL LIST | SCHEDULE OF QUANTITIES

PRODUCT	QUANTITY
Weston Stone Wall	7.2 M ² / 77.5 ft ²
Celtik Wall Accent	0.32 M ² / 5.6 ft ²
Natural Stone Coping (35" X 35" / 889mm x 889mm each)	2 Units

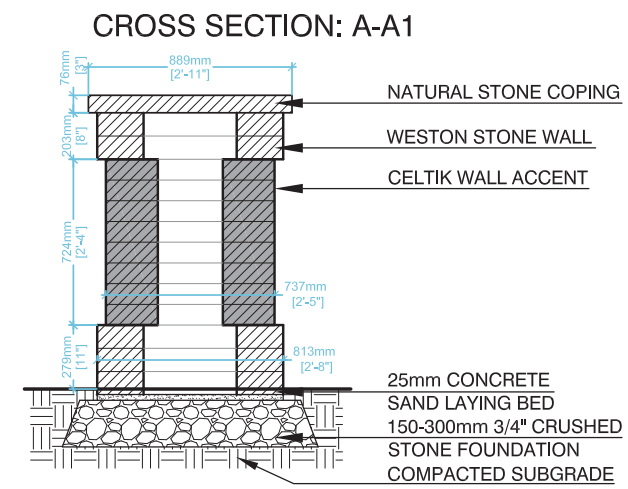
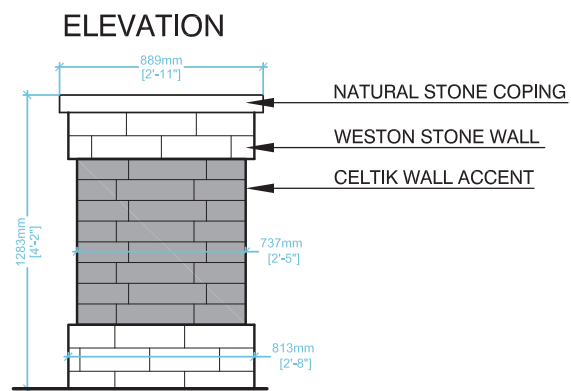
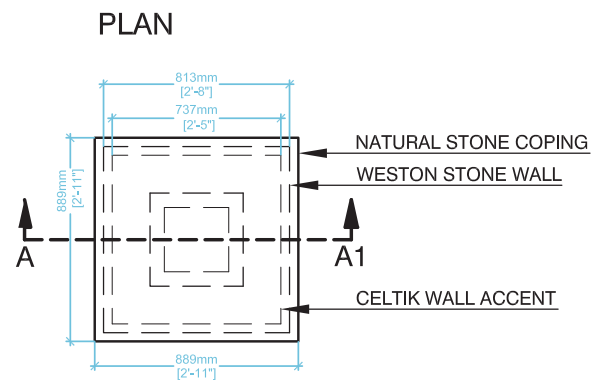

MATERIAL LIST

WESTON STONE WALL - 3.02 m² / 32.6 ft²
CELTIK WALL ACCENT - 4.3 m² / 46.4 ft²
NATURAL STONE CAP - 889mm (35") X 889mm (35")

NOTE:
QUANTITIES ARE PER ONE COLUMN

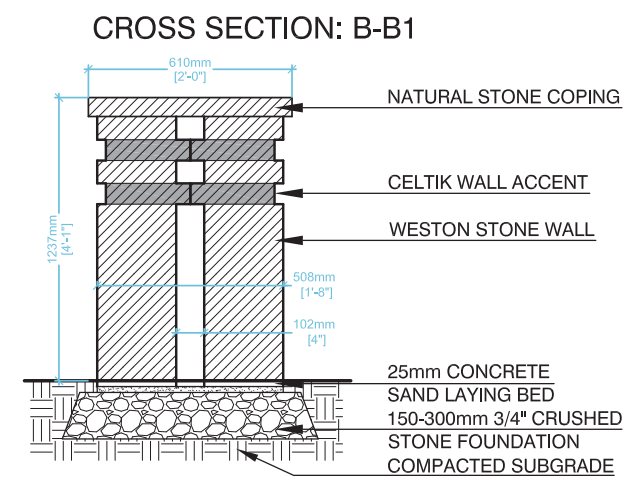
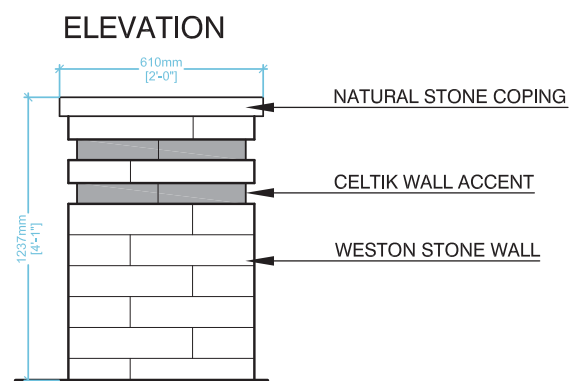
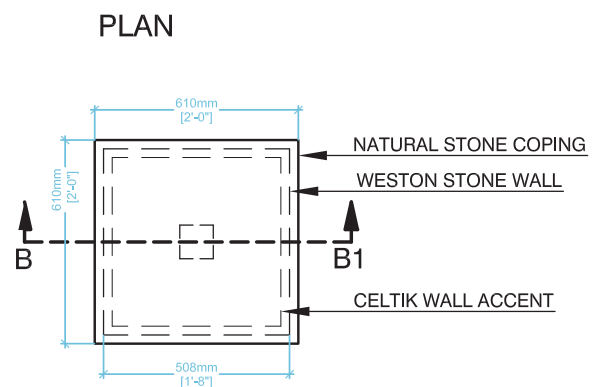

WESTON STONE WALL - 4.08 m² / 44 ft²
CELTIK WALL ACCENT - 0.67 m² / 7.21 ft²
NATURAL STONE CAP - 610mm (24") X 610mm (24")

NOTE:
QUANTITIES ARE PER ONE COLUMN

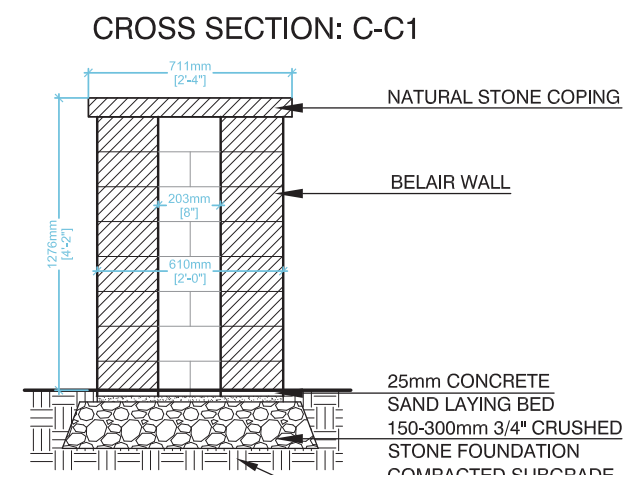
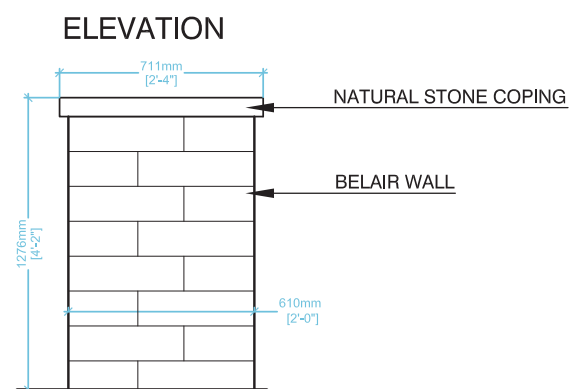
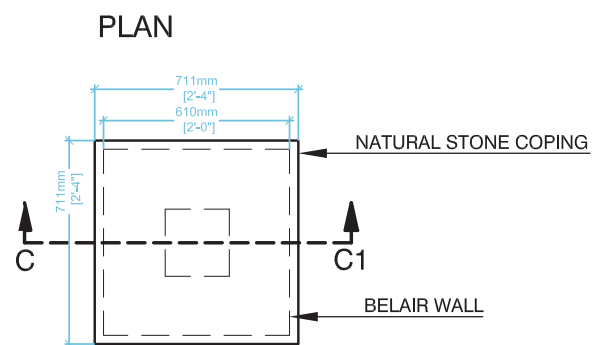

BELAIR WALL - 2.9 m² / 31.3 ft²
NATURAL STONE CAP - 711mm (28") X 711mm (28")

NOTE:
QUANTITIES ARE PER ONE COLUMN

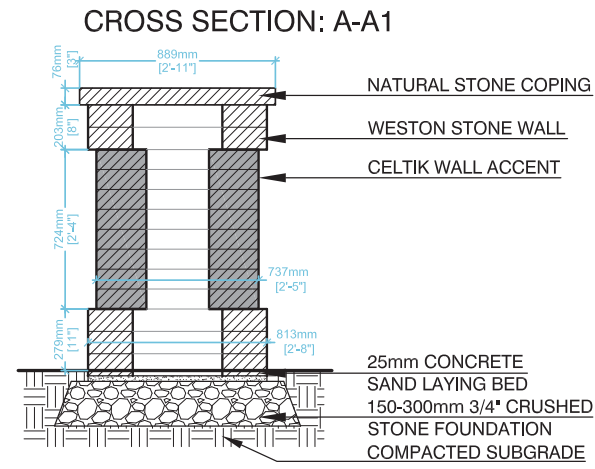
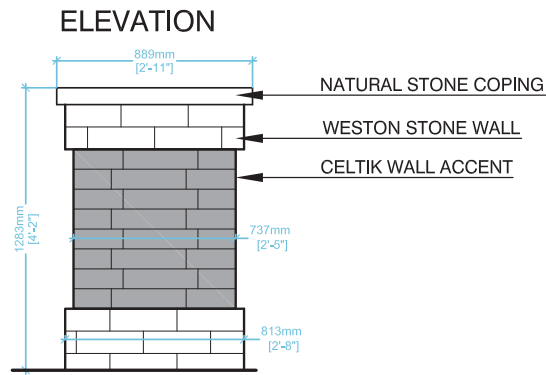
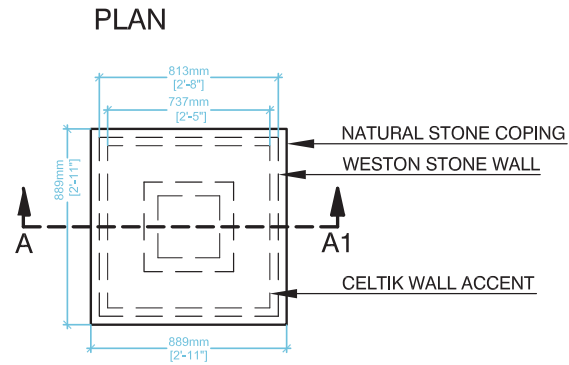

MATERIAL LIST

WESTON STONE WALL - 3.02 m² / 32.6 ft²
 CELTIK WALL ACCENT - 4.3 m² / 46.4 ft²
 NATURAL STONE CAP - 889mm (35") X 889mm (35")

NOTE:
 QUANTITIES ARE PER ONE COLUMN

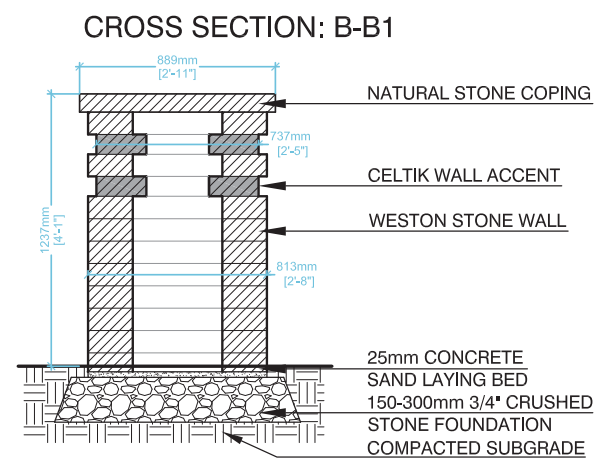
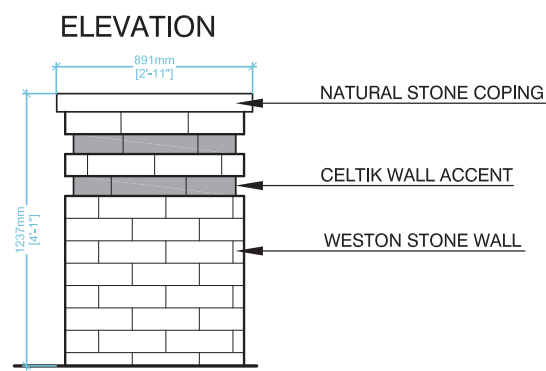
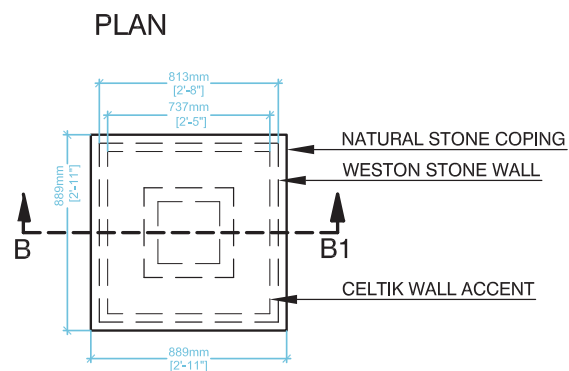

WESTON STONE WALL - 6.54 m² / 70.4 ft²
 CELTIK WALL ACCENT - 1.06 m² / 11.54 ft²
 NATURAL STONE CAP - 889mm (35") X 889mm (35")

NOTE:
 QUANTITIES ARE PER ONE COLUMN

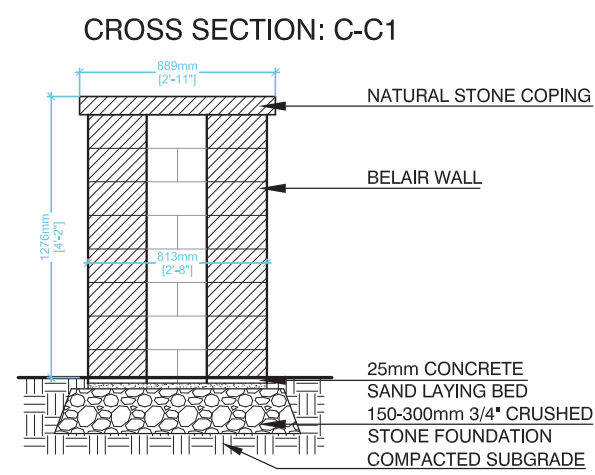
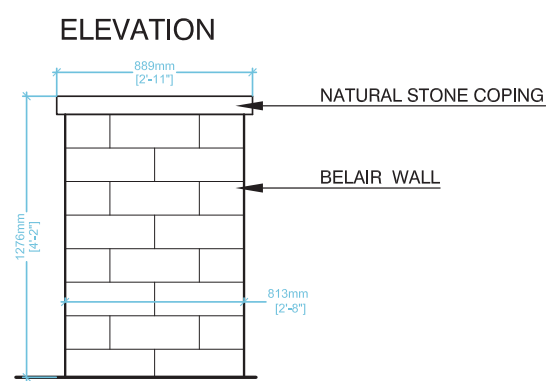
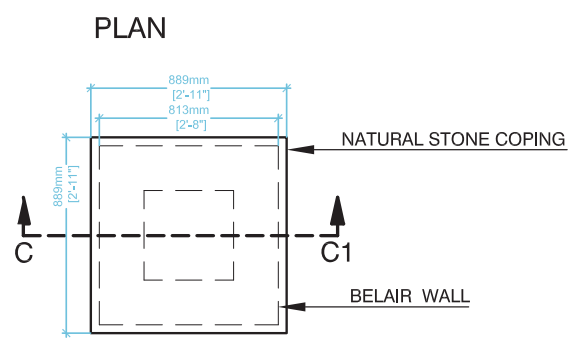

BELAIR WALL - 3.88 m² / 41.7 ft²
 NATURAL STONE CAP - 889mm (35") X 889mm (35")

NOTE:
 QUANTITIES ARE PER ONE COLUMN

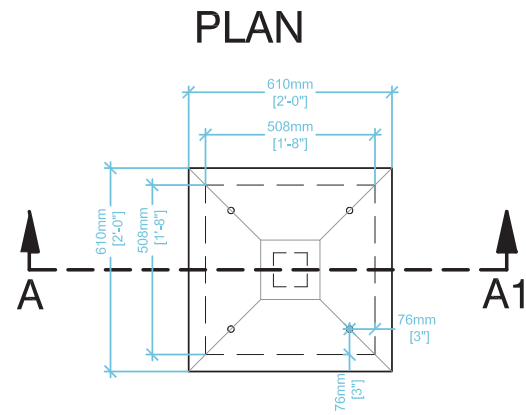

ELEVATION

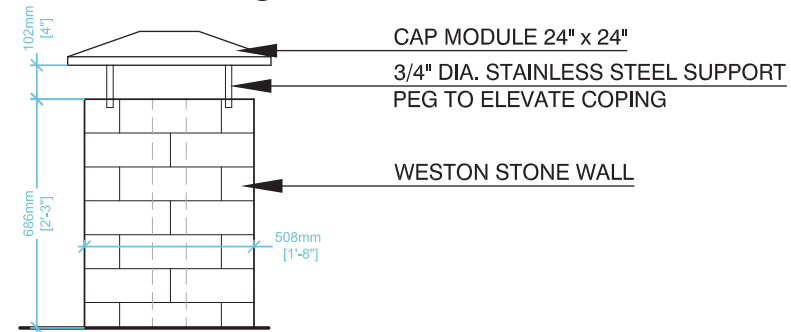

CROSS SECTION: A-A1

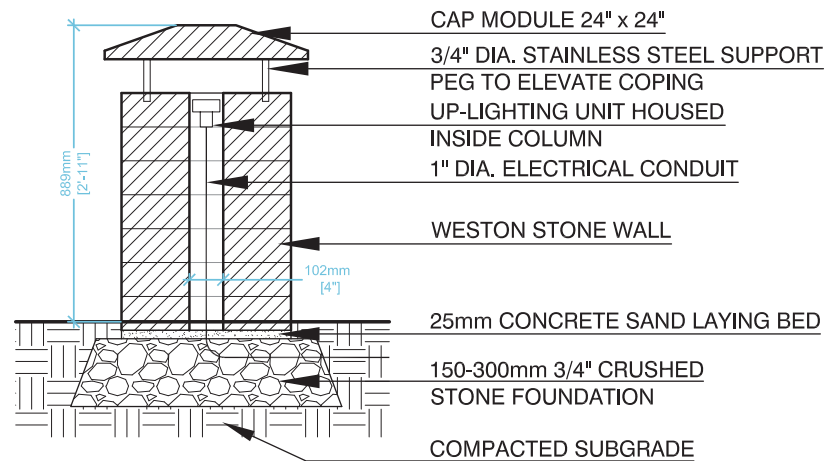

WESTON STONE LIGHT COLUMN | PRODUCT SUMMARY

The Weston Stone Light Column is a great way to define boundaries. An internally mounted light source reflects light from the column cap. Lighting materials are the responsibility of the contractor.

WESTON STONE



MATERIAL LIST | SCHEDULE OF QUANTITIES

PRODUCT	QUANTITY
Weston Stone Wall	1.39 M ² / 14.9 Ft ²
Cap Module (24" X 24" / 610mm x 610mm)	1 Unit

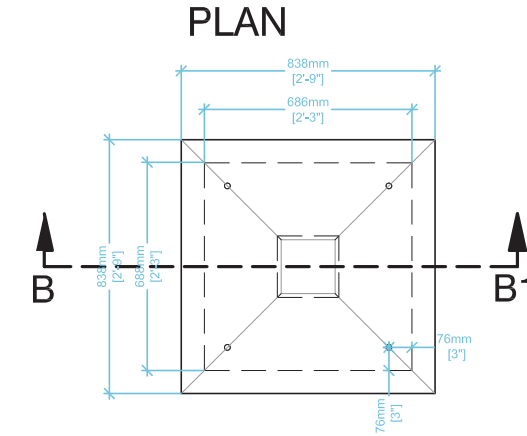

ELEVATION

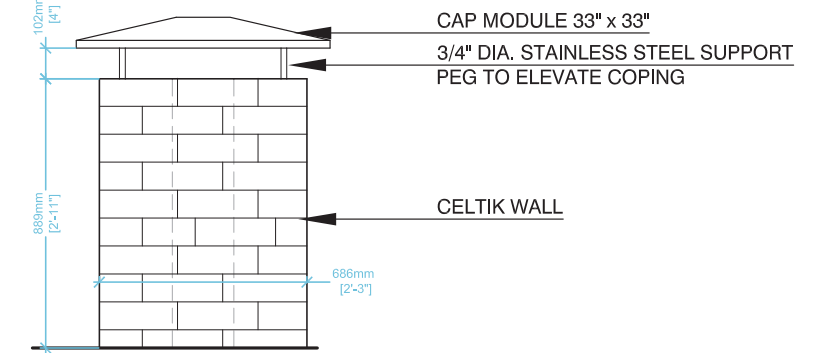

CROSS SECTION: B-B1

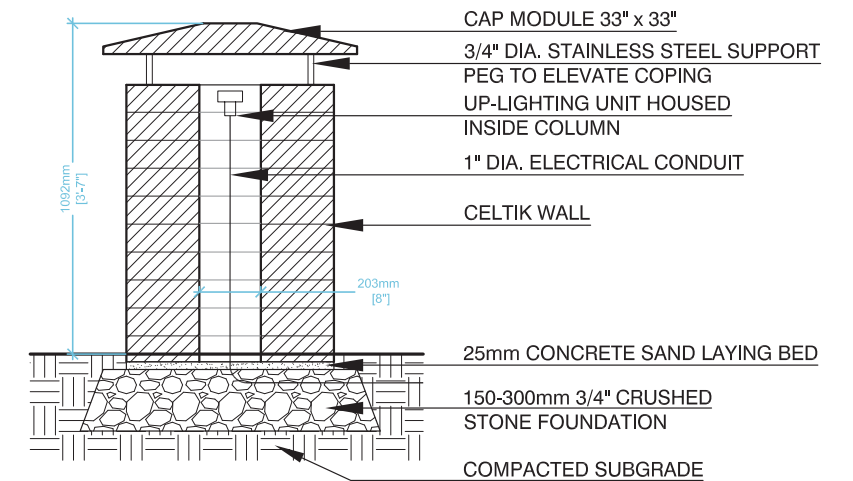

CELTIK LIGHT COLUMN | PRODUCT SUMMARY

The Celtik Light Column is a great way to define boundaries. An internally mounted light source reflects light from the column cap. Lighting materials are the responsibility of the contractor.

CELTIK



MATERIAL LIST | SCHEDULE OF QUANTITIES

PRODUCT	QUANTITY
Celtik Wall	2.44 M ² / 26.3 Ft ²
Cap Module (33" X 33" / 838mm x 838mm)	1 Unit



ENTRY FEATURE | PRODUCT SUMMARY

The Lafitt Entry Feature is a true masonry wall, built on a concrete slab. The Entry Feature is a great way to display site signage or address.

LAFITT



GREY BEIGE BEIGE / TAN

MATERIAL LIST | SCHEDULE OF QUANTITIES

PRODUCT	QUANTITY
Lafitt Stone	5.32 M ² / 57.2 Ft ²
Standard Concrete Block (6" / 15cm Ht.)	20 Units
Cap Module (33" x 33" / 838mm x 838mm)	2 Units
Natural Stone Coping (54" x 12" / 1372mm x 305mm)	1 Unit

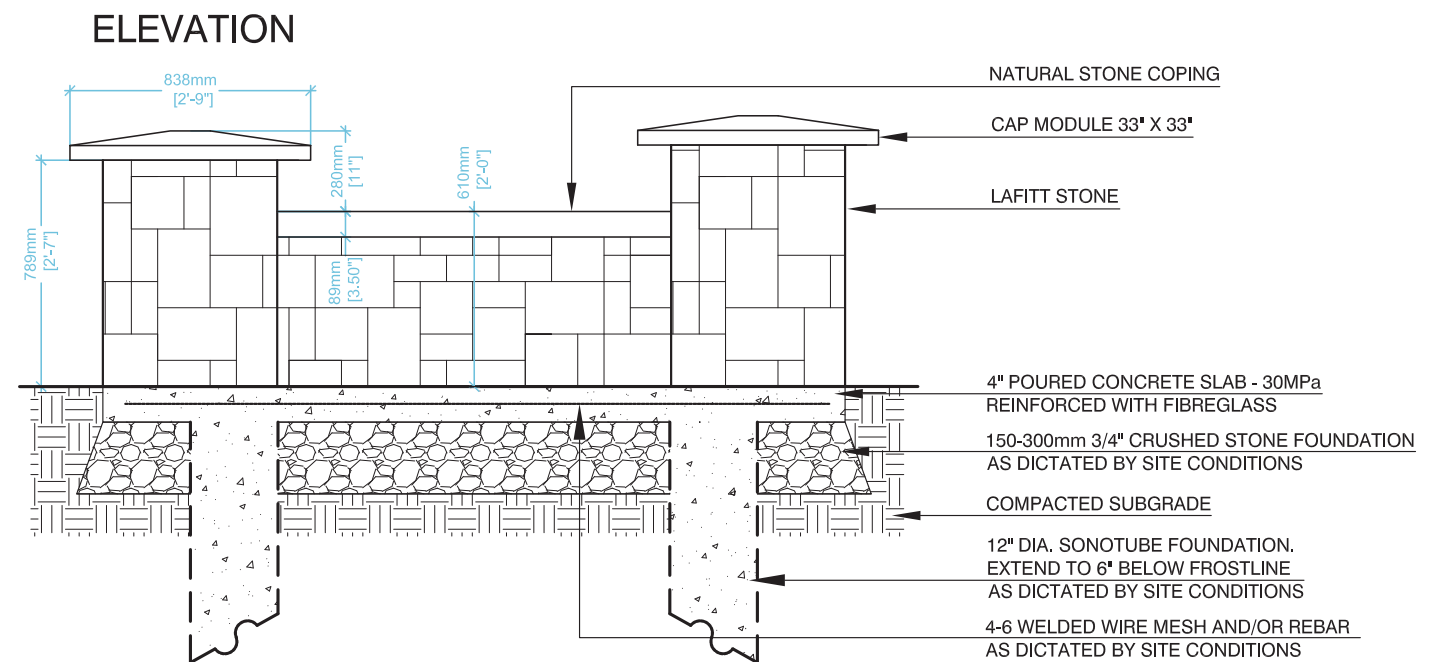
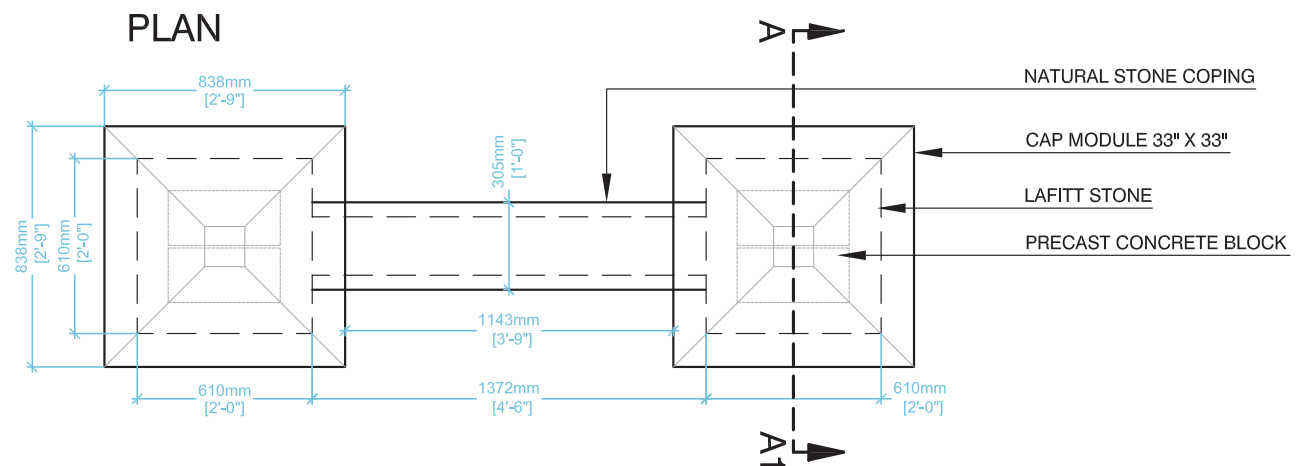

CROSS SECTION: A-A1

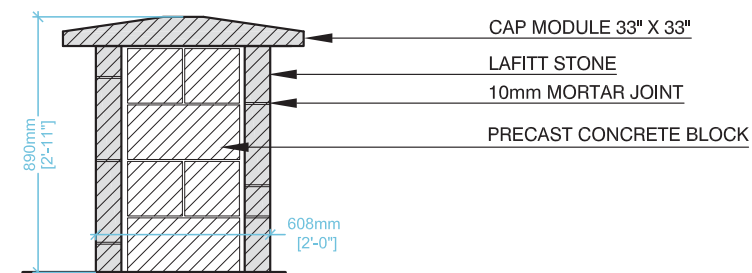



ENTRY FEATURE | PRODUCT SUMMARY

The Weston Stone Entry Feature is a great way to display site signage or address. Our Weston Stone Light Column (D7) can be used in place of the non-lit column if accent lighting is desired. Lighting materials are the responsibility of the contractor.

WESTON STONE



MATERIAL LIST | SCHEDULE OF QUANTITIES

PRODUCT	QUANTITY
Weston Stone Wall	4.17 M ² / 44.8 Ft ²
Celtik Wall	0.31 M ² / 3.33 Ft ²
Cap Module (24" x 24" / 609mm x 609 mm)	2 Units
Natural Stone Coping (48" x 12" / 1219mm x 305mm)	1 Unit

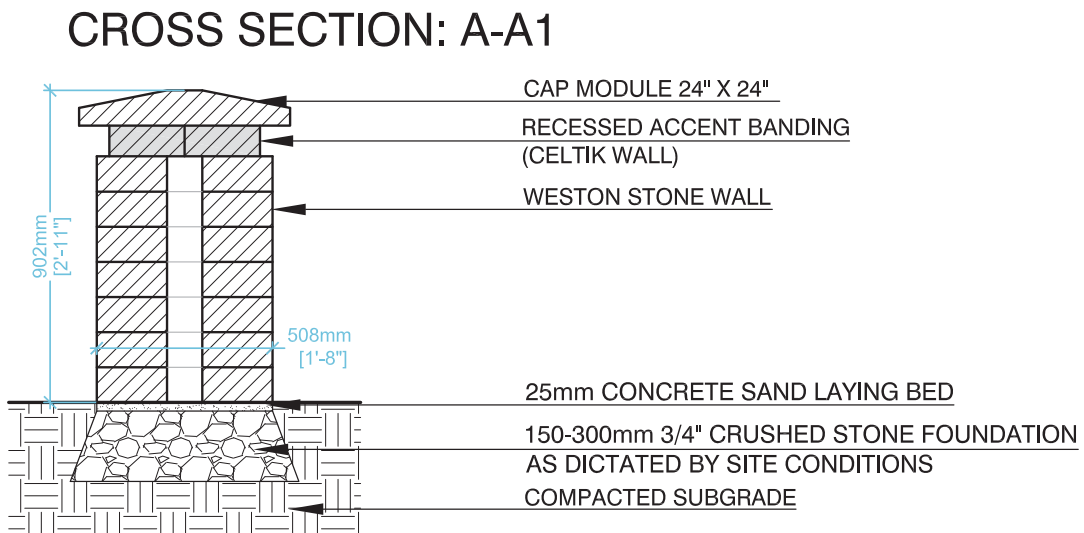
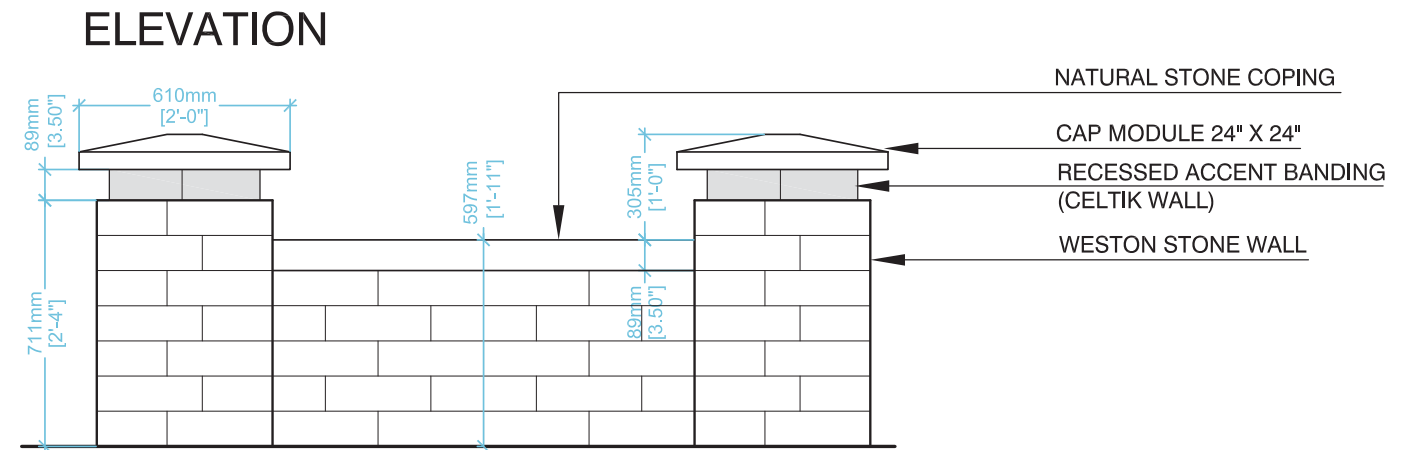
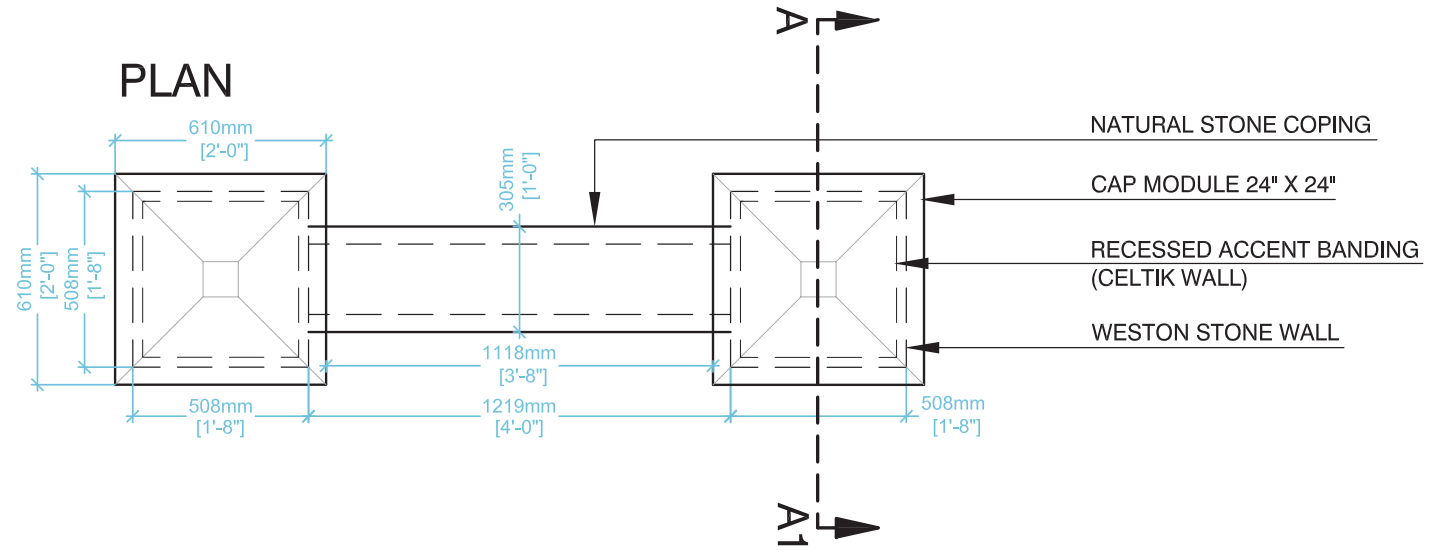

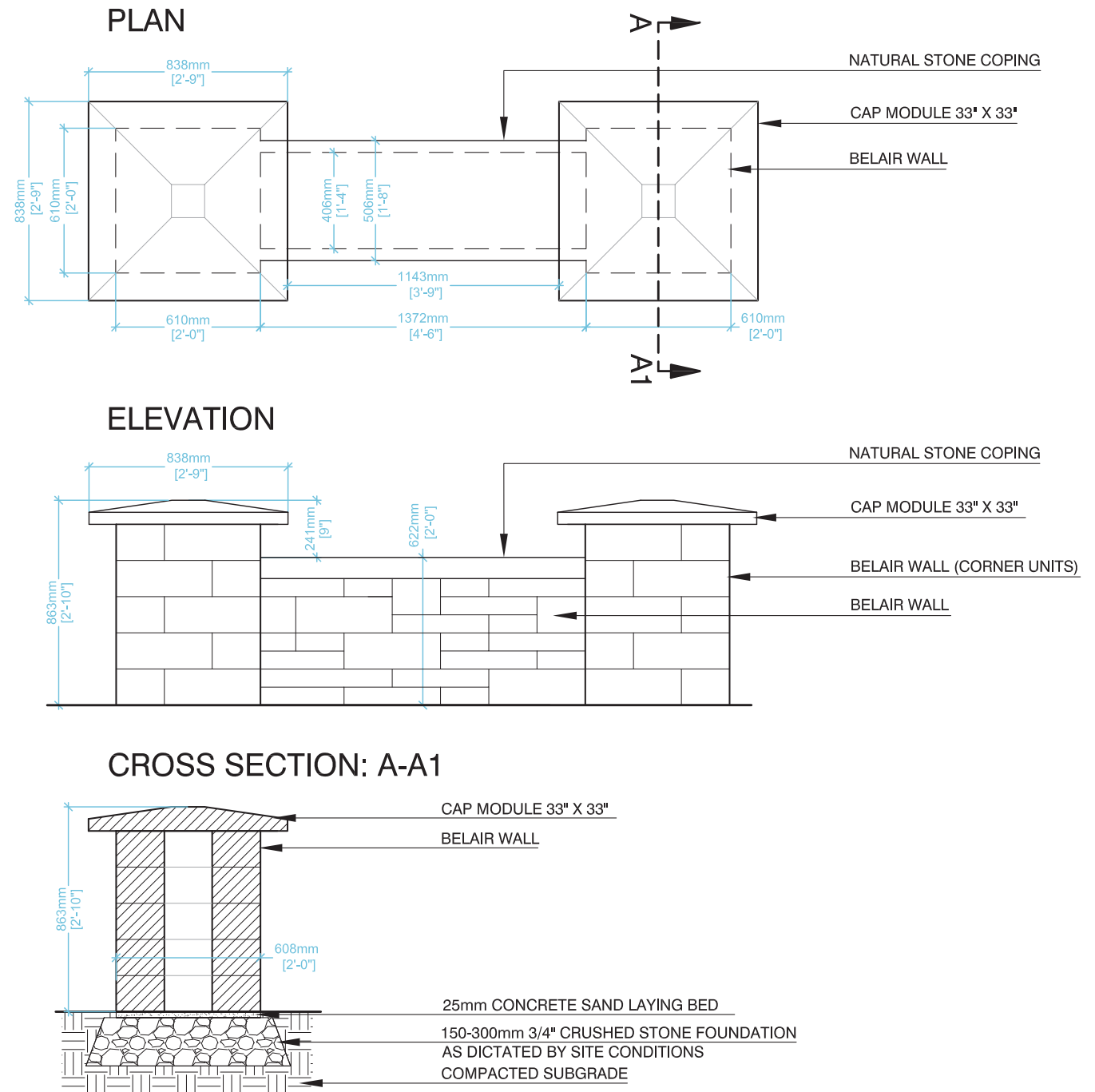

ENTRY FEATURE | PRODUCT SUMMARY

The BelAir Wall Entry Feature is a great way to display site signage or address. Electrical supplies used in our Light Columns (D7) can also be applied to this unit if accent lighting is desired. Lighting materials are the responsibility of the contractor.

BELAIR WALL



Colors vary by region.

MATERIAL LIST | SCHEDULE OF QUANTITIES

PRODUCT	QUANTITY
BelAir Wall	5.32 M ² / 57.2 Ft ²
Cap Module (33" x 33" / 838mm x 838mm)	2 Units
Natural Stone Coping (54" x 20" / 1372mm x 506mm)	1 Unit



WESTON STONE BENCH WITH CELTIK BAND | PRODUCT SUMMARY

The Weston Stone Bench with Arbor is a great privacy piece for relaxing in the garden. Lumber materials are the responsibility of the contractor.

WESTON STONE

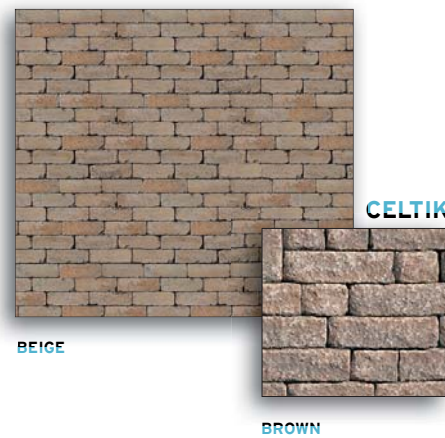

WESTON STONE



MATERIAL LIST | SCHEDULE OF QUANTITIES

PRODUCT	QUANTITY
Weston Stone Wall	2.16 M ² / 23.3 Ft ²
Celtik Wall	0.45 M ² / 4.88 Ft ²
Natural Stone Coping (72" x 34" / 1829mm x 864mm)	1 Unit

PLAN

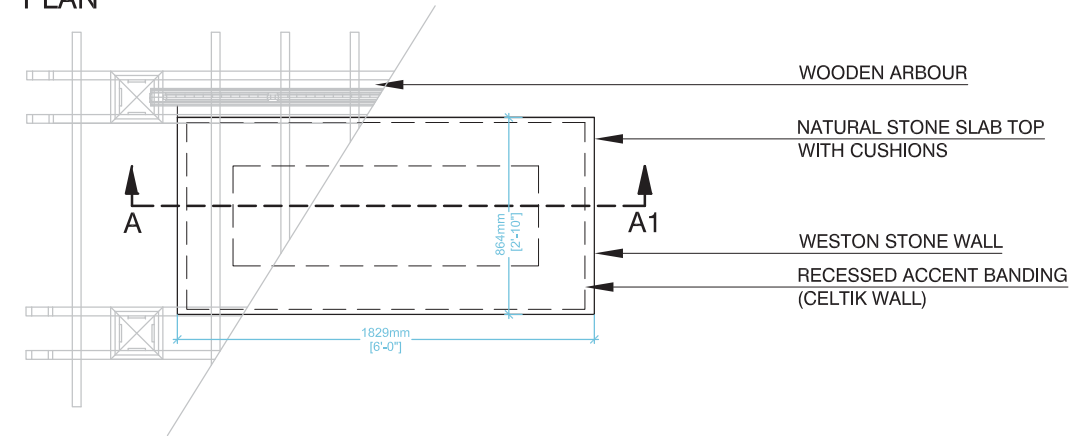

ELEVATION

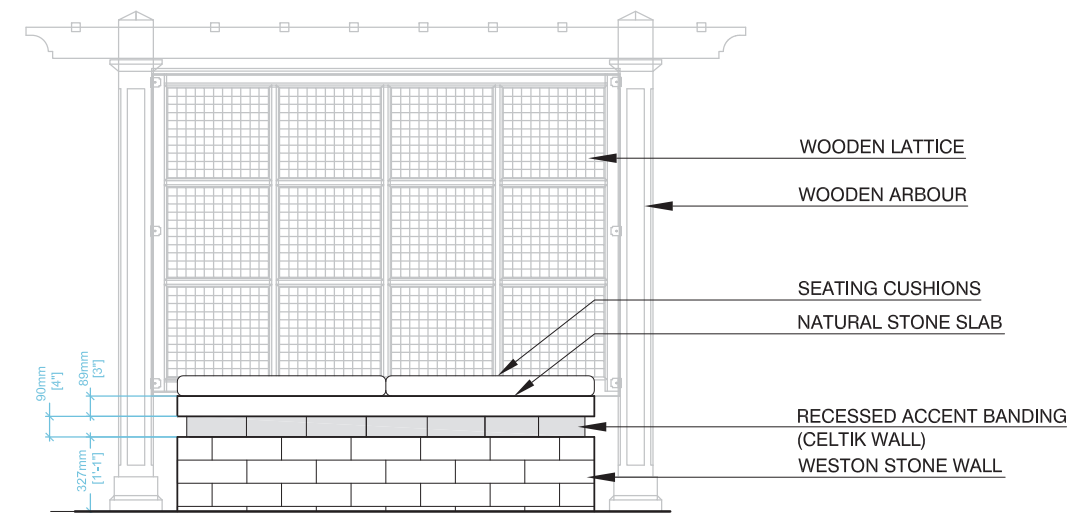

CROSS SECTION: A-A1

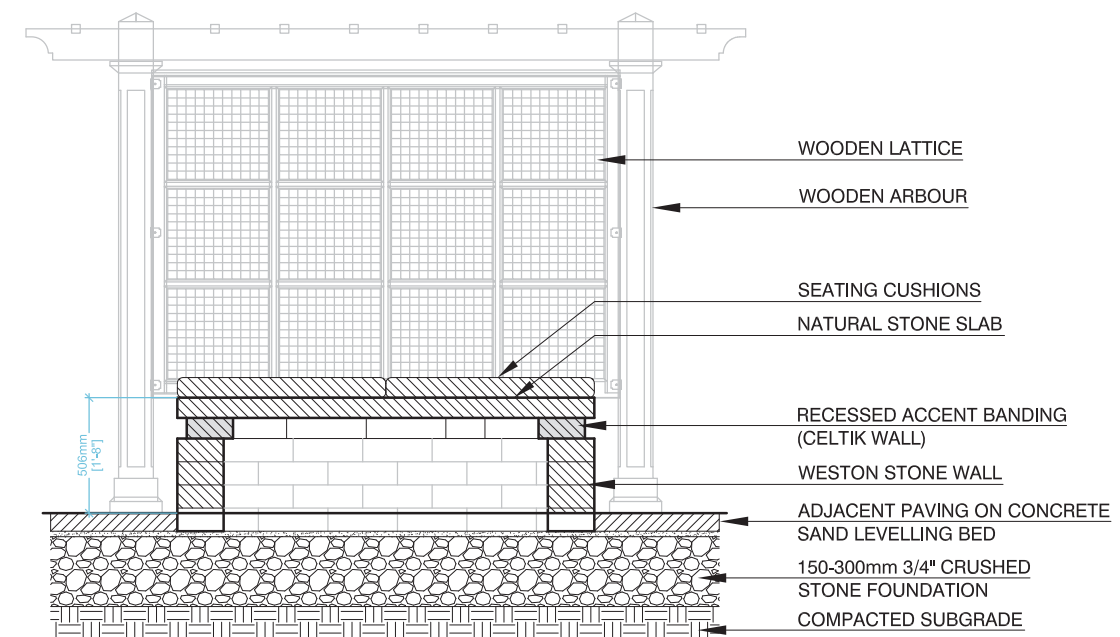



CELTIK CURVED BENCH | PRODUCT SUMMARY

The Celtik Curved Bench is a large seatwall which can be used for gatherings large or small. It's curvilinear shape can to define space or act as retainment where grades change.

CELTIK



RED

CELTIK



BEIGE AND BLACK

MATERIAL LIST | SCHEDULE OF QUANTITIES

PRODUCT	QUANTITY
Celtik Wall	3 M ² / 32.4 Ft ²
Celtik Wall Accent	0.56 M ² / 6.07 Ft ²
Natural Stone Coping (24" / 610mm X 69" / 1758 mm Inside Radius, 93" / 2373 mm Outside Radius)	

